

INSTRUCTIONS FOR USE

Parker



Design Policy and Copyright

® and ™ are trademarks belonging to the Arjo group of companies.

© Arjo 2025.

As our policy is one of continuous improvement, we reserve the right to modify designs without prior notice. The content of this publication may not be copied either whole or in part without the consent of Arjo.

Contents

| | |
|---|-----------|
| Foreword..... | 4 |
| Intended use..... | 5 |
| Safety instructions..... | 6 |
| Preparations..... | 7 |
| Parts designation..... | 8 |
| Product description/functions..... | 12 |
| Drain control knob..... | 12 |
| Auto fill function..... | 12 |
| Scalding protection..... | 12 |
| Temperature display..... | 12 |
| Emergency stop..... | 12 |
| Shower handle..... | 13 |
| Function lock..... | 13 |
| Door lock..... | 13 |
| Air Spa system (option)..... | 14 |
| Disinfection unit (option)..... | 15 |
| Battery back-up..... | 15 |
| Head cushion, back support cushions and leg rest (accessories)..... | 16 |
| Bathe patient..... | 17 |
| Bathe the patient using a standing and raising aid..... | 22 |
| Bathe the patient using a ceiling lift..... | 24 |
| Cleaning and disinfection..... | 26 |
| Care and preventive maintenance..... | 34 |
| Troubleshooting..... | 38 |
| Technical specification..... | 40 |
| Labels..... | 44 |
| Electromagnetic compatibility..... | 47 |
| Parts and accessories..... | 49 |

Foreword

Thank you for choosing the Parker® bath.

Customer contact information

For questions regarding this product or other Arjo products and services, contact Arjo, an Arjo authorised representative or visit www.arjo.com.

Before using the product

The information in this Instructions For Use (IFU) is important for your safety. You must read and fully understand this IFU before using the product to help prevent potential injury. The information in this IFU is necessary for the proper and safe operation of the product.

Unauthorised modifications on any Arjo product can affect its safety and performance. Arjo will not be held responsible for any accidents or incidents resulting from such modifications to its products.

Service and support

It is necessary to perform routine maintenance to maintain the safety and reliability of the product. See the Care and preventive maintenance section for more information. Contact your local Arjo representative for spare parts.

Serious incident

If a serious incident occurs in relation to this medical device, affecting the user, or the patient, then the user or patient should report the serious incident to the medical device manufacturer or the distributor. In the European Union, the user should also report the serious incident to the Competent Authority in the member state where they are located.

Definitions in this IFU



WARNING

Warning means: Safety warning. Failure to understand and obey this warning may result in injury to you or others.

CAUTION

Caution means: Failure to follow these instructions may cause damage to all or parts of the system or product.

NOTE

Note means: This is important information for the correct use of this system or product.

Intended use

The Parker bath is intended for assisted bathing and showering of dependant patients and residents in hospitals and care facilities.

The bathing must be assisted by appropriately trained caregivers with an adequate knowledge of the care environment and its common practices and procedures, and in accordance with the guidelines in the Instructions for Use (IFU). Transfer to the bathtub shall take place by means of an appropriate transfer device.

The bathtub must be disinfected according to instructions in the IFU.

The Parker bath should only be used for the purpose specified in this IFU. Any other use is prohibited.

Indication for use

The Parker bath can be used for alleviation of, or compensation for an injury or disability associated with dependant persons with reduced mobility.

Patient/Resident assessment

We recommend that facilities establish regular assessment routines.

Caregivers should assess each patient/resident according to the following criteria prior to use:

- The resident's weight should not exceed 210 kg / 463 lb (Max Patient Weight).
- Active and semi-active residents (i.e. able to sit upright self-supported on the side of a bed or toilet) can use the bath correct transfer equipment shall be used, if needed.
- Residents with no capacity to support themselves at all (i.e. able to sit upright with support) can use the bath, only with a ceiling lift and a 2-point spreader bar with loop sling for transfer and bath.
- The resident should have the ability to understand and respond to instructions, or have limited physical capacity to move, to ensure a safe position during the bathing procedure.

If a patient/resident does not meet these criteria an alternative equipment or system shall be used.

Installation requirements

The equipment must only be used for the purposes stated above and must be installed according to the Assembly and Installation Instructions, which can only be superseded by local code.

Expected service life

The expected lifetime of this equipment, unless otherwise stated is ten (10) years, subject to required preventative maintenance as specified in the section Care and Preventive Maintenance, the Assembly and Installation Instructions and the Parts List.

Safety instructions



WARNING

To prevent injury, always read this Instructions for use and accompanied documents before using the product.



WARNING

To prevent injury, make sure that the patient is not left unattended at any time.



WARNING

To prevent injury to both the patient and the caregiver, never modify the product or use incompatible parts.



WARNING

To prevent explosion or fire, never use the product in oxygen-rich environment, in presence of heat source or flammable anaesthetic gases.



WARNING

To prevent electric shock, never use other electrical equipment near this product.



WARNING

To prevent the product in use from tipping, do not raise or lower other equipment close to it and be aware of stationary object when raising and lowering the bathtub.

Preparations

Site preparations

Prior to installation of the bathtub, the floor and walls within the required area must be finished, see the instruction in the Site Preparation document.

Material: The floor should be made of a slip-resistant material, free of bumps.

Floor Slope: When using a floor drain, the slope towards the drain should not exceed 1:50.

Floor attachments: The floor construction must be suitable for anchoring the bolts.

Actions before first use

1. Make sure that the bathtub has been installed according to the Assembly and Installation Instructions.
2. Read this IFU.
3. Check that all parts are in place. Compare with Parts designation in this IFU. If any part is missing or damaged - do NOT use the product.

4. **WARNING**
To prevent scalding, make sure that the thermostatic mixer has been calibrated. Confirm that responsible organization has established calibration routines.

Confirm with qualified service personnel that the bathtub is installed and the thermostatic mixer is calibrated according to the Assembly and Installation Instructions.

5. Perform a functionality test. See section Care and preventive maintenance on page 34.
6. Clean and disinfect the bathtub. See section Cleaning and disinfection on page 26.
7. Store the IFU in a designated area where it is easily accessible at all times.
8. Make sure to have a plan ready in case of a patient emergency.

Actions before every use

1. Check that all parts are in place. Compare with Parts designation in this IFU. If any part is missing or damaged - do NOT use the product.

- 2.



WARNING

To prevent cross-contamination, always follow the cleaning and disinfection instructions in this IFU.

Clean and disinfect the bathtub. See section Cleaning and disinfection on page 26.

Parts designation

Standard bathtub

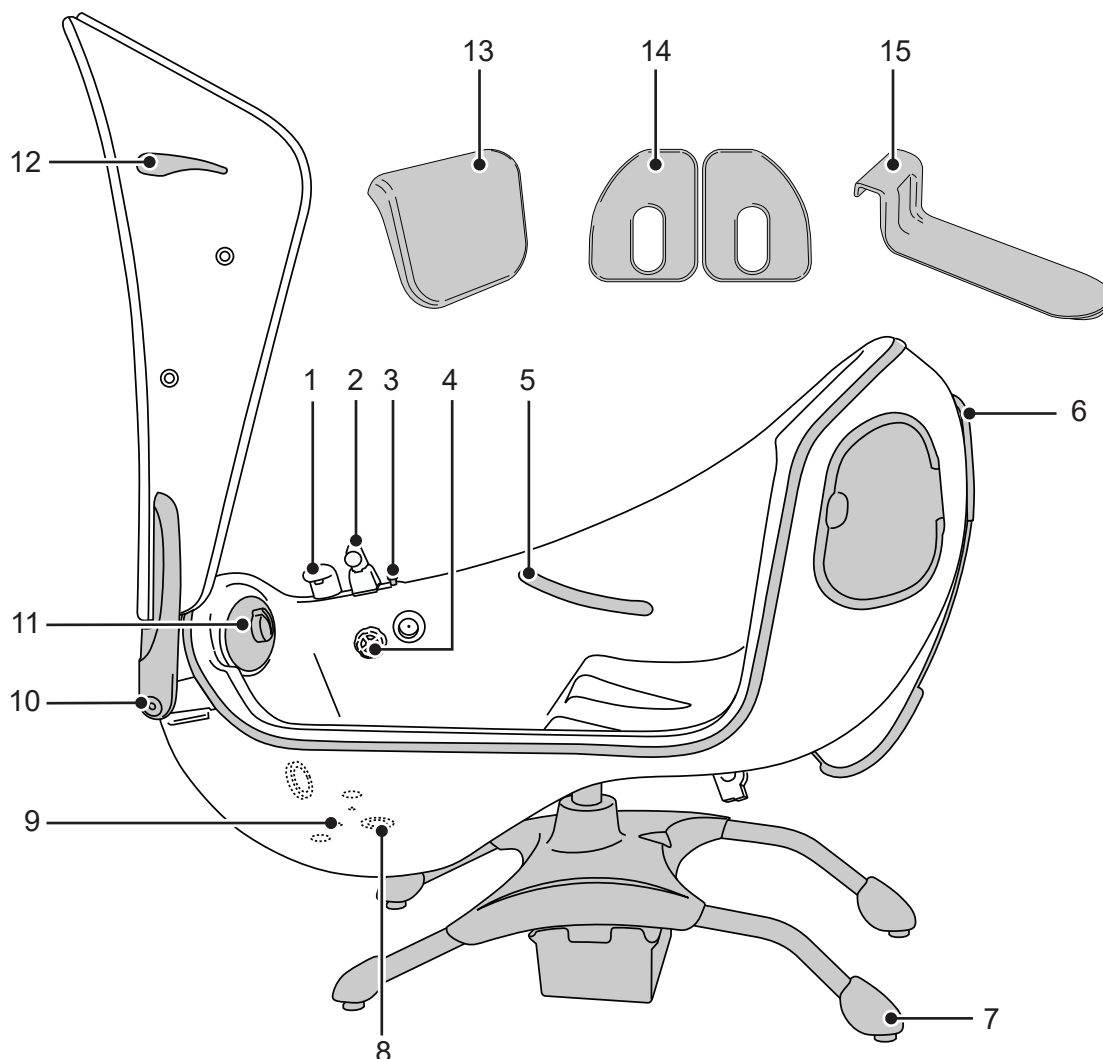

- | | |
|---|---|
| 1. Filling spout | 9. Water sensory knobs (3 pcs) |
| 2. Shower holder/shower handle | 10. Door hinge |
| 3. Emergency stop button | 11. Control panel |
| 4. Drain control knob with built-in surface overflow outlet | 12. Door lock handle |
| 5. Grab handle | 13. Head cushion (with accessory option) |
| 6. Hand control | 14. Back support cushions (with accessory option) |
| 7. Height adjustable feet | 15. Leg rest (with accessory option) |
| 8. Drain | |

Bathtub options

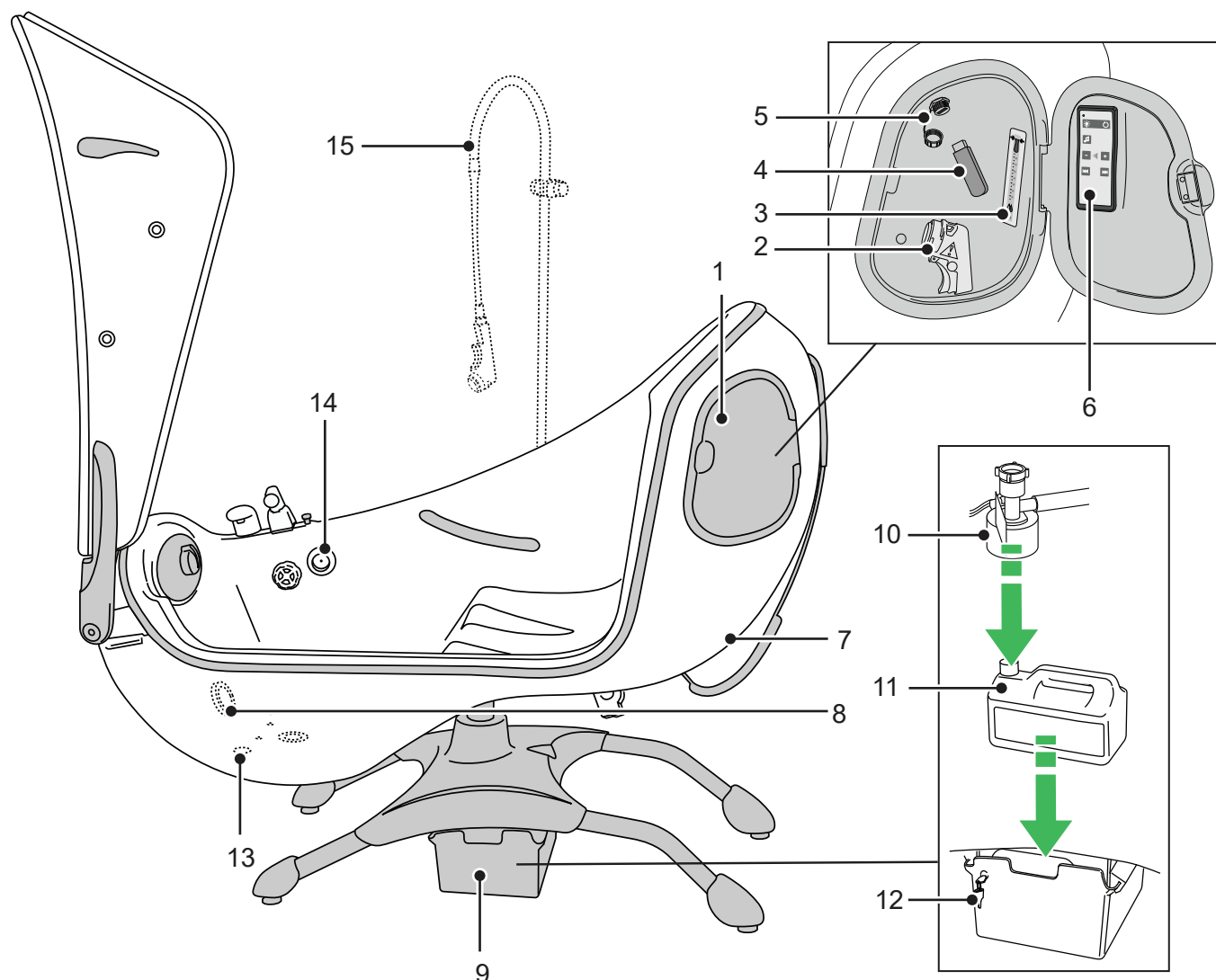

Disinfection and/or Sound & Vision system

1. Cover
2. Disinfection spray handle
3. Disinfectant flowmeter
4. Sound & Vision USB memory stick
5. Sound & Vision USB connection
6. Sound & Vision system hand control
7. Sound & Vision system speakers
8. Sound & Vision system light

Disinfection

9. Disinfectant compartment
10. Disinfection suction part
11. Disinfectant bottle
12. Lock keys for disinfectant compartment

Air Spa system

13. Outlets (9 pcs)
14. Disinfectant/Rinsing inlet

Other

15. Shower stand (for UK only)

Control panel

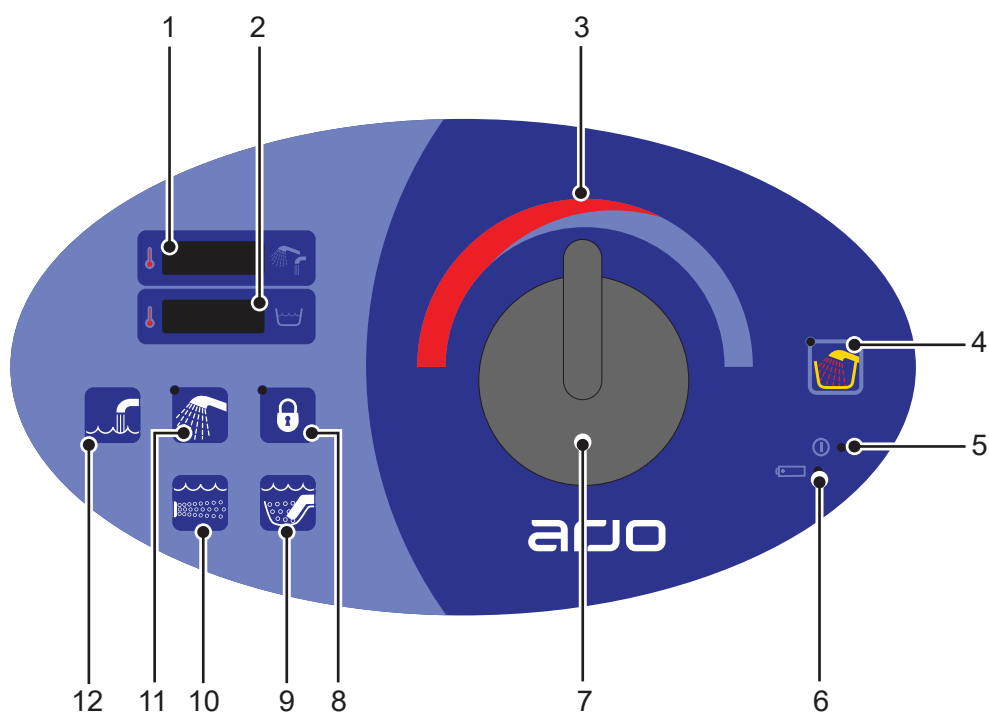

1. Filling water and Shower temperature display with scalding protection
2. Bath water temperature display with scalding protection.
3. Mixing gradient
4. Disinfection ON/OFF with LED indicator (option)
5. LED, mains indicator
6. LED, battery back-up indicator
7. Knob for water temperature adjustment
8. Function lock ON/OFF with LED indicator
9. Air Spa system - foot well ON/Intensity/OFF (option)
10. Air Spa system - whole bathtub ON/Intensity/OFF (option)
11. Shower ON/OFF with LED indicator
12. Auto fill ON/OFF

Hand controls

Hand control

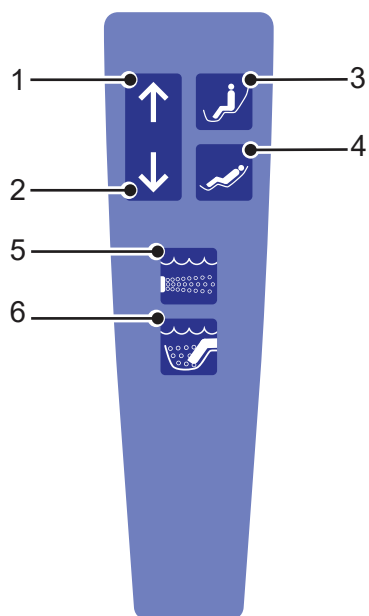

1. Raise bathtub
2. Lower bathtub
3. Tilt bathtub to upright position
4. Tilt bathtub to reclined position
5. Air Spa system - whole bathtub ON/Intensity/OFF (option)
6. Air Spa system - foot well ON/Intensity/OFF (option)

Hand control Sound & Vision system (option)

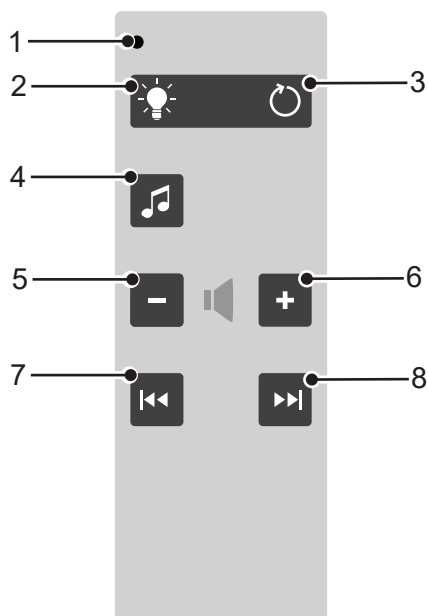

1. LED - activity indicator
2. Sound & Vision system light - ON/OFF
3. Automatic light colour change - ON/OFF
4. MP3 player ON/PAUSE
5. Reduce (–) volume.
6. Increase (+) volume
7. MP3 track reverse
8. MP3 track forward

Product description/functions

Drain control knob

The drain control knob is equipped with a built-in surface overflow outlet to prevent water from overflowing the bathtub.

To open or close the drain, turn the drain control knob.

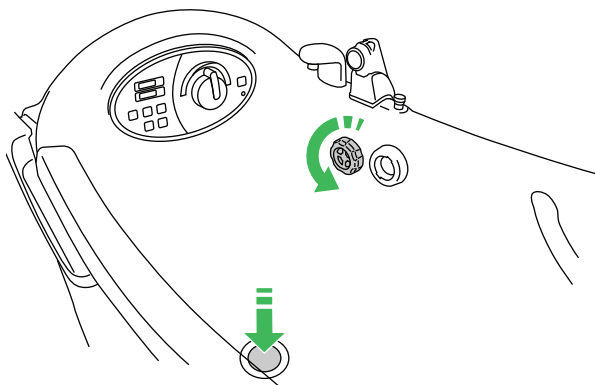

- Open - turn clockwise
- Close - turn counter clockwise

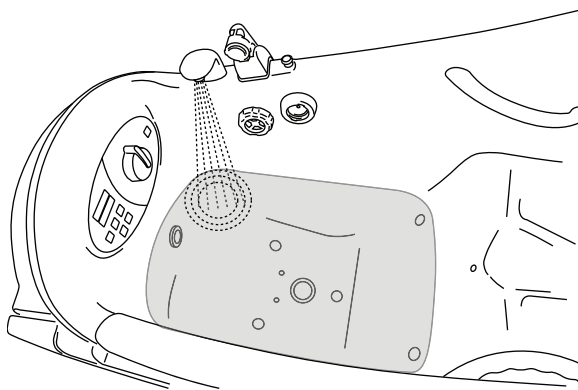

Auto fill function

The auto fill function prefills the footwell.



Press the  Auto fill button to activate the function.

Once the filling level is reached it stops by itself.

- Press the  Auto fill button again and the filling continues for another 60 s.
- Press the  Auto fill button at any time to stop the filling.

Scalding protection

If a dangerous temperature level of 45 °C (113 °F) is reached, the electronic scalding protection shuts off the water after 10 s.

Activated scalding protection: a yellow flashing light and a beeping sound on both temperature displays.

If scalding protection turns on, get the patient out safely. Stop using the bathtub and contact qualified service personnel.

Temperature display

The bathtub has two temperature displays:

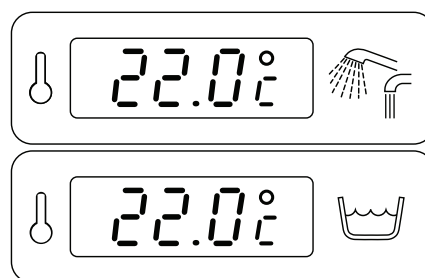

- **Top temperature display:** shows the active filling or shower temperature. If filling or shower is not turned on, the display shows “— . — . —”

During disinfection the display shows the temperature of the disinfectant mixture.

- **The bottom temperature display:** shows the current bathtub water temperature.

Emergency stop

1. Press the Emergency stop button, to stop all functions.





2. To release the Emergency stop button, turn it clockwise.

If the emergency stop button was used due to a product error, stop using the bathtub and contact qualified service personnel.

Shower handle

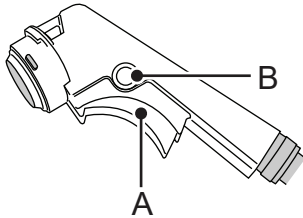
The shower handle is located in the holder or the stand. It has a trigger (A) and a lock button (B).



1. Press the  Shower button to start the shower. The green LED will turn on when active.
2. Press the trigger on the shower handle to regulate the water. Hold the trigger in for constant water flow.

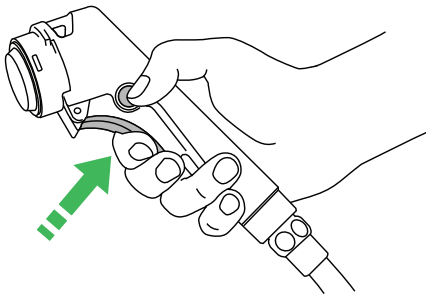

- To get continuous water flow without having to hold in the trigger, press the trigger (1) and push the lock button (2) on the side.

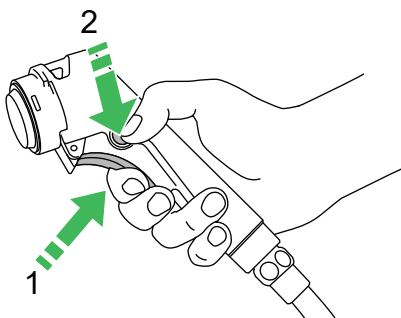

- Unlock by pressing the handle trigger. The lock button will pop out by itself.

Function lock

Press the  function lock button on the control panel.

All the functions are locked except the ones below:

- scalding protection
- emergency stop

The function lock LED is flashing yellow when active.

If the function lock is activated during a shower, the shower can only be turned off after deactivating the function lock.

Door lock

The bathtub has a door handle that works as a door lock. The door handle needs to be aligned with the sticker showing an open or closed lock.

- To unlock the door: press the door handle down until aligned with the sticker showing an open lock.

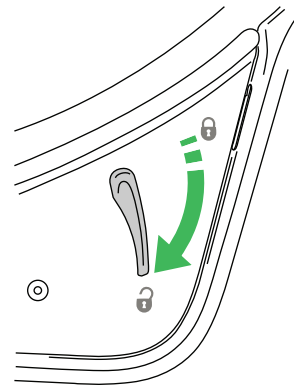

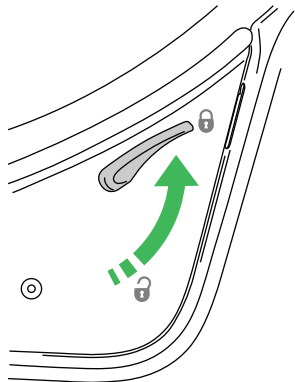

Continued on next page

- To lock the door: press the door handle up until the handle is aligned with the sticker showing a closed lock. (This may require some physical force).



Air Spa system (option)

A bathtub with Air Spa system allows the patient to sit comfortably and enjoy a massage by air jets in the water.

Both the  Air Spa system bathtub button and the  Air Spa system footwell button have two adjustable intensities that can be selected. The maximum session time is 15 minutes.

The Air Spa system can be activated either for the whole bathtub or just in the footwell.

NOTE

Operating the Air Spa system with soapy water can cause excessive foaming.

Sound & Vision® system (option)

The Sound & Vision USB outlet and hand control are located behind the cover.

NOTE

Operating the hand control or control panel in the vicinity of other electrical appliances may lead to unintended compatibility actions with other equipment.

Connect the USB memory stick

1. Unscrew the black cap counter clockwise to get to the USB outlet (A).

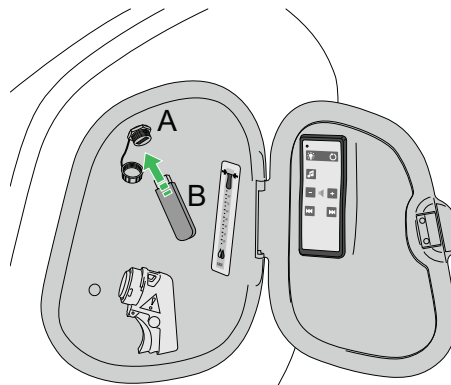

- 2.







WARNING

To prevent electric shock, only use the USB memory stick in the connector on the bathtub.

Plug in the Sound & Vision system memory stick (B).

3. Press any button on the hand control to activate the system.

Use the hand control

1. Take out the hand control.
2. Choose function:
 - To get colored light in the bathtub, press the  light button on the hand control.
 - Press the  light button one more time to change light colour. Choose between red, green, blue, pink and yellow.
 - To start a rotation of different light colours press the automatic light colour change button .
 - Press the  light button for 2 s to turn the light off.
 - To start the music press the  MP3 button on the hand control. Only MP3 files can be read and only files from the root (not in "folders").

- Use the volume buttons to adjust the volume to desired level. The Sound & Vision system starts of at a very low volume.
- Press the  sound button for 2 s to turn the music off.

The Sound & Vision system hand control LED flashes when the buttons are pressed.

NOTE

The music function will stop automatically 30 minutes after activation. Press the MP3 player button on the Sound & Vision system hand control for continued listening.

NOTE

The Sound & Vision system will stop automatically 30 minutes after activation. Press the Sound & Vision system light ON/OFF button on the Sound & Vision system hand control for continued lighting.

Disinfection unit (option)

The bathtub has the a built-in disinfection unit (disinfection spray handle and flowmeter) as an option. It is located behind the cover.

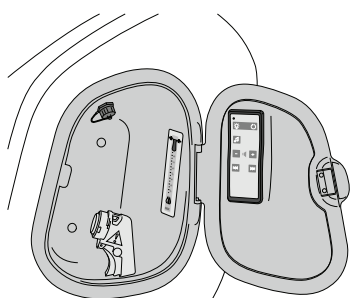

There is a disinfectant bottle with an adjustable top to adjust the mixing value of the disinfectant concentration and water.

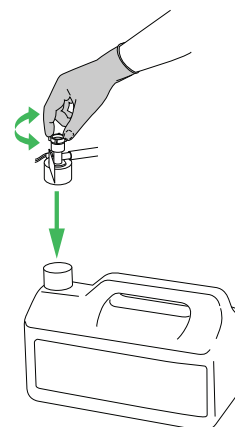

It is located in the lockable compartment between the bathtub legs.

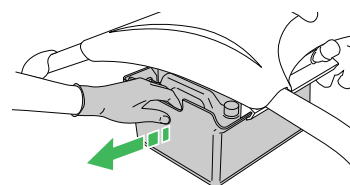

To use the disinfection unit

1. Press the disinfection button and hold it in for 5 s to activate it.



2. The LED turns green when active.

If the disinfectant bottle is empty, the LED will start flashing when pressing the disinfection button. A beeping sound comes on and it is not possible to disinfect the bathtub.

Replace with a full disinfection bottle and try again. See section Replace the disinfectant bottle on page 31.

Battery back-up

A battery will work as a back-up if there is a power failure. It is possible to help a patient out of a bathtub during that time. Everything on the bathtub will work under the battery back-up except for the auto fill function, the Air Spa system and the Sound & Vision system.

Continued on next page

If the battery fails to work during a power failure contact qualified service personnel.

 **WARNING**

Never put the patient in the bathtub when the power indicator light on the control panel is out. Make sure that the bathtub is connected to a power outlet or the battery might run out of power. Contact Arjo qualified service personnel if problem occurs.

CAUTION
Always fit the leg rest on the opposite side of the door. If hung on the door, damage to the door may occur.

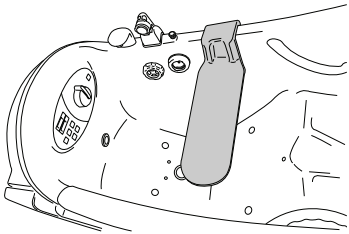

| BATTERY LED INDICATOR | |
|--|---|
| Battery charge level (when the main power supply is not connected) | |
| Yellow LED on | No mains connected |
| Yellow LED flashing | No mains connected and battery is running low. The Battery is automatically charged when the bathtub is connected to the mains. |
| No LED light | Connect the bathtub to the mains to charge the battery. |

Head cushion, back support cushions and leg rest (accessories)

Extra cushions are available for added comfort for the patient. The back support cushions have suction cups for easy attachment to the bathtub.

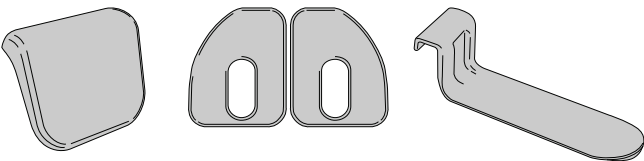

These accessories can be ordered from your local Arjo representative.

Bathe patient

(37 steps)



WARNING

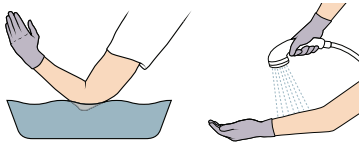

To prevent scalding of patient, always check the water temperature on bare skin. Direct the water flow away from the patient.

Fill the footwell with water

1. Make sure that the bathtub is in an upright position.

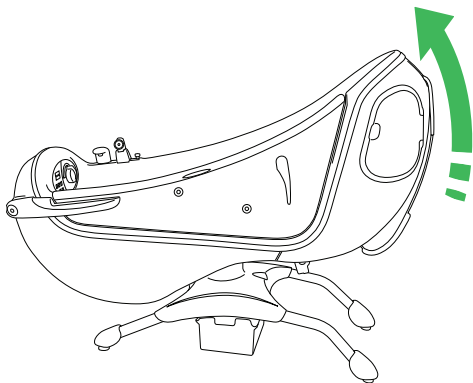

2. Close the drain by rotating the drain control knob counter clockwise.

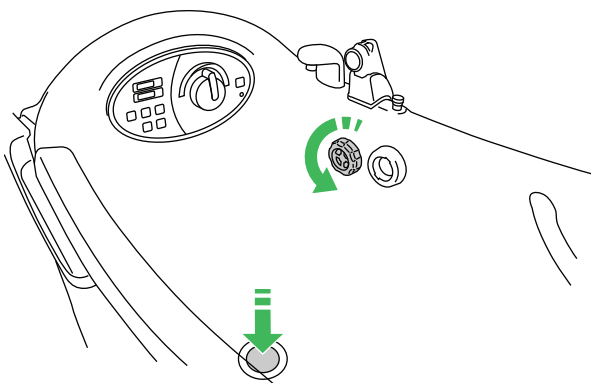

3. Activate prefill by pressing the  auto fill button.

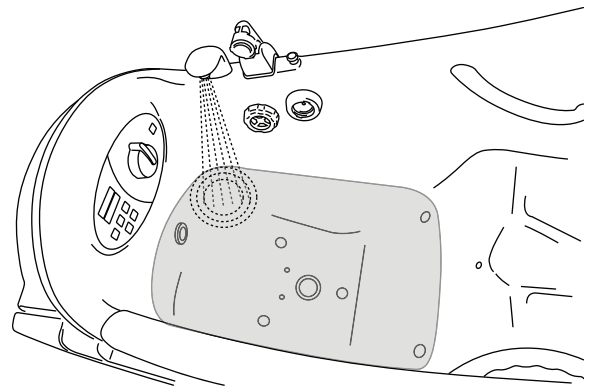

4. Feel the water temperature with a naked hand and let the patient feel the water. Adjust the knob to a comfortable temperature.

The filling stops automatically when the footwell is filled.

Bathe the patient



5. Open the bathtub door by pressing the door handle down. Make sure no objects are in the path of opening the door. Raise the door to a fully open position.

- 6.



WARNING

To prevent falling, make sure the patient always remains in a seated position.

Adjust the bathtub height by pressing the  up or  down button on the hand control, in order to get the right patient seating height.

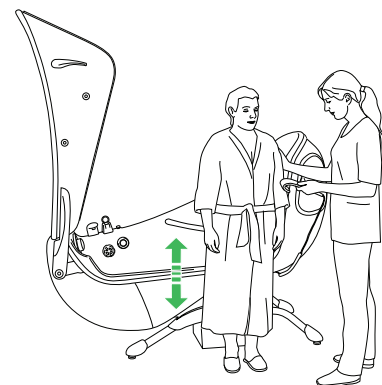

Continued on next page

7.



WARNING

To prevent falling, make sure the patient uses the grab rails for support when entering or exiting the bathtub.

If needed, help the patient get seated in the bathtub.

8.



WARNING

To prevent falling, make sure the patient always remains in a seated position.

If needed, help the patient to place their feet into the footwell.

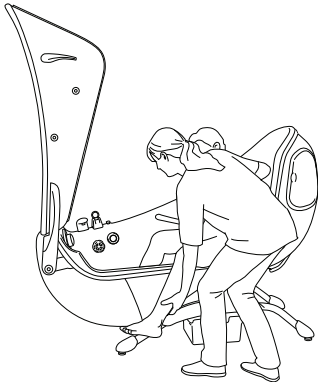

9.



WARNING

To prevent entrapment, make sure to keep the patient's hair, arms and feet close to the body and use designated grab supports during any movement.

Close and lock the bathtub door by pulling the door handle fully up (with some physical force) until aligned with the closed lock sticker.



10.





WARNING

To prevent entrapment, make sure to keep the patient's hair, arms and feet close to the body and use designated grab supports during any movement.

Recline the bathtub by pressing the  tilt back button on the hand control.

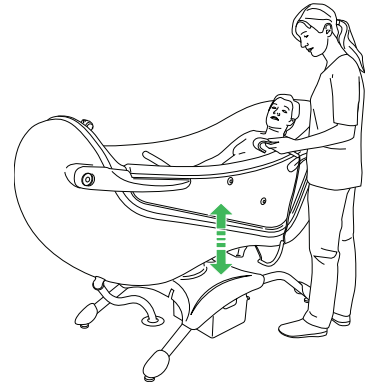
11. Position the bathtub to the preferred working height by pressing the  up or  down buttons on the hand control.



12. Adjust bath water depth by pressing  auto fill button.

- The filling stops automatically after 60 s.
- To stop filling within this time frame, press  auto fill button.
- If the button is pressed once again, the filling starts for another 60 s.

13. Adjust the water temperature by rotating the temperature knob on the control panel.

14. Feel the water temperature with a naked hand and let the patient feel the water as well.

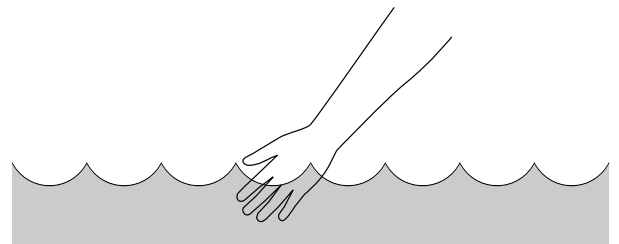

15. Stop filling at desired water level.

Air Spa system (option)

To activate the Air Spa system, use either the buttons on the control panel or on the hand control.

16. To activate the Air Spa system in the whole bathtub, press the  Air Spa - whole bathtub button. The Air Spa system will start with low intensity in the whole bathtub.
- To increase the intensity, press the button a second time.

- To stop the Air Spa, press the button a third time.

The above sequence applies to the  Air Spa system - footwell button as well.

Sound & Vision® system (option)

17. Activate the Sound & Vision system through the USB outlet and the Sound & Vision system hand control, which is located behind the cover. Unscrew the black cap counter clockwise to get to the USB outlet and plug in the USB memory stick.

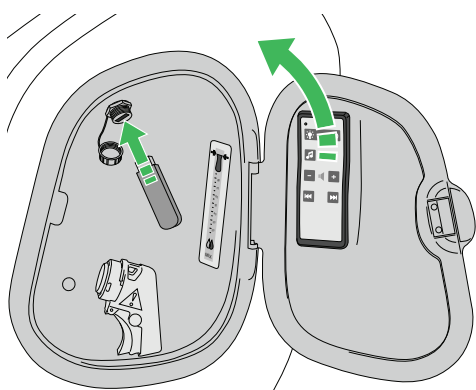

Shower the patient

18. Lift off the shower handle from the holder or stand.
19. Hold the shower handle away from the patient.
20. Press the  shower button on the control panel (the LED lights up when active).

21.



WARNING

To prevent scalding, always check the water temperature with your naked hand before directing the water on the patient. Do not use gloves as it may insulate to the extent that the water temperature can be misjudged. Point the flow of the water away from the patient.

Press the trigger on the shower handle directing the water stream away from the patient.

22. The top display shows the shower water temperature. Allow a few seconds for the display to adjust the temperature. If needed, turn the knob to adjust the water temperature.
23. Also check by placing your naked hand in the water stream that the water temperature is not too hot.

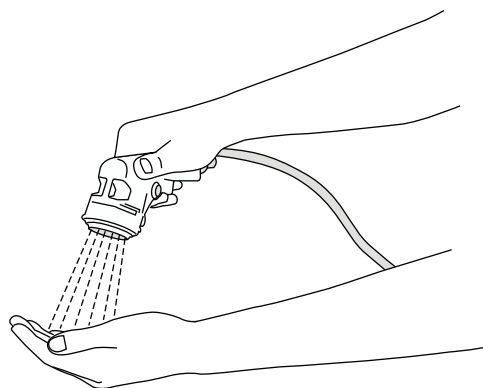

24. Allow the patient to feel the water with his or her hand before the water stream is directed onto the patient. If needed, adjust water temperature by turning the knob.



25. To keep the trigger handle in for a longer period, activate the lock button by pushing it in. To deactivate, push the trigger.
26. When showering is finished, press the  shower button on the control panel.

Continued on next page

27. Make sure the shower trigger is unlocked before placing the shower handle back into the holder or stand.

NOTE

Raise the bathtub, for optimum use of the shower stand, and turn the shower stand away from the patient when not in use. (UK only)

End the bath

28. When bathing is complete, drain the bathtub by opening the drain. Turn the drain control knob clockwise.
29. With intervals, tilt the bathtub to upright position by pressing the  tilt up button on the hand control. Try to keep the patient in the water as long as possible.
30. In the meantime, keep the patient warm by showering the upper body or covering him or her with a towel.
31. When the bathtub is in an upright position, lean the patient forward and ask him or her to grab the handles. Shower and dry the patient's upper body and place a towel around the patient to preserve heat.

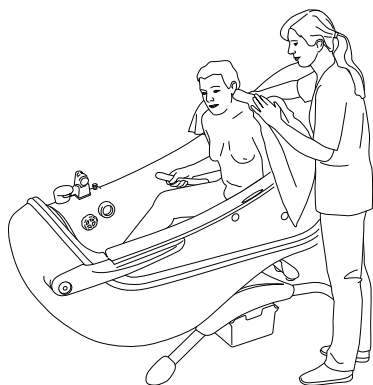

32. Lower the bathtub to the lowest position.

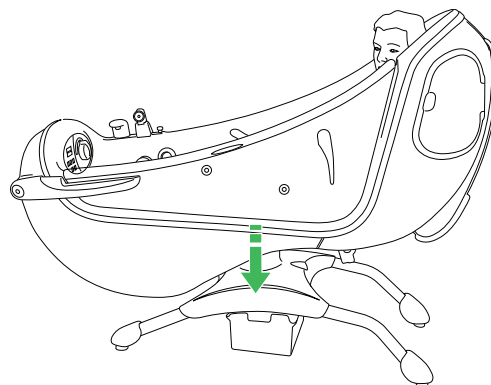

33. Make sure that the water level is below the door opening.

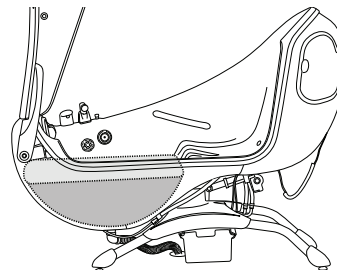

34. Unlock and open the bathtub door by pulling the door handle down and lift the door up. Make sure no objects are in the path of opening the door.
35. If necessary, gently grab the patient's legs and dry them before placing them on the floor.

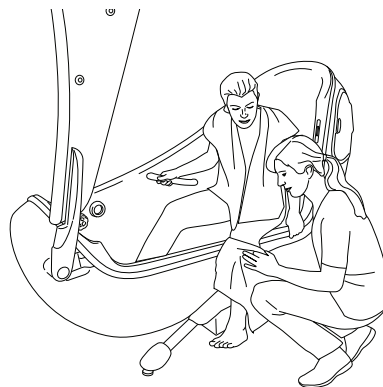

- 36.



WARNING

To prevent falling, make sure the patient uses the grab rails for support when entering or exiting the bathtub.

Remove the patient and dry remaining wet areas of the patient's body.

Disinfect after each patient

37. Make the bathtub ready for the next patient.

The bathtub must be fully disinfected after each use to prevent cross-contamination. See section Cleaning and disinfection on page 26.

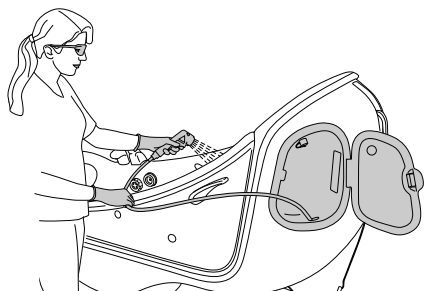

NOTE

To preserve the door seal, leave the door slightly open when not in use.

Place the hand control on the hand control holder when not in use.

Bathe the patient using a standing and raising aid

(37 steps)

The bathtub integrates with Arjo products according to table Allowed combinations on page 43.

Transfer from Sara 3000 to bathtub

1. Lower the bathtub to the lowest position.
2. Start filling the footwell.

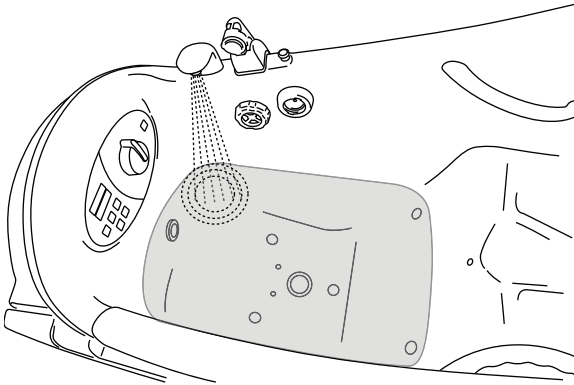

3.



WARNING

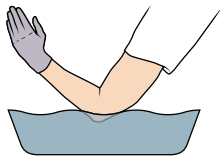

To prevent scalding of patient, always check the water temperature on bare skin.

Feel the water on bare skin. Adjust the water temperature if needed.

4. Open the bathtub door. Make sure no objects are in the path of opening the door.
5. Transfer the patient to the bathroom.
6. Place the sling around the patient and fasten it to the standing and raising aid.
7. Activate the standing and raising aid and raise the patient.
8. Pull down the patient's trousers or skirt.

9. Transfer the patient to the bathtub.

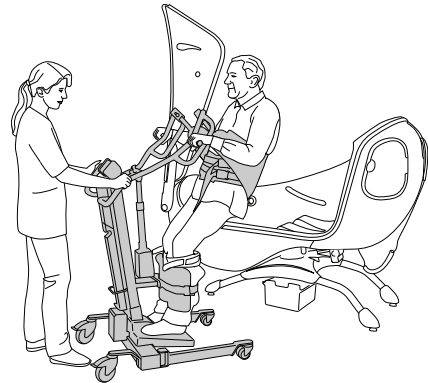

10. Lower the patient in order to place him or her on the bathtub seat.

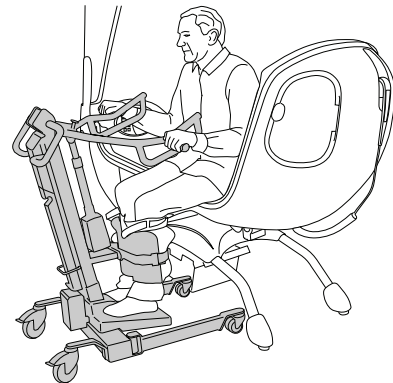

11. Detach the sling and pull the standing and raising aid away.
12. Undress the patient's upper half.
13. Take off the patient's trousers or skirt.
14. Let the patient feel the water temperature in the footwell.
15. If needed, gently, spin the patient around and place his or her feet in the footwell.

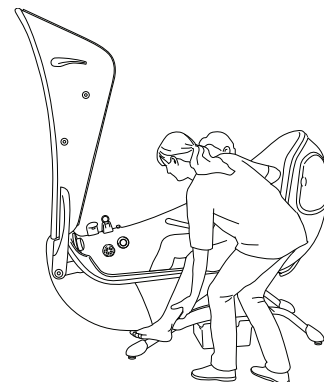

16.



WARNING

To prevent entrapment, make sure to keep the patient's hair, arms and feet close to the body and use designated grab supports during any movement.

Close the bathtub door.

17. Perform bathing according to section Bathe the patient on page 17. Start with step 10 on page 18.

18. Perform showering according to section Shower the patient on page 19.

End the bath

19. Open the drain.

20. With intervals, tilt the bathtub to upright position by pressing the  tilt up button on the hand control. Try to keep the patient in the water as long as possible.

21. In the meantime, keep the patient warm by showering the upper body or covering him or her with a towel.

22. When the bathtub is in an upright position, lean the patient forward and ask him or her to grab the handles. Shower and dry the patient's upper body and place a towel around the patient to preserve heat.

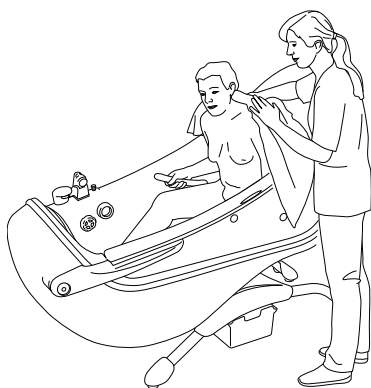

23. Lower the bathtub to the lowest position.

24. Make sure that the water level is below the door opening.

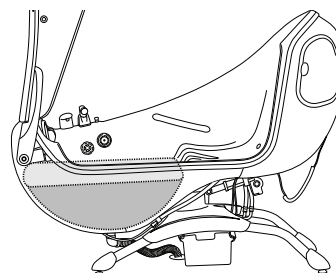

25. Position the standing and raising aid close to the bathtub.

26. Open the bathtub door. Make sure no objects are in the path of opening the door.

27. Gently, spin the patient around and place his or her feet outside the bathtub and dry them thoroughly.

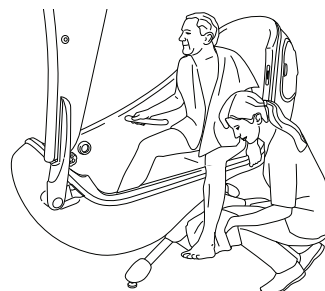

28. Dress the patient's upper body.

29. Dry the patient's feet and legs.

30. Pull the patient's trousers or skirt up to his or her ankle area.

31. Put the sling on.

32. Adjust the height of the bathtub until the patient's feet are positioned on the standing and raising aid.

33. Attach the sling to the standing and raising aid.

34. Activate the lift and raise the patient up.

35. Dry the remaining wet areas of the patient's body.

36. Pull the patient's trousers or skirt all the way up.

37. Clean and disinfect the bathtub. See section Cleaning and disinfection on page 26.

Bathe the patient using a ceiling lift

(18 steps)

The bathtub integrates with Arjo products according to table Allowed combinations on page 43.

Transfer from a ceiling lift

1. Make sure that the bathtub is in an upright position.
2. Close door and prefill the bathtub.
3. When prefilled, recline the bathtub and lower it to its lowest position.

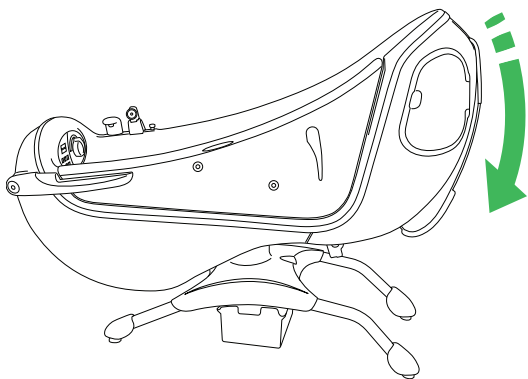

4. Put the patient in a sling.

5.



WARNING

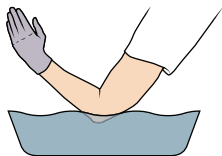

To prevent scalding of patient, always check the water temperature on bare skin.

Feel the water on bare skin. Adjust the water temperature if needed.

6.



WARNING

To prevent entrapment, make sure to keep the patient's hair, arms and feet close to the body and use designated grab supports during any movement.

Transfer the patient over the closed bathtub door to the reclined bathtub.

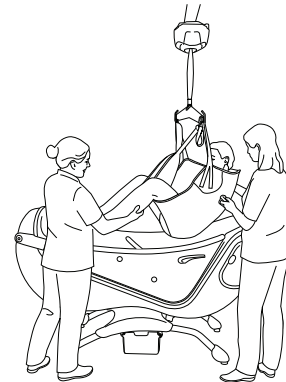

7. Raise the bathtub to an ergonomic working height. Adjust the height of the spreader bar, if needed.
8. Let there be some tension in the sling from the spreader bar to keep the patient in place.

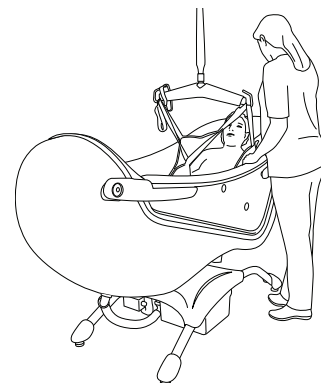

9. Fill the bathtub with water to an appropriate level.
10. Make sure to feel the water temperature and adjust, if needed.

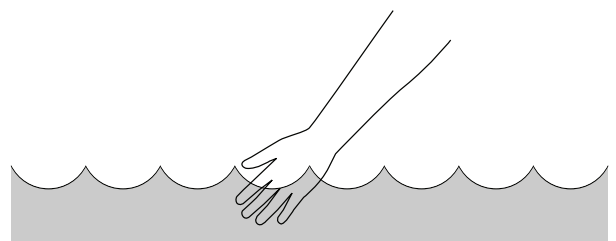

11. Perform bathing according to section Bathe the patient on page 17. Start with step 10 on page 18.
12. Perform showering according to section Shower the patient on page 19.

End the bath

13. Open the drain.
14. Lower the bathtub to the lowest position.
15. Lift patient slightly up from the bathtub and shower the patient's back.

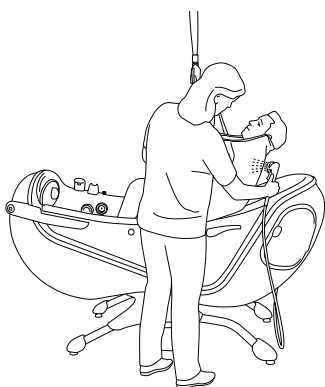

16. Dry the patient in the sling and transfer him or her over the closed bathtub door to a preferred helping aid. Finish drying the patient.

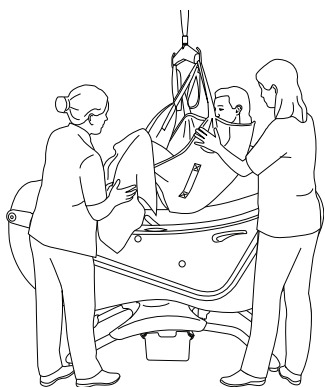

17. Tilt the bathtub to an upright position to drain the bathtub completely.
18. Clean and disinfect the bathtub. See section Cleaning and disinfection on page 26.

Cleaning and disinfection

Thorough disinfection routines are necessary to prevent the build-up of bacteria on and in the equipment and to prevent cross-contamination. This is particularly vital in cases where the bathtub is in a shared facility.



WARNING



To prevent eye and skin damage, always use protective glasses and protective gloves. If contact occurs, rinse with plenty of water. If eyes or skin become irritated, contact a physician. Always read the IFU and the Safety Data Sheet (SDS) of the disinfectant.



WARNING

To prevent cross-contamination, always follow the cleaning and disinfection instructions in this IFU.



WARNING

To prevent cross-contamination, the caregiver must always be present during the whole disinfection procedure to make sure it is performed correctly.



WARNING

To prevent eye or skin irritation, never disinfect the product in the presence of a patient.

CAUTION

To prevent damage on the equipment only use Arjo branded disinfectants.

Allowed disinfectants

For optimal performance only use Arjo disinfectants. If you have any questions regarding disinfecting the equipment or wish to order disinfectant, see section Parts and accessories on page 49.

If the bathtub is equipped with Air Spa system, the bathtub must be disinfected with its integrated disinfection system.

Always disinfect the Air Spa system, even when the blower has not been used.

Equipment needed

- Protective glasses
- Protective gloves
- Spray bottle with disinfectant or disinfection spray handle with disinfectant
- Spray bottle with water or shower handle with water
- Cloths
- Disposable towels
- Soft bristle brush
- Long-handled soft bristle brush

Microbiological formation prevention

In order to enhance the on-site curative actions (chlorine or thermal shock), which do not guarantee a reduction of the contamination long term, make sure to follow the instructions below.

Installation precautions

In order to limit the growth of bacterial flora, it is necessary to take action at four levels:

- Avoid stagnating water and make sure proper water circulation.
- Take precautions against the formation of scale and corrosion based on the water quality.
- Maintain a high water temperature all the way from the hot water dispenser to the different distribution pipes.
- Mix hot and cold water as close as possible to the point of use.

Use

Do not forget to contact Arjo for the annual Preventive Maintenance visit.

- Make sure that the water circulates in the bathtub and the shower on a daily basis even if the bathtub is not used, and particular to make sure to remove any water that may be left behind in the hose.
- Let the water flow approximately 5 minutes before the first bath of the day.
- Clean and disinfect the bathtub according to the IFU before the first bath of the day and after the bath of each patient.

Clean and disinfect with disinfection spray handle (63 steps)



WARNING

To prevent cross-contamination, always follow the cleaning and disinfection instructions in this IFU.

Remove visual residue

1. Raise the bathtub to a convenient working position.

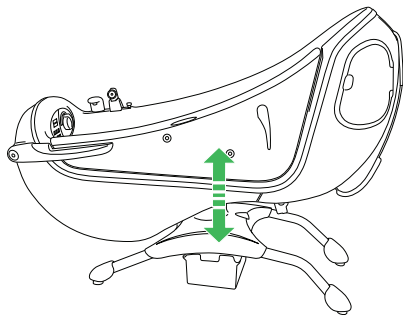

2. Make sure all functions are turned off.

3. Tilt the bathtub to an upright position.

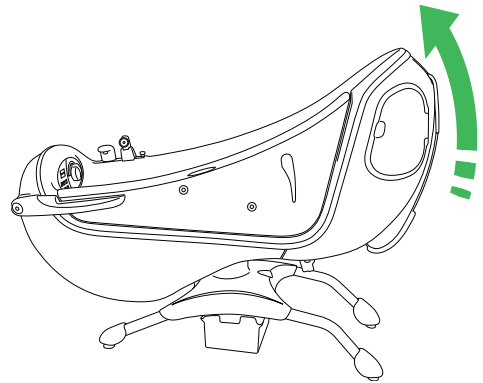

4. Detach and place the accessories (if applicable) such as head cushion, back support cushions and leg rest, at the bottom of the bathtub.
5. Shower and rinse the bathtub and the accessories in the bottom of the bathtub with water to remove visible residue. Turn the accessories and rinse again.
6. Open the drain to empty any remaining water.

Clean

7. Put on protective gloves and glasses.
8. Check the level of the disinfectant in the disinfectant bottle.
9. Open the cover and take out the disinfection spray handle.
10. Press the  disinfection button for 5 s.
11. Spray disinfectant in the bathtub while keeping an eye on the flowmeter.

Continued on next page

12. Check that the mix ratio on the flowmeter is in accordance with the setting range stated in this IFU.

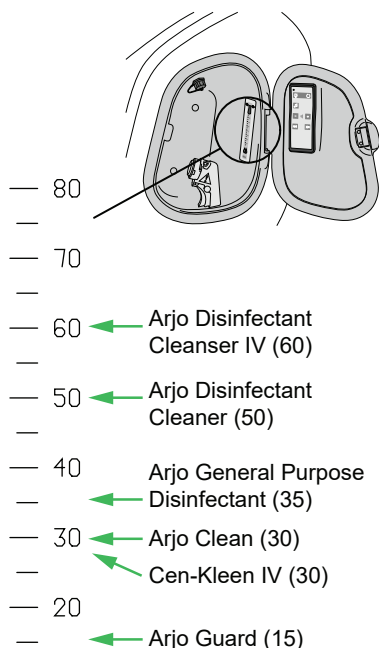

13. If necessary, adjust the knob on the suction hose to get the right mix ratio.

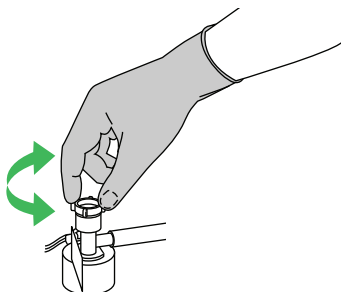

14. Adjust water temperature so that the disinfectant mixture reaches approximately 20 °C (68 °F).
15. Spray disinfectant in the drain. Use a long handled brush to scrub the drain.
16. Close the drain.

17. Spray disinfectant on all internal bathtub surfaces and the accessories at the bottom of the bathtub. Turn the accessories and spray on the other side. Pay attention to parts and knobs and sensors attached to the bathtub surface such as drain control knob/surface overflow outlet.

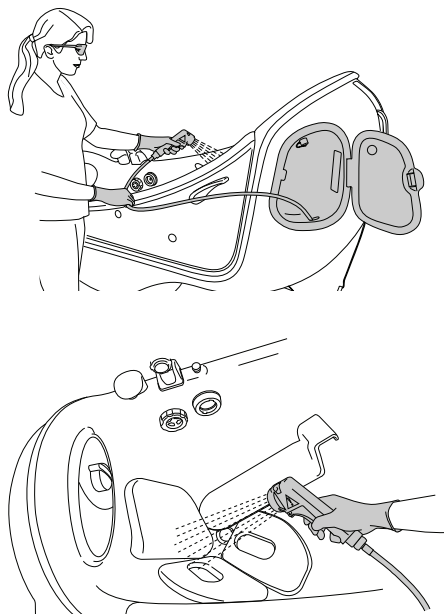

18. Scrub the surfaces of the bathtub, loose parts and accessories with a soft bristle brush or cloth (to remove any deposits e.g. skin flakes). Scrub thoroughly, especially on handles and hand control.

For bathtub with Air Spa system, continue with the following steps. For bathtub without Air Spa system, continue from step 29.

19. Tilt the bathtub backwards so that all nozzles will come in contact with disinfectant.

20. Release trigger and place the disinfection spray handle into the disinfectant/rinsing inlet (some force may be needed).

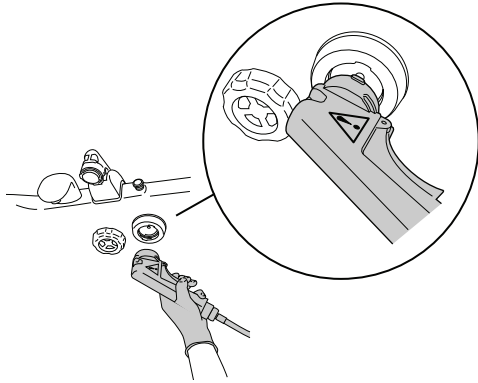

The inlet is fitted with insert locks and can be turned either way to be secured tightly.

21. Press the trigger handle and hold it until the disinfectant flows from all Air Spa system nozzles.

NOTE

Disinfection should be distributed through all Air Spa system nozzles or proper disinfection cannot be guaranteed. Contact qualified service personnel if problems occur.

22. Let it run for another 30 s.
23. Release the trigger and remove the disinfection spray handle from the disinfectant/rinsing inlet.
24. Press the  disinfection button for 5 s to turn disinfection off.
25. Place the disinfection spray handle back in its holder.
26. Place the shower handle into the disinfectant/rinsing inlet and turn it either way to secure it tightly.
27. Press the trigger on the shower handle and hold it until clean water flows from all nozzles.
28. Let it run for another 30 s.
29. Open the drain.
30. Tilt the bathtub to an upright position.

31. Rinse all parts clean with plenty of water having a temperature of approximately 25 °C (77 °F) to rinse off the disinfectant.



32. Press the  shower button on the front panel to turn it off.
33. Place the shower handle in the holder.
34. Soak a cloth in disinfectant.
35. Wipe all other contact areas such as the outside of the bathtub (particularly behind the head), metal sensory knobs and hand control with the cloth.
36. Wet a new cloth with water and remove all traces of disinfectant on contact areas. The cloth should occasionally be rinsed in running water when removing disinfectant.

Disinfect

37. Spray disinfectant into the drain.
38. Close the drain.

Continued on next page

39. Spray disinfectant on all internal bathtub surfaces and the accessories at the bottom of the bathtub. Turn the accessories and spray on the other side. Pay attention to parts and knobs and sensors attached to the bathtub surface such as drain control knob/surface overflow outlet.

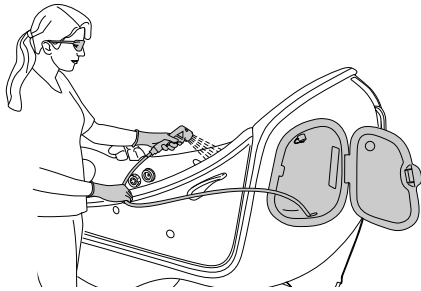

For bathtub with Air Spa system, continue with the following steps. For bathtub without Air Spa system, continue from step 52.

40. Tilt the bathtub backwards so that all nozzles will come in contact with disinfectant.
41. Release trigger and place the disinfection spray handle into the disinfectant/rinsing inlet (some force may be needed).

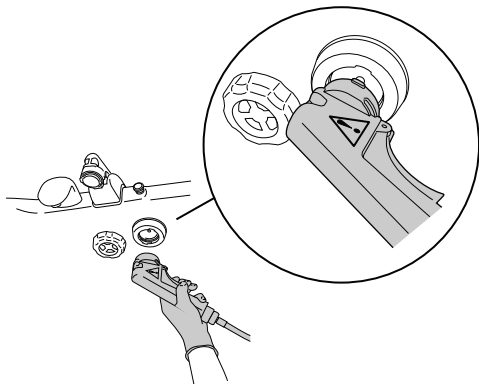

The inlet is fitted with insert locks and can be turned either way to be secured tightly.

42. Press the trigger handle and hold it until the disinfectant flows from all Air Spa system nozzles.

NOTE

Disinfection should be distributed through all Air Spa system nozzles or proper disinfection cannot be guaranteed. Contact qualified service personnel if problems occur.

43. Let it run for another 30 s.
44. Release the trigger and remove the disinfection spray handle from the disinfectant/rinsing inlet.
45. Press the  disinfection button for 5 s to turn disinfection off.
46. Allow an appropriate contact time of the disinfectant according to the disinfectant IFU.
47. Place the disinfection spray handle back in its holder.
48. Place the shower handle into the disinfectant/rinsing inlet and turn it either way to secure it tightly.
49. Press the trigger on the shower handle and hold it until clean water flows from all nozzles.
50. Let it run for another 30 s.
51. Take out the shower handle from the disinfectant/rinsing inlet.
52. Open the drain.
53. Tilt the bathtub to an upright position.
54. Rinse all parts clean with plenty of water having a temperature of approximately 25 °C (77 °F) to rinse off the disinfectant.



55. Soak a cloth in disinfectant.
56. Wipe all other contact areas such as the outside of the bathtub (particularly behind the head), metal sensory knobs and hand control with the cloth.
57. Allow an appropriate contact time of the disinfectant according to the disinfectant IFU.
58. Wet a new cloth with water and remove all traces of disinfectant on contact areas. The cloth should occasionally be rinsed in running water when removing disinfectant.

59. Leave to air dry.

60. Attach any accessories.

Steps 61 to 63 are for Air Spa system only:

61. Press twice on the  Air Spa system button for the whole bathtub, to activate the highest Air Spa system intensity.

62. Keep it running for 30 s to remove water inside the Air Spa system jets.

63. Turn off Air Spa system by pressing the  Air Spa system - whole bathtub button again.

Replace the disinfectant bottle (11 steps)



WARNING

To prevent cross-contamination, always follow the cleaning and disinfection instructions in this IFU.

1. Make sure that the bathtub is in an upright position.

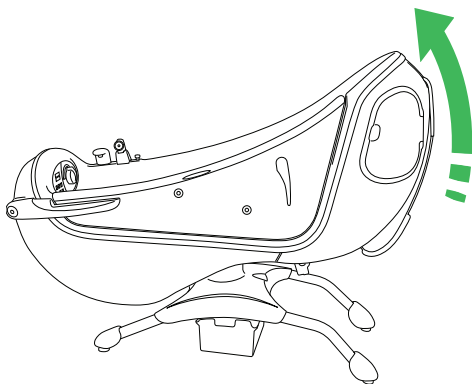

2. Open the compartment for disinfectant bottle.

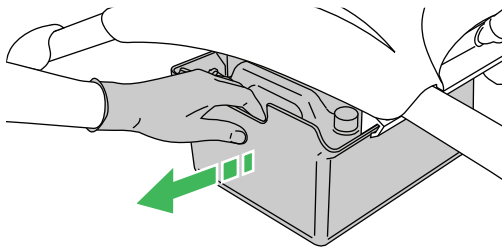

3. Open the bottle lock on the disinfectant bottle.

4. Disconnect the suction part from the bottle.

5. Discard the old bottle and replace with a new one.

6. Open the cover and take out the disinfection spray handle.

7. Press the  disinfection button for 5 s.

8. Spray disinfectant in the bathtub while keeping an eye on the flowmeter.

9. Check that the mix ratio on the flowmeter is in accordance with the setting range stated in this IFU.

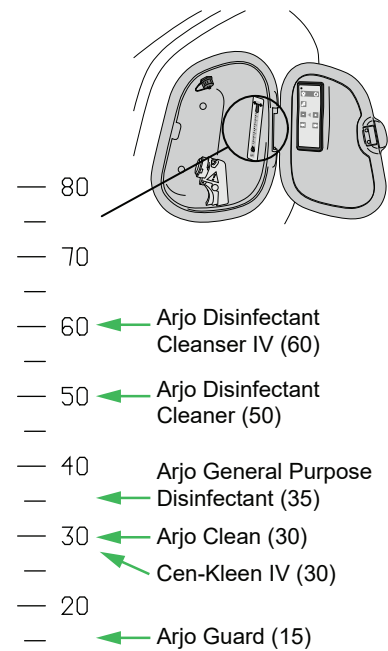

10. If necessary, adjust the knob on the suction hose to get the right mix ratio.

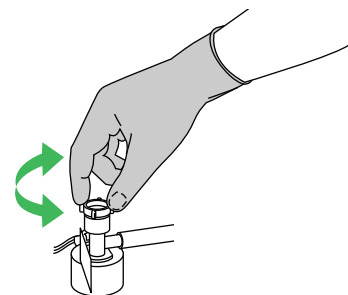

11. Adjust water temperature so that the disinfectant mixture reaches approximately 20 °C (68 °F).

Clean and disinfect with a spray bottle

(31 steps)



WARNING

To prevent cross-contamination, always follow the cleaning and disinfection instructions in this IFU.

Remove visual residue

1. Raise the bathtub to a convenient working position.
2. Make sure all functions are turned off.
3. Open the drain to empty any remaining water.
4. Detach and place the accessories (if applicable) such as head cushion, back support cushions and leg rest, at the bottom of the bathtub.
5. Shower and rinse the bathtub and the accessories in the bottom of the bathtub with water to remove visible residue. Turn the accessories and rinse again.

Clean

6. Put on protective gloves and protective glasses.
7. Mix the disinfectant according to the disinfectant manufacturer's IFU.
8. Spray disinfectant in the drain. Use a long handled brush to scrub the drain.
9. Close the drain.

10. Spray disinfectant on all internal bathtub surfaces and the accessories at the bottom of the bathtub. Turn the accessories and spray on the other side. Pay attention to parts and knobs and sensors attached to the bathtub surface such as drain control knob/surface overflow outlet.

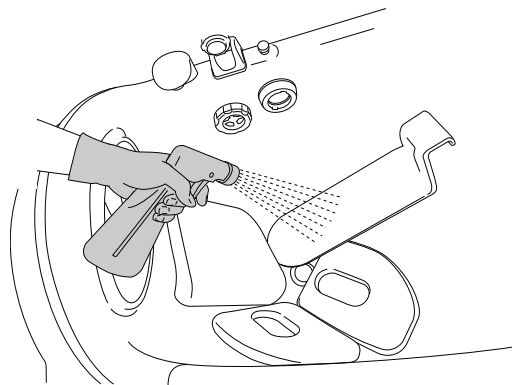

11.

CAUTION

To prevent damage to the product, do not use cleaning equipment that can scratch the surface of the bathtub for example an abrasive cleaning sponge.

Scrub the surfaces of the bathtub, loose parts and accessories with a soft bristle brush or cloth (to remove any deposits e.g. skin flakes). Scrub thoroughly, especially on handles and hand control.

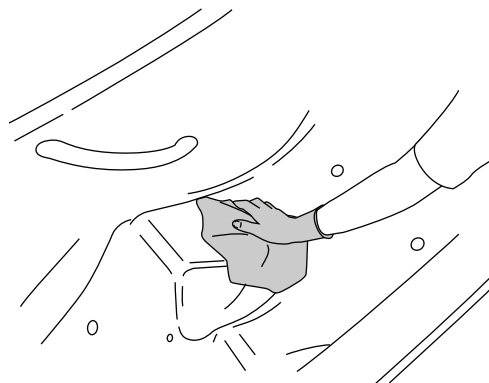

12. Open the drain.
13. Tilt the bathtub to an upright position.
14. Rinse all parts clean with plenty of water having a temperature of approximately 25 °C (77 °F) to rinse off the disinfectant.
15. Soak a cloth in disinfectant.

16. Wipe all other contact areas such as the outside of the bathtub (particularly behind the head), metal sensory knobs and hand control with the cloth.

17. Wet a new cloth with water and remove all traces of disinfectant on contact areas. The cloth should occasionally be rinsed in running water when removing disinfectant.

Disinfect

18. Spray disinfectant into the drain.

19. Close the drain.

20. Spray disinfectant on all internal bathtub surfaces and the accessories at the bottom of the bathtub. Turn the accessories and spray on the other side. Pay attention to parts and knobs and sensors attached to the bathtub surface such as drain control knob/surface overflow outlet.

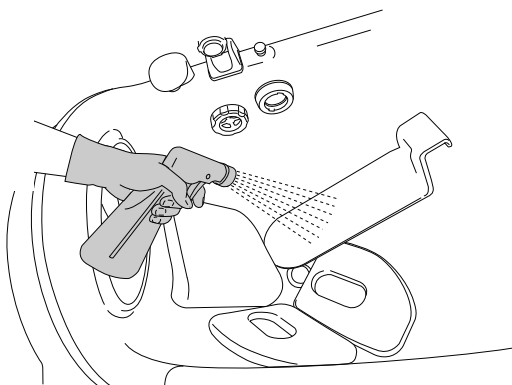

21. Allow an appropriate contact time of the disinfectant according to the disinfectant IFU.

22. Open the drain.

23. Tilt the bathtub to an upright position.

24. Push the button for shower.

25. Rinse all parts clean with plenty of water having a temperature of approximately 25 °C (77 °F) to rinse off the disinfectant.



26. Soak a cloth in disinfectant.

27. Wipe all other contact areas such as the outside of the bathtub (particularly behind the head), metal sensory knobs and hand control with the cloth.

28. Allow an appropriate contact time of the disinfectant according to the disinfectant IFU.

29. Wet a new cloth with water and remove all traces of disinfectant on contact areas. The cloth should occasionally be rinsed in running water when removing disinfectant.

30. Leave to air dry.

31. Attach any accessories.

Care and preventive maintenance

The bathtub is subject to wear and tear, and the following actions must be performed when specified to make sure that the product remains within its original manufacturing specification.



WARNING

To prevent malfunction resulting in injury, make sure to conduct regular inspections and follow the recommended maintenance schedule. In some cases, due to heavy use of the product and exposure to aggressive environment, more frequent inspections should be carried out. Local regulations and standards may be more stringent than the recommended maintenance schedule.



WARNING

To prevent injury to both the patient and the caregiver, never modify the product or use incompatible parts.

NOTE

The product cannot be maintained and serviced while in use with a patient.

Care and preventive maintenance schedule

| CAREGIVER/FACILITY OBLIGATIONS | | | | |
|---|------------------|------------|-------------|------------|
| Action/Check | Between patients | Every week | Every month | Every year |
| Clean and disinfect | • | | | |
| Visually check all exposed parts | | • | | |
| Check accessories | | • | | |
| Visually check hoses, pipes and connections | | • | | |
| Check the hand control and cable | | • | | |
| Check door/seal | | • | | |
| Perform a functionality test | | • | | |
| Check the emergency stop function | | • | | |
| Check/clean shower heads | | | • | |
| Exercise the thermostat mixer | | | • | |
| Check/clean filters, incoming water | | | • | |
| Actions by qualified service personnel only | | | | • |

NOTE

Caregiver/facility obligations shall be carried out by personnel with sufficient product knowledge, following the instructions in this IFU.

Between patients

Clean and disinfect

Before every use, make sure the bathtub is cleaned and disinfected according to section Cleaning and disinfection on page 26.

Every week

Visually check exposed parts

1. Visually check all exposed parts, especially where personal contact is made by either the patient or caregiver.
2. Make sure no cracks or sharp edges have developed that could cause the patient or user injury or that has become unhygienic and can cause cross-contamination.

Any use of chlorine or alcohol can damage the bathtub and cause cracks.

Check accessories

1. Check pillows/leg rest to make sure there are no cracks or tears that would allow water to get into the filling.

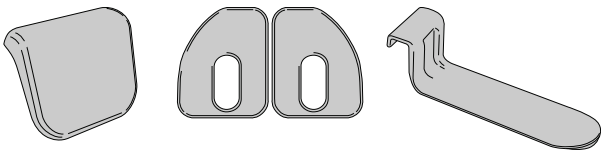

2. If there is such damage, replace.

Visually check hoses, pipes and connections

Visually inspect for leaks of any kind by looking under the bathtub.

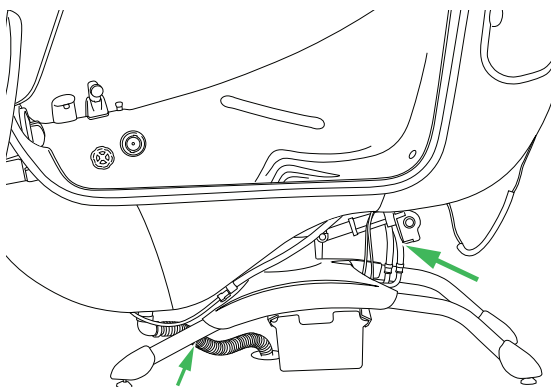

Check hand control and cable

Visually check the condition of the hand control and its cable.

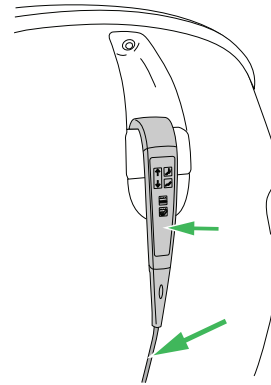

Replace the hand control and cable

If the hand control or cable are cut or damaged, replace them. This can be done without Arjo support.

1. Order a new set.
2. Pull the cord connector out from under the back shell located behind the back seat area of the bathtub.
3. Reach in and plug in the new cord connector of the new hand control.

Check door and seal

1. Open and close the door and check its supports for correct function i.e. the door should not drop by itself during closing.

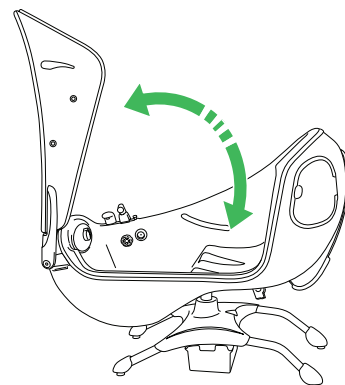

2. Check the lock for proper function.
3. Examine the door seal for cuts, tears or distortion.

Perform functionality test

1. Test all functions, including water, Air Spa system and bathtub movement.
2. With water on: check shower hose and shower handle for damage. Replace if damaged. The shower handle can be replaced without Arjo support.

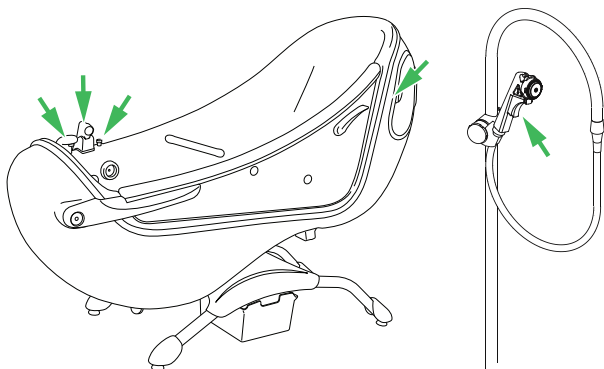

3. If the shower stand is damaged, contact qualified service personnel.

Check the emergency stop function

Check the emergency stop function by pushing down the button.



No filling or showering is possible. Both temperature display background lights will turn off.

Every month

Remove and clean the shower head

1. Loosen the screw.

2. Remove the parts according to the illustration.

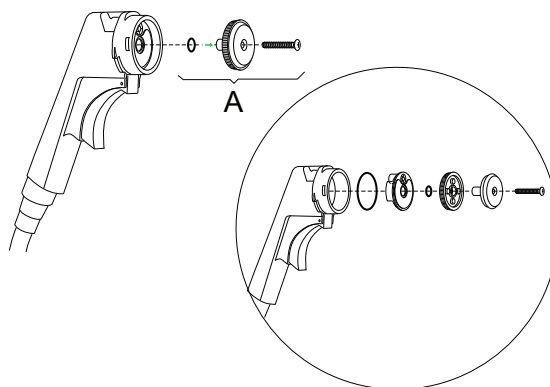

3. Clean carefully.
4. Re-assemble. The parts (A) must be assembled before they can be set into the handle.
5. Tighten the screw carefully.

Exercise the thermostat mixer

Turn the temperature control back and forth over the whole temperature range with water on.



This is particularly important in areas with hard water.

Check and clean filters for incoming water

A rinsing valve with a filter is mounted on each of the two water supply hoses found under the bathtub. The filter in both valves should be rinsed in the order listed.

1.



WARNING

Pressurised system and risk of scalding. Make sure that the valve is closed before removing the cap, this is especially important for the hot water valve.

Close the valves (A). The handles (red for hot water and blue for cold) should be in a cross position.

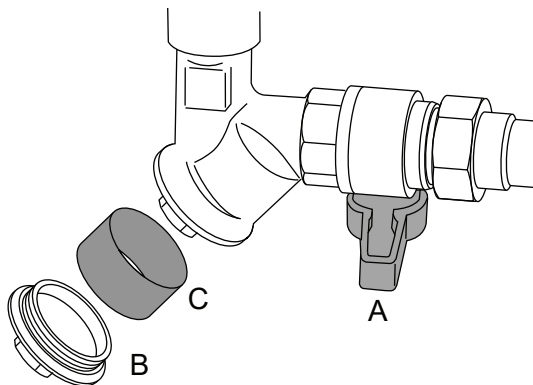

2. Remove the cap (B) with a wrench.
3. Pull out the filter (C) and clean it carefully in water.
4. Reassemble.
5. Open the valves.

Actions by qualified service personnel only

Service of bathtub



WARNING

To prevent injury and/or unsafe product, the maintenance activities must be carried out at the correct frequency by qualified service personnel using correct tools, parts and knowledge of procedures. Qualified service personnel must have documented training in maintenance of this product.

The bathtub must be serviced once a year in accordance with the Maintenance and Repair Manual.

To make sure that you have a problem-free and safe operation, it is recommended to have regular scheduled services with calibration of the thermostatic mixer and thermometer by qualified service personnel. Relocation of the bathtub, significant changes or modifications in local water supply may require re-calibration of the thermostatic mixing valve.

Contact your local Arjo service representative to sign for a service agreement.

NOTE

All caregiver/facility obligations are to be checked when performing the yearly service.

Check electrical installation

To be performed by authorized electrician.

Troubleshooting

NOTE

Before starting the troubleshooting, check the power supply, water supply and the LEDs on the control panel. If the problem cannot be solved with the problem solving actions below, please contact qualified service personnel.

| PROBLEM | ACTION |
|---|---|
| Hand control does not work or control panel buttons do not work and the green power indicator LED is on (not the Sound & Vision system hand control). Hand control still not working (not the Sound & Vision system hand control). | <ol style="list-style-type: none"> 1. Check that the emergency stop is not pressed down. If pressed down then release it by turning the button clockwise. 2. Make sure the Lock function is not active with LED flashing. If lock function is active press the lock button for 2 s to deactivate it. 3. If the control panel works check the attachment of the hand control. If attachment is intact, replace the hand control. 4. If attachment of the hand control is intact then check the Air Spa system function on the control panel. 5. If the Air Spa system buttons on the control panel work, the hand control needs to be replaced. |
| Everything but fill and Air Spa system works, the green power indicator LED is off. The temperature displays have no backlight. | <p>The power to the bathtub is off with the battery LED indicator turned on.</p> <ol style="list-style-type: none"> 1. If it is running on battery, finish the bathing and get the patient out safely. 2. Contact an electrician to make sure the power supply is working correctly before next bathing session. |
| Nothing works, the power indicator LED is off and temperature display is off. | <p>The power is off and there is a flashing or no battery LED indicator.</p> <p>The battery needs to be replaced and the bathtub will not function until the power is on.</p> <p>Contact qualified service personnel for a battery replacement.</p> |
| Fill or shower function stops with a beeping sound. | <p>The back light on the temperature display is flashing. Water is too hot and scalding protection has been activated. There is a wrong temperature setting or water supply fault.</p> |
| Air Spa system stops during operation. (Option) | <ul style="list-style-type: none"> • Normal, if used more than 15 minutes. • If used less than 15 minutes it may be overheated due to high ambient temperature or clogged filter. Can be restarted when cooled off. • Power failure. |
| Only the water flow to the shower is slow. | <p>Check and clean the shower head according to section Remove and clean the shower head on page 36.</p> |
| Water flow from shower and filling spout is slow. | <ol style="list-style-type: none"> 1. In order to feel if any hot water is coming in, feel the incoming hot water line to see if hot. 2. Check and clean filter for incoming water according to section Check and clean filters for incoming water on page 36. |

| PROBLEM | ACTION |
|--|--|
| Disinfection does not work. (Option, not for UK) | <ol style="list-style-type: none"> 1. Make sure the bathtub is empty of any leftover water. If there is water in the bathtub the disinfection LED on the control panel will flash and beep. 2. Make sure disinfection button is pressed in for at least 5 s. 3. If the disinfection LED on the control panel is flashing and beeping, it can also indicate that the level of disinfectant bottle is running low and needs to be replaced. See section Replace the disinfectant bottle on page 31. 4. Make sure shower, fill or Air Spa system is not activated and try again. 5. If power is off and the bathtub is running on battery, the disinfection will not work. |
| Auto fill function will not stop filling after footwell level. | Metal sensory plugs need cleaning because of collected build up. See section Cleaning and disinfection on page 26. |
| Sound & Vision system hand control is not working. (Option) | <p>The LED on the remote control should flash when active.</p> <p>If it is not flashing, replace the Sound & Vision system hand control.</p> |
| Sound & Vision system sound is not working, but bathtub light is working. (Option) | <p>The USB memory stick may be defective.</p> <ol style="list-style-type: none"> 1. If possible, check the USB LED light for indication. Solid light = power ON, Flashing light = reading. 2. Test another USB memory stick. |
| No Sound & Vision system light but sound is working. (Option) | Light is broken and it needs to be replaced by qualified service personnel. |

Technical specification

A full technical description of the bathtub can be found in the service documentation, please contact Arjo for a copy. Contact information appears on the last page of this IFU.

| GENERAL | |
|--|--|
| Tub length in the upright position | 1855 mm / 73 in |
| Tub length in reclined position | 1960 mm / 77 1/8 in |
| Tub width | 750 mm / 29 1/2 in |
| Height of door with bathtub in highest position, feet in lowest position | 2510 mm / 98 7/8 in |
| Maximum patient weight | 210 kg / 463 lb |
| SWL (Safe Working Load) (patient + water) | 300 kg / 661 lb |
| Transfer height at lowest position | 565 mm / 22 1/4 inches |
| Transfer height at highest position | 685 mm / 27 inches |
| Maximum duty cycle Lift/Hi-Lo | 1 minute ON, 9 minutes OFF |
| Maximum duty cycle Air Spa system | 15 minutes ON, 15 minutes OFF |
| Operating forces of controls (Control Panel) | 4 N |
| Operating forces of controls (Hand Control) | 3 N |
| Operating forces of controls (Sound & Vision System Hand Control) | 3 N |
| Medical Equipment | Type B |
| Pollution degree | 2 |
| Degree of fire protection | In accordance with standard EN/ISO 60601-1 |

| WEIGHT | |
|--|------------------------------|
| Bathtub weight depending on selected options (excluding packaging) | 124 - 131 kg 273 - 289 lb |

| WATER | |
|---|-------------------------|
| Water consumption (prefilled foot well volume) | 96 l / 25.4 US gallons |
| Filling time at 3.0 bar (43.5 PSI) dynamic pressure (prefill) | 100 s |
| Water content up to overflow level | 230 l / 60.8 US gallons |
| Water content up to auto fill level | 96 l / 25.4 US gallons |
| Emptying time from auto fill level (96 l) | 3 minutes |

| THERMOMETER | |
|-------------|----------------------|
| Range | 10-50 °C (50-122 °F) |
| Accuracy | +/- 1 °C (1.8 °F) |
| Resolution | 0.1 °C (0.18 °F) |

| MOTION | |
|--|------------|
| Raising time with full load (approximately) | 16 +/- 5 s |
| Lowering time with full load (approximately) | 12 +/- 5 s |

SOUND LEVELS

| | |
|---|--------|
| Sound level at raising / lowering, no load | 61 dBA |
| Sound level at raising / lowering, maximum load | 60 dBA |
| Sound level of Air Spa system, high intensity | 83 dBA |
| Sound level tilt, no load | 60 dBA |

BATTERY

| | |
|---------------------|------------|
| Battery type | Lead, 24 V |
| Battery type number | 59776 |

IP CLASSIFICATION

| | |
|--|-------|
| IP Class | IP X4 |
| IP Class hand control and Sound & Vision System hand control | IP X7 |

FLOOR

| | |
|------------------------|-----------------------------|
| Maximum floor load | 450 kg / 0.8 m ² |
| Maximum floor pressure | 0.6 N/mm ² |

MAIN DISCONNECTION DEVICE

| | |
|--|---|
| Permanently installed in wall, visible and accessible at all times | |
| Mains transient voltage | 4 kV ^a |
| Creepage distance | 3 mm ^a |
| Air clearance | 1.8 mm ^a |
| Direction of movement | Up and down, right and left, clockwise and counterclockwise |
| ^a If local regulations are higher, they must be met. | |



WARNING

To avoid electric shock, make sure that the equipment is connected to:

- Continuously powered supply mains with protective earth.
- Separate fuse and ground fault circuit interrupter (GFCI)
- A mains disconnection device
- Equipotential bonding point

All installations must be in accordance with local codes and regulations.

ELECTRICAL DATA: EU AND NORTH AMERICA

| | |
|-----------|-------------------------------------|
| Voltage | 230 V (EU) 120 V (North America) |
| Frequency | 50 Hz (EU) 60 Hz (North America) |

Continued on next page

ELECTRICAL DATA: EU AND NORTH AMERICA

| | |
|---|--------------------------|
| Power consumption (maximum) | 900 VA |
| Number of phases | Single phase AC |
| Fuses | 230 V 10 A 120 V 13 A |
| Protective earth | Yes |
| Potential equalisation | Yes |
| Power supply cord replaced by qualified service personnel | |

DRAIN REQUIREMENT

| | |
|------------------------|--------------------------------------|
| Flow capacity | 100 l/minute, 26.4 US gallons/minute |
| Position (floor, wall) | Either |

WATER (HOT AND COLD)

| | |
|--|---|
| Connection | 3/4" B.S.P female |
| Upper limit static pressure | 6 bar / 87 PSI For Australia: 5 bar / 72.5 psi |
| Recommended dynamic pressure, at 8 °C (46 °F) and at 80 °C (176 °F) flow of 58 l/minute (15.3 US gallons/minute) | 3 bar / 43 PSI |
| Lower limit dynamic pressure at 8 °C and at 80 °C and 26 l/minute flow (UK) | 0.8 bar / 12 PSI |
| Lower limit dynamic pressure at 8 °C (46 °F) and 80 °C (176 °F) degrees and 29 l/minute (7.7 US gallons/minute) flow. (North America without disinfection) | 1 bar / 15 PSI |
| Lower limit dynamic pressure at 8 °C (46 °F) and 80 °C (176 °F) degrees and 45 l/minute (11.9 US gallons/minute) flow. (All other markets) (North America with disinfection) | 2 bar / 29 PSI |
| Maximum pressure difference between hot and cold water | +/- 0.5 bar / +/- 7 PSI |
| Cold water lower limit temperature | 2 °C (36 °F) |
| Cold water upper limit temperature | 20 °C (68 °F) |
| Hot water lower limit temperature | 60 °C (140 °F) |
| Hot water upper limit temperature | 80 °C (176 °F) For Australia: 65 °C (149 °F) |

MICROBIOLOGICAL DEMANDS

Fulfil WHO:s demands on drinking water and the Drinking Water Directive (DWD) in EU

OPERATING CONDITIONS

| | |
|----------------------|-------------------------------|
| Ambient temperature | 10 °C - 40 °C (50 °F -104 °F) |
| Relative humidity | 30% - 95% Rh |
| Atmospheric pressure | 800 hPa to 1060 hPa |

TRANSPORT AND STORAGE

| | |
|---------------------|--------------------------------------|
| Ambient temperature | -20 °C to 70 °C (-4 °F to 158 °F) |
|---------------------|--------------------------------------|

TRANSPORT AND STORAGE

| | |
|----------------------|----------------------------|
| Relative humidity | 10% - 80% at 20 °C (68 °F) |
| Atmospheric pressure | 500 hPa - 1100 hPa |

END OF LIFE DISPOSAL

| | |
|---------|--|
| Bathtub | <p>Equipment that has electrical and electronic components should be disassembled and recycled per Waste of Electrical and Electronic Equipment (WEEE) or in accordance with national or local regulations.</p> <p>If you have extra liquid, it's safe to pour it down the drain with running water. These products are water-soluble and usually mixed with water when used for cleaning. Your municipality will treat these cleaners the same way they would if you used them for cleaning.</p> <p>The packaging containers should be recycled according to national or local regulations.</p> |
|---------|--|

ALLOWED COMBINATIONS

The bathtub integrates with the following Arjo products:

Sara Stedy, Sara Lite, Sara 3000, Sara Plus, Maxi Move (4 and 5), Maxi Sky 600 (with 2-point spreader bar), Mesh sling with head support (MLA4060 XS-L, XL) and Mesh sling without head support (MLA4531 S-L, XL)

No other combinations have been assessed by Arjo (manufacturer). The facility shall assess any other combination by performing compatibility testing themselves, hereby transferring the responsibility for a safe equipment combination to the facility.

Labels

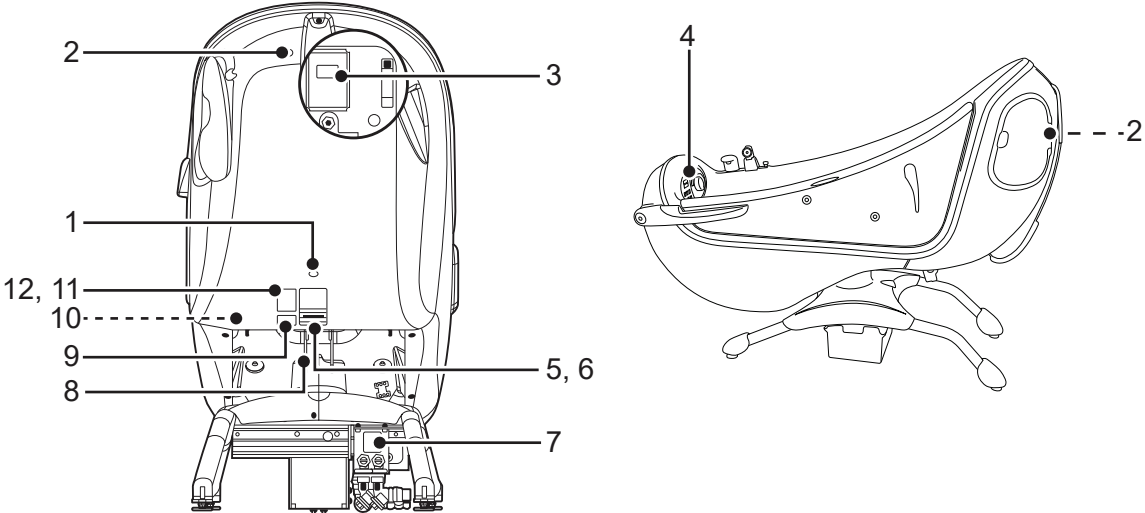

1. Applied part

2. Attention label - Important user information for correct use.

3. Caution label Electrical shock - States a potential hazard for the product.

4. Caution calibration label (located on the control panel before first use) - States that a calibration has to be done before first use and after every installation. See Assembly and Installations Instructions and call qualified service personnel.

5. Data label - States technical performance and requirements, e.g. Input Power, Input Voltage and maximum Patient Weight etc.
6. UL label (US/CA only)

7. KIWA label

8. Equipotential bonding lug label











9. Identification label - States the product identification, serial number and year and month of manufacturing.

10. Sound & Vision label (located on the lid)

11. Approval label - States approvals for the current product. (WRAS and WaterMark)





12. Plumbing standards (US/CA only)

| SYMBOL EXPLANATION | |
|--------------------|--|
| | Refer to instruction manual/ booklet - Instructions for use should be read. |
| | CE marking indicating conformity with European Community harmonised legislation. Figures indicate Notified Body supervision. |
| | Lifting stroke |
| | Equipotentiality |
| Max patient weight | Defines the maximum weight of the patient. |
| Max load | Maximum weight of patient and water |
| Input voltage | Voltage feed |

| SYMBOL EXPLANATION | |
|---|--|
| Input power | Power |
| Fuse F1 Fuse F2 Fuse F3 | Identity of fuses |
|  | General warning |
|  | Emergency stop button |
|  | Name and address of the manufacturer |
|  | Manufacturing date |
| Class I | Connected to protective earth |
| IPX4 | X: The protection against ingress of solid foreign objects is not specified for this product. 4: Protected against splashing water. |
| Air Spa system duty cycle | Time span of having Air Spa system turned ON and OFF. |
| Lift duty cycle | Time span of lifting the bathtub and rest time. |
|  | Type B Applied part: Protection against electrical shock in accordance with IEC 60601-1. The bathtub is considered to be applied part. |
|  | Indicates that the product is a Medical Device according to EU Medical Device Regulation 2017/745. |
|  | Unique device identifier |
|  | Recyclable |
|  | Separate electrical and electronic components for recycling in accordance with the European Directive 2012/19/EU (WEEE) |
|  | Water Supply (Water Fittings) Regulations 1999 (the Water Byelaws 2000 in Scotland) |

Continued on next page

SYMBOL EXPLANATION

| | |
|---|---|
|  | <p>WaterMark certification label with license number WM-026257</p> |
|  | <p>Classified by Underwriters Laboratories Inc. with respect to electrical shock, fire, mechanical, hazards and other specified hazards only in accordance with: AAMI ES60601-1:2005, ES60601-1:2005/AMD1 1:2012, ES60601-1:2005/AMD2:2021 CSA-C22.2 No. 60601-1:14, Amendment 2:2022 (MOD) to CAN/CSA-C22.2 No. 60601-1:14</p> |
|  | <p>KIWA safety mark indicating compliance to EN 1717 and evaluation to KIWA BRL-K14011</p> |
|  | <p>UL recognized marking indicating compliance with Canadian and U.S. safety standards</p> |

UNITED KINGDOM

| | |
|---|--|
|  | <p>UK marking indicating conformity with UK Medical Devices Regulations 2002 (SI 2002 No 618, as amended) Figures indicate UK Approved Body supervision.</p> |
| | <p>UK Responsible Person & UK Importer: Arjo (UK) Ltd, ArjoHuntleigh House, Houghton Regis. LU5 5XF For Northern Ireland (NI) CE marking will still apply until further amendment to applicable regulations.</p> |

Electromagnetic compatibility

Product has been tested for compliance with current regulatory standards regarding its capacity to block EMI (electromagnetic interference) from external sources.

To help reduce electromagnetic interferences, make sure that other devices in patient-monitoring and/or life-support areas comply to accepted emissions standards.



WARNING

Use of this equipment adjacent to or stacked with other equipment should be avoided because it could result in improper operation. If such use is necessary, this equipment and the other equipment should be observed to verify that they are operating normally.



WARNING

Portable RF communications equipment (including peripherals such as antenna cables and external antennas) should be used no closer than 30 cm (12 inches) to any part of the Parker bath, including cables specified by the manufacturer. Otherwise, degradation of the performance of this equipment could result.



WARNING

Use of accessories, transducers and cables other than those specified or provided by the manufacturer of this equipment could result in increased electromagnetic emissions or decreased electromagnetic immunity of this equipment and result in improper operation.

Intended Environment: Professional Healthcare Facility Environment

Exceptions: HF Surgical Equipment and the RF Shielded room of an ME SYSTEM for magnetic resonance imaging

GUIDANCE AND MANUFACTURER'S DECLARATION – ELECTROMAGNETIC EMISSION

| Emission test | Compliance | Guidance |
|---|------------|---|
| RF emissions CISPR 11 | Group 1 | This equipment uses RF energy only for its internal functions. Therefore its RF emissions are very low and are not likely to cause any interference in nearby electronic equipment. This equipment is suitable for use in all establishments, including domestic establishments and those directly connected to the public low voltage power supply network that supplies buildings used for domestic purposes. |
| RF emissions CISPR 11 | Class B | |
| Harmonic emissions IEC 61000-3-2 | Class A | |
| Voltage fluctuations/ flicker emissions IEC 61000-3-3 | Complies | |

GUIDANCE AND MANUFACTURER'S DECLARATION - ELECTROMAGNETIC IMMUNITY

| Immunity test | IEC 60601-1-2 test level | Compliance level |
|---|---|---|
| Electrostatic discharge (ESD) EN 61000-4-2 | ±2kV, ±4kV, ±8kV, ±15kV air ±8kV contact | ±2kV, ±4kV, ±8kV, ±15kV air ±8kV contact |

Continued on next page

GUIDANCE AND MANUFACTURER'S DECLARATION - ELECTROMAGNETIC IMMUNITY

| Immunity test | IEC 60601-1-2 test level | Compliance level |
|--|--|--|
| Conducted disturbances inducted by RF fields EN 61000-4-6 | 3V in 0,15 MHz to 80 MHz 6V in ISM and amateur radio bands between 0,15 MHz and 80 MHz 80% AM at 1 kHz | 3V in 0,15 MHz to 80 MHz 6V in ISM and amateur radio bands between 0,15 MHz and 80 MHz 80% AM at 1 kHz |
| Radiated RF electromagnetic field EN 61000-4-3 | Professional Healthcare environment 3 V/m 80 MHz to 2,7 GHz 80% AM at 1 kHz | Professional Healthcare environment 3 V/m 80 MHz to 2,7 GHz 80% AM at 1 kHz |
| Proximity fields from RF wireless communications equipment EN 61000-4-3 | 385 MHz - 27 V/m 450 MHz - 28 V/m 710, 745, 780 MHz - 9V/m 810, 870, 930 MHz - 28 V/m 1720, 1845, 1970, 2450 MHz - 28 V/m 5240, 5500, 5785 MHz - 9V/m | 385 MHz - 27 V/m 450 MHz - 28 V/m 710, 745, 780 MHz - 9V/m 810, 870, 930 MHz - 28 V/m 1720, 1845, 1970, 2450 MHz - 28 V/m 5240, 5500, 5785 MHz - 9V/m |
| Electrical fast transient/burst EN 61000-4-4 | ±2kV AC port 100kHz repetition frequency | ±2kV AC port 100kHz repetition frequency |
| Power frequency Magnetic field EN 61000-4-8 | 30A/m 50 Hz or 60 Hz | 30A/m 50 Hz |
| Surge IEC 61000-4-5 | ±0,5kV ±1kV; ±2 kV, AC Mains, Line to Ground ±0,5kV ±1kV, AC Mains, Line to Line | ±0,5kV ±1kV; ±2 kV, AC Mains, Line to Ground ±0,5kV ±1kV, AC Mains, Line to Line |
| Voltage dips, short interruptions and voltage variations on power supply input lines IEC 61000-4-11 | 0 % UT; 0,5 cycle At 0°, 45°, 90°, 135°, 180°, 225°, 270° and 315° 0 % UT; 1 cycle and 70 % UT; 25/30 cycles Single phase: at 0° 0 % UT; 250/300 cycle | 0 % UT; 0,5 cycle At 0°, 45°, 90°, 135°, 180°, 225°, 270° and 315° 0 % UT; 1 cycle and 70 % UT; 25/30 cycles Single phase: at 0° 0 % UT; 250/300 cycle |
| Proximity magnetic fields EN 61000-4-39 | 134,2 kHz - 65 A/m 13,56 MHz - 7,5 A/m | 134,2 kHz - 65 A/m 13,56 MHz - 7,5 A/m |

NOTE

UT is the AC mains voltage prior to application of the test level.

Parts and accessories

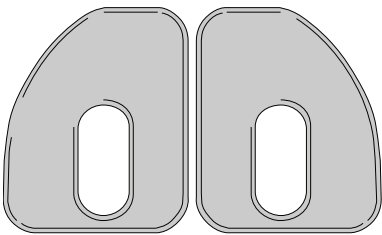
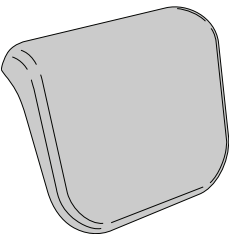
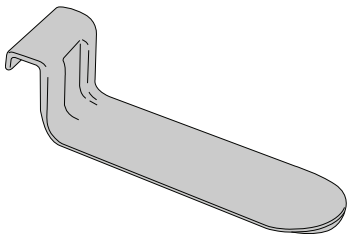
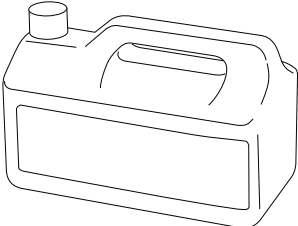
| | | |
|---|---|---|
|  |  |  |
| 400.00.00.15 - Blue Back support cushion | 8357404-013 - Blue Head cushion | 8257376-033 Leg rest |
|  | | |
| For disinfectant contact the local Arjo representative | | |

Intentionally left blank

AUSTRALIA
Arjo Australia Pty Ltd 4/2
Southridge St, Eastern Creek NSW 2766
Phone: 1800 072 040
E-mail: customerservice-au@arjo.com

BELGIQUE / BELGIË
Arjo Belgium
Evenbroekveld 16
9420 Erpe-Mere
Phone: +32 (0) 53 60 73 80
Fax: +32 (0) 53 60 73 81
E-mail: info.belgium@arjo.com

BRASIL
Arjo Brasil Equipamentos Médicos Ltda
Avenida Piraiba, 352, Sala 18
Centro Comercial Jubran - Barueri/SP – Brazil
CEP: 06460-121
Phone: 55-11-3588-5088
E-mail: vendas.latam@arjo.com
E-mail: servicios.latam@arjo.com

CANADA
Arjo Canada Inc.
90 Matheson Boulevard West
Suite 350
CA-MISSISSAUGA, ON, L5R 3R3
Tel/Tél: +1 905 238 7880
Free: +1 (800) 665-4831
Fax: +1 (905) 238-7881
E-mail: info.canada@arjo.com

ČESKÁ REPUBLIKA
Arjo Czech Republic s.r.o.
Škrétova 490/12
120 00 Praha 2
Czech Republic
Phone No: +420225092307
E-mail: info.cz@arjo.com

DANMARK
Arjo A/S
Industriparken 21A
2750 BALLERUP, Denmark
Tel: +45 49 13 84 86
Fax: +45 49 13 84 87
E-mail: dk_kundeservice@arjo.com

DEUTSCHLAND
Arjo GmbH
Peter-Sander-Strasse 10
DE-55252 MAINZ-KASTEL
Tel: +49 (0) 6134 186 0
Fax: +49 (0) 6134 186 160
E-mail: info-de@arjo.com

ESPAÑA
ARJO IBERIA S.L.
Poligono Can Salvatella
c/ Cabanyes 1-7
08210 Barberà del Valles
Barcelona - Spain
Telefono 1: +34 900 921 850
Telefono 2: +34 931 315 999

FRANCE
Arjo France
10 Rue Denis Papin
CS 62535
59652 VILLENEUVE D'ASCQ CEDEX
Tél: +33 (0) 3 20 28 13 13
Fax: +33 (0) 3 20 28 13 14
E-mail: info.france@arjo.com

HONG KONG
Arjo Hong Kong Limited
Room 411-414, 4/F, Manhattan Centre,
8 Kwai Cheong Road, Kwai Chung, N.T.,
HONG KONG
Tel: +852 2960 7600
Fax: +852 2960 1711

ITALIA
Arjo Italia S.p.A.
Via Giacomo Peroni 400-402
IT-00131 ROMA
Tel: +39 (0) 6 87426211
Fax: +39 (0) 6 87426222
E-mail: Italy.promo@arjo.com

MIDDLE EAST
Arjo Middle East FZ-LLC
Office 908, 9th Floor,
HQ Building, North Tower,
Dubai Science Park,
Al Barsha South
P.O Box 11488, Dubai,
United Arab Emirates
Direct +971 487 48053
Fax +971 487 48072
Email: Info.ME@arjo.com

NEDERLAND
Arjo Nederland BV
Biezenwei 21
4004 MB TIEL
Postbus 6116
4000 HC TIEL
Tel: +31 (0) 344 64 08 00
Fax: +31 (0) 344 64 08 85
E-mail: info.nl@arjo.com

NEW ZEALAND
Arjo Ltd
34 Vestey Drive
Mount Wellington
NZ-AUCKLAND 1060
Tel: +64 (0) 9 573 5344
Free Call: 0800 000 151
Fax: +64 (0) 9 573 5384
E-mail: nz.info@Arjo.com

NORGE
Arjo Norway AS
Olaf Helsets vei 5
N-0694 OSLO
Tel: +47 22 08 00 50
Faks: +47 22 08 00 51
E-mail: no.kundeservice@arjo.com

ÖSTERREICH
Arjo Austria GmbH
Lemböckgasse 49 / Stiege A / 4.OG
A-1230 Wien
Tel: +43 1 8 66 56
Fax: +43 1 866 56 7000

POLSKA
Arjo Polska Sp. z o.o.
ul. Ks Piotra Wawrzyniaka 2
PL-62-052 KOMORNIKI (Poznań)
Tel: +48 691 119 999
E-mail: arjo@arjo.com

PORTUGAL
Arjo em Portugal
MAQUET Portugal, Lda.
(Distribuidor Exclusivo)
Rua Poeta Bocage n.º 2 - 2G
PT-1600-233 Lisboa
Tel: +351 214 189 815
Fax: +351 214 177 413
E-mail: Portugal@arjo.com

SUISSE / SCHWEIZ
Arjo Switzerland AG
Zelglimatte 3 / Haus H
6260 Reiden
Switzerland
Tél/Tel: +41 (0) 61 337 97 77
Fax: +41 (0) 61 311 97 42

SUOMI
Arjo Scandinavia AB
Riihitontuntie 7 C
02200 Espoo
Finland
Puh: +358 9 6824 1260
E-mail: Asiakaspalvelu.finland@arjo.com

SVERIGE
Arjo International HQ
Hans Michelsensgatan 10
SE-211 20 MALMÖ
Tel: +46 (0) 10 494 7760
Fax: +46 (0) 10 494 7761
E-mail: kundservice@arjo.com

UNITED KINGDOM
Arjo UK and Ireland
Houghton Hall Park
Houghton Regis
UK-DUNSTABLE LU5 5XF
Tel: +44 (0) 1582 745 700
Fax: +44 (0) 1582 745 745
E-mail: sales.admin@arjo.com

USA
Arjo Inc.
2349 W Lake Street Suite 250
US-Addison, IL 60101
Tel: +1 (630) 307-2756
Free: +1 (800) 323-1245
Fax: +1 (630) 307 6195
E-mail: us.info@arjo.com

JAPAN
Arjo Japan K.K.
東京都港区虎ノ門三丁目 7 番 8 号
ランディック第 2 虎ノ門ビル 9 階
Tel: +81 (0)3-6435-6401
Fax: +81 (0)3-6435-6402
E-mail: info.japan@arjo.com
www.arjo.com

Address page Rev 35 • 2025-07

At Arjo, we believe that empowering movement within healthcare environments is essential to quality care. Our products and solutions are designed to promote a safe and dignified experience through patient handling, medical beds, personal hygiene, disinfection, diagnostics, and the prevention of pressure injuries and venous thromboembolism. With over 6500 people worldwide and 65 years caring for patients and healthcare professionals, we are committed to driving healthier outcomes for people facing mobility challenges.



ArjoHuntleigh AB
Hans Michelsensgatan 10
211 20 Malmö, Sweden
www.arjo.com

arjo

CE
2797