

INSTRUCTIONS FOR USE

Maxi Twin Compact



WARNING

To avoid injury, always read this Instructions for Use and accompanied documents before using the product.



Mandatory to read the Instructions for Use

Design Policy and Copyright

® and ™ are trademarks belonging to the Arjo group of companies.

© Arjo 2022.

As our policy is one of continuous improvement, we reserve the right to modify designs without prior notice. The content of this publication may not be copied either whole or in part without the consent of Arjo.

Contents

Foreword	4
Intended Use	5
Safety Instructions	6
Preparations	7
Parts Designation	8
Slings	10
Product Description/Function	12
Hand Control	12
Lifting	12
Adjustable Width of Chassis Legs	12
Brakes	13
Driving/Positioning Handles	13
Soft Cover	13
Emergency Stop Button	14
Emergency Lowering Ring	14
Powered Spreader Bar	15
Automatic Safety Stop	15
Battery	16
Battery Indicator Light	16
Battery Charger	16
Attach the Leg Clips (Passive Sling)	17
Straight Leg Attachment	17
Crossed Leg Attachment	17
Transferring the Resident	18
To Lift from a Chair (6 Steps)	19
Return to Chair	20
To Lift from a Bed (10 Steps)	21
Return to Bed	22
To Lift from the Floor (9 Steps)	23
Transfer Resident from Car	25
Transfer Resident to Car	27
Home Care Use	28
For Distributors and Renters	28
Using Maxi Twin Compact Lift	28
Battery Instructions	30
Cleaning and Disinfecting Instructions	31
Care and Preventative Maintenance	33
Troubleshooting	37
Technical Specifications	38
Dimensions	40
Labels on Maxi Twin Compact Lift	41
Electromagnetic Compatibility	44
Parts and Accessories	46

Foreword

Thank you for purchasing Arjo equipment.

Your Maxi Twin Compact® mobile passive lift is part of a series of quality products designed especially for hospitals, nursing homes and other health care use. We are dedicated to serving your needs and providing the best products available along with training that will bring your staff maximum benefit from every Arjo product.

Please contact us if you have any questions about the operation or maintenance of your Arjo equipment.

Please Read this *Instructions for Use* thoroughly!

Please read this *Instructions for Use (IFU)* in its entirety before using the *Maxi Twin Compact* lift. Information in the *IFU* is crucial to the proper operation and maintenance of the equipment, and will help protect your product and make sure that the equipment performs to your satisfaction. Some of the information in this *IFU* is important for your safety and must be read and understood to help prevent possible injury.

Unauthorized modifications on any Arjo equipment may affect its safety. Arjo will not be held responsible for any accidents, incidents or lack of performance that occur as a result of any unauthorized modification to its products.

Report Unexpected Operations or Events

Contact your local Arjo representative if any unexpected operations or events occur. The contact information appear on the last page of this *IFU*.

Serious incident

If a serious incident occurs in relation to this medical device, affecting the user, or the patient then the user or patient should report the serious incident to the medical device manufacturer or the distributor. In the European Union, the user should also report the serious incident to the Competent Authority in the member state where they are located.

Service and Support

A service routine must be performed on the *Maxi Twin Compact* lift every year by Arjo authorized service personnel to make sure the safety and daily operation of your product. See section *Care and Preventative Maintenance* on page 33.

If you require further information, please contact your local Arjo representative who can offer comprehensive support and service programs to maximize the long-term safety, reliability and value of the product. Contact your local Arjo representative for replacement parts.

Your service representative stocks the parts you will need.

The contact information appears on the last page of this *IFU*.

Definitions in this *IFU*

WARNING

Means: Safety warning. Failure to understand and obey this warning may result in injury to you or to others.

CAUTION

Means: Failure to follow these instructions may cause damage to all or parts of the system.

NOTE

Means: This is important information for the correct use of this system or equipment.



Means: The name and address of the manufacturer.

Intended Use

This equipment must be used in accordance with these safety instructions. Anyone using the equipment must also have read and understood the instructions in this *Instructions for Use (IFU)*.

If there is anything you are not sure about, contact your Arjo representative.

The *Maxi Twin Compact* lift is a floor based sling lift.

The lift is intended to be used for lifting and transfers in hospitals, nursing homes, private homes and in home care of residents. The equipment is intended for indoor use, with the exception of transfers to and from a car, during which the *Maxi Twin Compact* may be used for short outdoor distances on hard surfaces (such as driveways, streets or garage floors). The outdoor surface should be relatively flat, dry and free of debris, rocks, etc.

The *Maxi Twin Compact* lift is intended to be used for residents who:

- sit in a wheelchair
- have no capacity to support themselves
- cannot stand unsupported and are not able to bear weight, not even partially
- are dependent on the caregiver in most situations

or, for a resident who:

- is passive
- might be almost and/or completely bedridden
- is often stiff or have contracted joints
- is totally dependent on the caregiver

The transfer with the *Maxi Twin Compact* lift takes place indoors in the resident's room, common areas or in bathrooms. Patient insertions and extractions into and from cars may include outdoor transfers under certain conditions.

The *Maxi Twin Compact* lift is only to be used with Arjo-supplied slings that are designed to be used with the *Maxi Twin Compact* lift.

The *Maxi Twin Compact* lift should only be used for the purpose specified in the *Instructions for Use (IFU)*. Any other use is prohibited.

Resident Assessment

We recommend that facilities establish regular assessment routines. Caregivers should assess each resident according to the following criteria prior to use:

- The residents weight must not exceed 160 kg, (350 lbs).
- The product should not be used for residents who suffer from uncontrollable head movements.

If the resident does not meet these criteria an alternative equipment/system shall be used.

Indication for Use

A non-AC-powered patient lift is a hydraulic, battery, or mechanically powered device, either fixed or mobile, used to lift and transport a patient in the horizontal or other required position from one place to another, as from a bed to a bath. The device includes straps and a sling to support the patient.

Installation and Service Requirements

The expected lifetime of this equipment, unless otherwise stated, is ten (10) years, subject to preventive maintenance being carried out in accordance with the instructions for care and maintenance found in the *Instructions for Use (IFU)*.

Depending on level of wear some equipment parts such as castors and hand control may need to be replaced during the equipment life time according to information in the *Instructions for use (IFU)*.

Safety Instructions

WARNING

To avoid injury to both the patient and the caregiver, never modify the equipment or use incompatible parts.

WARNING

To avoid injury, make sure there is a safe distance between the resident and the device. Pay particular attention to resident with uncontrollable movements.

WARNING

To avoid falling, make sure that the user weight is lower than the safe working load for all products or accessories being used.

WARNING

To avoid injury, only use Arjo slings specified in these *Instructions for Use*. To select correct sling size follow the specific sling *Instructions for Use*.

WARNING

To avoid entrapment, make sure to keep the residents hair, arms and feet close to the body and use designated grab supports during any movement.

WARNING

To avoid the resident from falling, always make sure that the device is in the lowest possible position before attempting to transfer, dress or undress the resident.

WARNING

To avoid entrapment of the residents or caregivers legs or feet, make sure that they are kept clear of all obstacles.

WARNING

To avoid explosion or fire, never use the equipment in oxygen rich environment, in presence of heat source or flammable anaesthetic gases.

WARNING

To avoid injury, make sure that the resident is not left unattended at any time.

WARNING

To avoid the device from tipping and the resident from falling, do not use the equipment on floor with recessed drains, holes or slopes exceeding a ratio of 1:50 (1.15°).

WARNING

To avoid falling during transfer, always make sure that the brakes are applied on all equipment being used.

WARNING

Do not leave/use the *Maxi Twin Compact* lift and accessories for extended periods in humid, wet areas or in the shower.

Do not use the *Maxi Twin Compact* lift or accessories in the shower.

Preparations

Actions Before the First Use (9 Steps)

- 1 Visually check the package for damage. If the product looks damaged make a complaint to the transport agency.
- 2 Remove packaging by doing following:
 - Cut the two securing plastic bands.
 - Lift off the cardboard cover.
 - Remove the plastic packaging.
 - Remove the cardboard around the legs of the lift.
 - Carefully remove the lift away from the pallet.
- 3 The packaging should be recycled according to local regulations.
- 4 Check that all parts of the product are supplied. Compare with the product description in this *IFU*. If any part is missing or damaged - do not use the product!
- 5 Unpack the battery charger. Select and attach the adapter correctly suited to your power outlet. See *Battery charger IFU*.
- 6 Charge the battery until indicator indicates full charge.
- 7 Disinfect the product according to section *Cleaning and Disinfecting Instructions on page 31*.
- 8 Prepare an area that is dry, with good ventilation and out of direct sunlight for storage of the *Maxi Twin Compact* lift.
- 9 Choose a designated area, where the *IFU* should be kept and is accessible at all times for the users.

NOTE

If you have any questions, please contact your local Arjo representative for support and service.

Actions Before Every Use (4 Steps)

- 1 Check that all parts of the lift are in place. Compare to *Part Designations* page.
- 2 Pre-inspect the sling prior to use. If any part is missing or damaged - do NOT use the product.
- 3 **WARNING**
To prevent cross-contamination, always follow the disinfection instructions in this *Instructions for Use*.
- 4 A resident prone to kicking must have the leg clips of the sling crossed. This prevents the resident from falling as a result of clip detachment due to kicking. See section *Attach the Leg Clips (Passive Sling)* on page 17.

Maxi Twin Compact lift directions

The direction of driving during transfer is according to the illustration below.

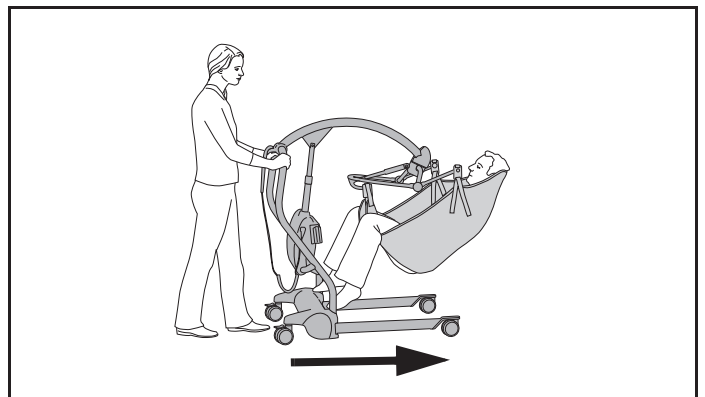

The directions left or right on the *Maxi Twin Compact* lift are given as shown in the illustration.

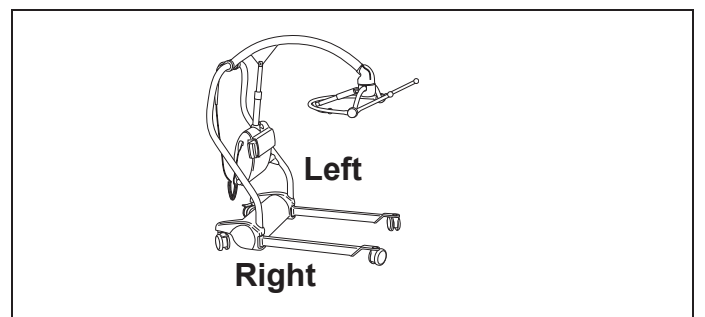

Parts Designation

- 1 Mast
- 2 Jib
- 3 Adjustable legs
- 4 Castors (rear)
- 5 Non-breakable castors (front)
- 6 Spreader bar
- 7 Soft cover
Soft cover, red (accessory)
- 8 Hand control
- 9 Hand control hang point
- 10 Battery
- 11 Lift actuator
- 12 Actuator - spreader bar
- 13 Driving/positioning handles

- 14 Emergency lowering
- 15 Emergency stop button
- 16 Battery (charging)
- 17 Battery holder
- 18 Battery charger



Entire Product:
Type BF
Applied part: protection against
electrical shock in accordance with
EN 60601-1.

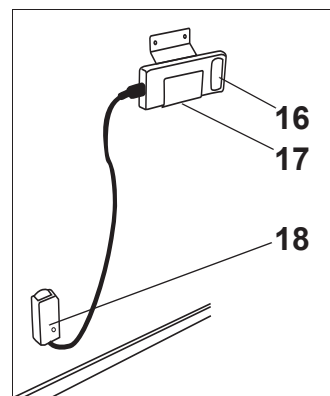
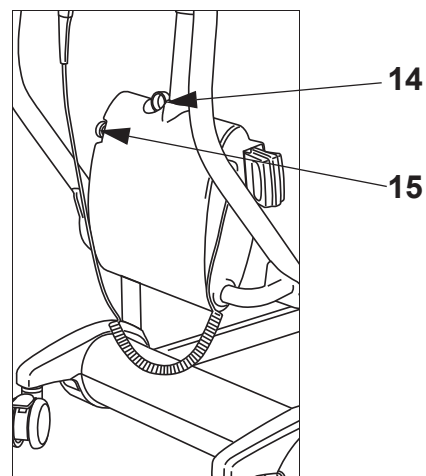
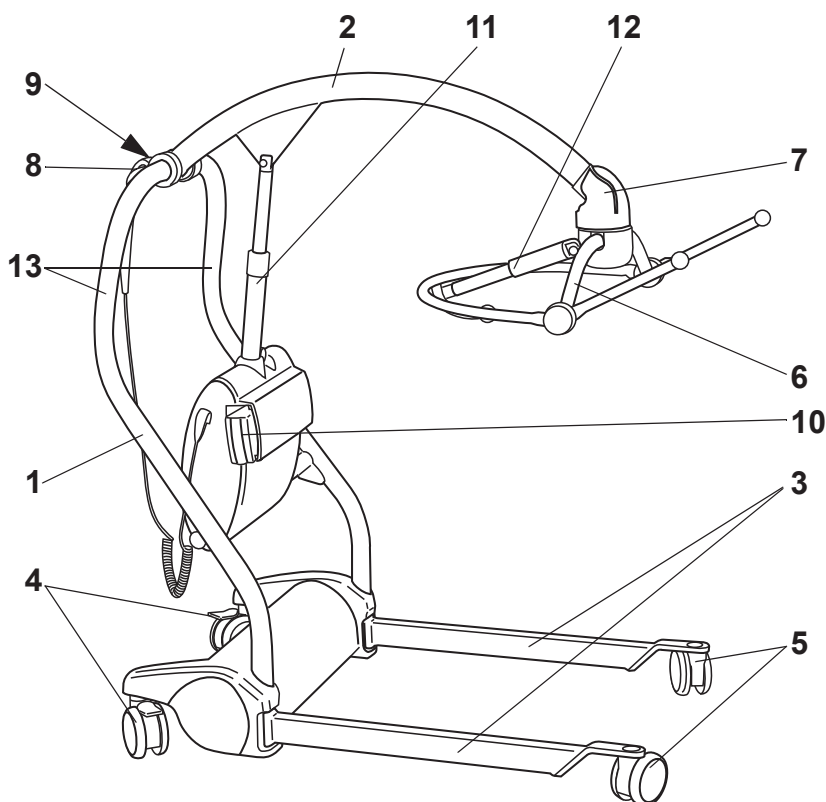

Intentionally left blank

Slings

A label is fitted to the hanger frame for quick colour to size reference See section *Labels on Maxi Twin Compact Lift* on page 41.

Refer to the *Passive Clip Sling IFU* when the size of sling should be chosen.

All Arjo slings are coded for size by having different coloured edge binding as follows:

- Red - Small - S
- Yellow - Medium - M
- Green - Large - L
- Purple - Large Large - LL

Make sure never exceed the **safe working load of the sling or the lift**. The lowest value should always be valid.

WARNING

To avoid injury, only use Arjo slings specified in these *Instructions for Use*. To select correct sling size follow the specific sling *Instructions for Use*.

NOTE

If Arjo Slings are to be used with the *Maxi Twin Compact* lift, then always refer to their instructions before use. Arjo slings with head support have two pockets at the head section which contain plastic reinforcement pieces during use. Always make sure these reinforcement pieces have been inserted into the sling pockets before using the sling.

Sling Profiles that can be used with Maxi Twin Compact lift

Size: S - LL

**Four point toileting sling
(with head support)**

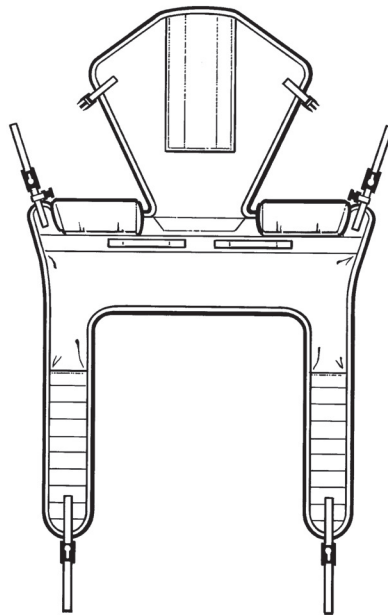

Four point amputee sling

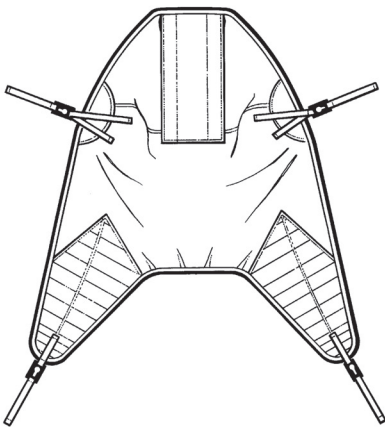
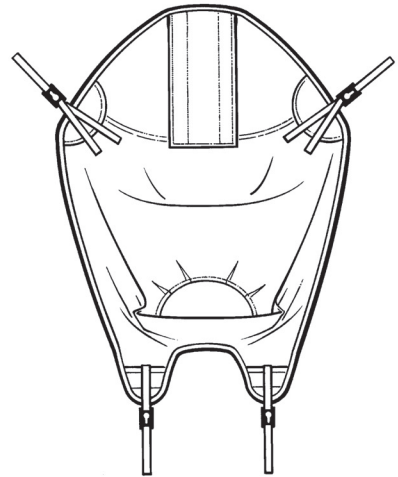

Four point padded sling

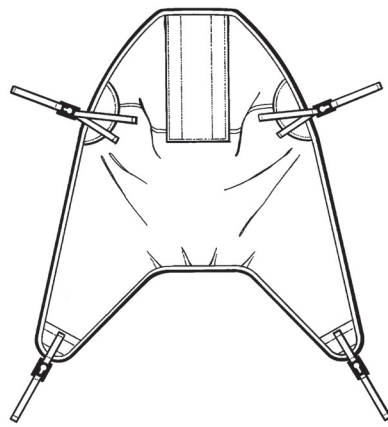

Four point unpadded sling

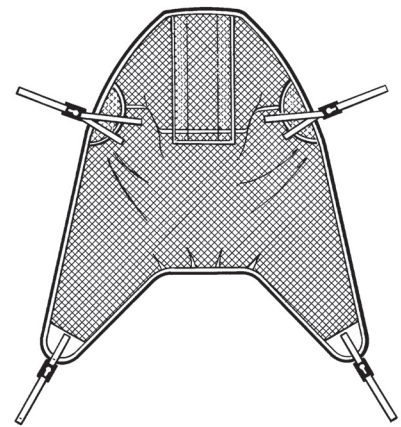

Four point mesh sling

Product Description/Function

Fig. 1

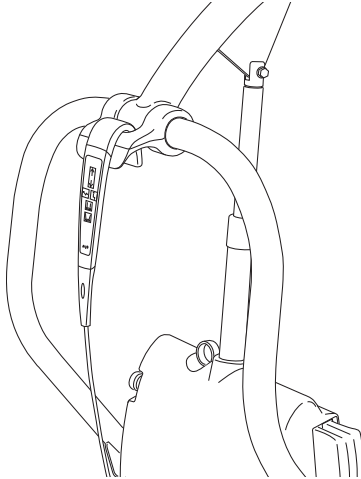

Hand Control

CAUTION

Do not drop the hand control into water.

The hand control has an integrated hook which makes it easy to attach. When not in use, the hand control can be conveniently kept ready for use by hooking it over the hand control hang point at the top of the mast. (See Fig. 1)

Unhook the hand control and hold it in your hand (See Fig. 2):

- Press (A) button in order to raise the jib.
- Press (B) button in order to lower the jib.
- Press (C) button for reclined position.
- Press (D) button for sitting position.
- Press (E) button for **leg close** of chassis.
- Press (F) button for **leg open** of chassis.

Lifting

The lifting/lowering movement is performed by an actuator driven by an electric motor.

Fig. 2

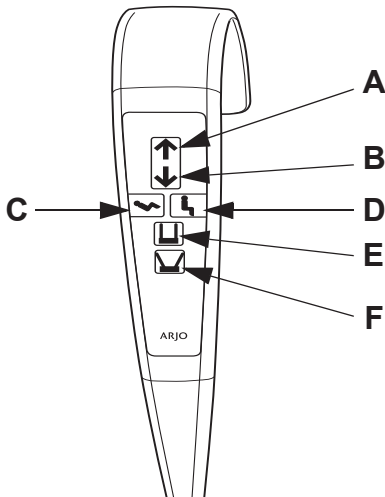
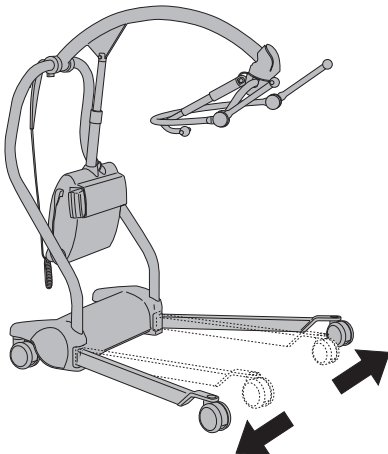

Fig. 3



Adjustable Width of Chassis Legs

The chassis legs can be opened to variable widths.

Select the “Open chassis legs” button on the hand control and keep pressing it until the required width is achieved.

To close, press the “Close chassis legs” button. When pressure is released from the button, movement will stop and the chassis legs will remain securely in position. (See Fig. 3)

NOTE

When opening or closing the legs of the powered chassis, make sure that no one stands in the way of the moving chassis legs.

Fig. 1

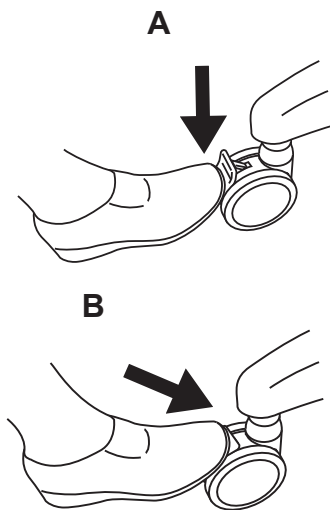

Brakes

The chassis rear castors have brakes which can be foot operated to keep the *Maxi Twin Compact* lift in position. Brake **(A)** and release the brake **(B)**. The brakes on both castors have to be applied to get full effect. (See Fig. 1)

Fig. 2

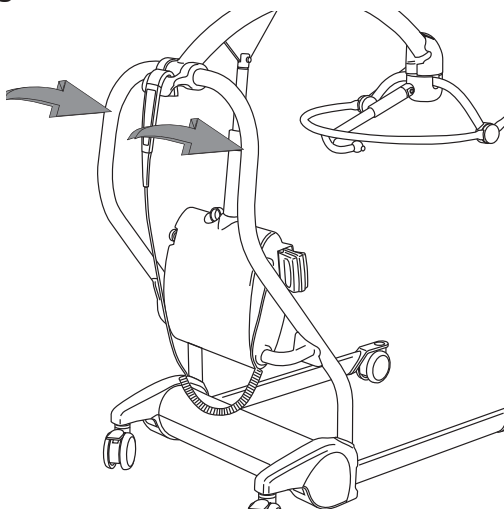

Driving/Positioning Handles

Use the driving handles when pushing and positioning the *Maxi Twin Compact* lift. (See Fig. 2)

Fig. 3

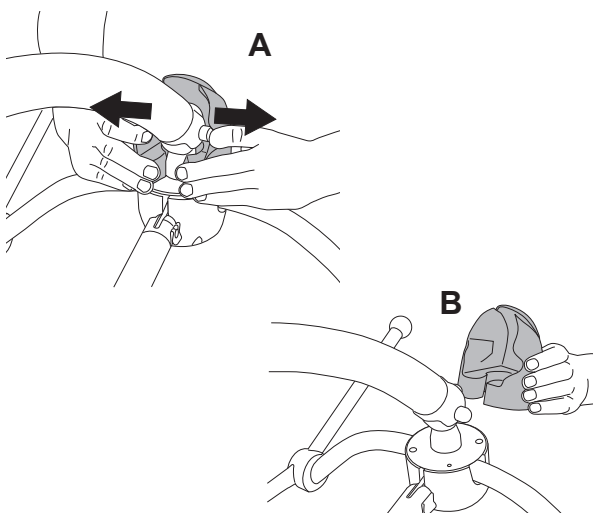

Soft Cover

Placed on the end of the jib to protect the resident from being hurt. The upper part of the cover can be removed to facilitate cleaning. (See Fig. 3; A and B)

The cover can also be removed and changed to a red colour (accessory). The deep red colour helps when transferring a resident with dementia as the colour makes it easier for the resident to be aware of the jib and so reduce any risk of an impact. (See Fig. 3)

Fig. 1

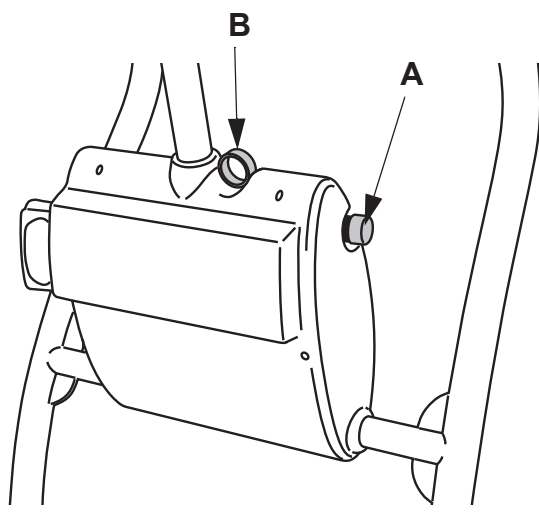

Emergency Stop Button

If, in an emergency, you have to immediately stop any powered movement, (other than by releasing pressure on the hand control button), press the emergency stop button (A).

(See Fig. 1)

Once the emergency stop button has been operated, it will have to be reset before any powered movement can be utilised.

To reset the emergency stop function, turn the red emergency button 1/8 of a turn clockwise until it pops up.

Emergency Lowering Ring

WARNING

To avoid injury, only use the emergency lowering when normal lowering is impossible. Use extreme care during lowering.

It is necessary to pull the ring (B) slowly and carefully to get a controlled lowering of a heavy resident. If not, the lowering might be too fast.

This can be used in the event of main control failure. Emergency Lowering control (B), situated on the top of the main lift actuator housing, a green and white identification label is positioned near the control. Pull the control up to operate, release the control during use and lowering will stop.

(See Fig. 1)

NOTE

Due to internal friction, the speed of lowering will vary depending on the weight of the resident. You may have to assist the downwards movement by pulling down the jib.

Fig. 1

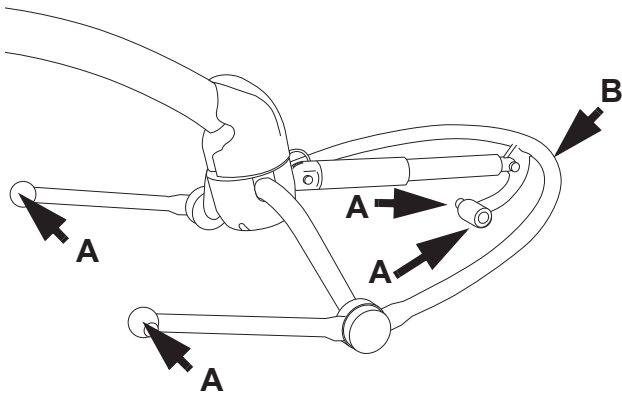

Powered Spreader Bar

Four knobs (A) enable the sling clips to be attached.

Adjustment by hand of the position of the resident sideways is possible when using the spreader bar frame (B).

The spreader bar is operated from the hand control and moves the resident to reclined or sitting position. (See Fig. 1)

CAUTION

Do not immerse the spreader bar under water, it can damage the positioning system.

Automatic Safety Stop

This is not operator controlled but a function built into the electronics of the lift.

Function I:

If the lift is moving up /down and it moves against something, the movement will be stopped by an automatic safety stop. Release the up /down button on the hand control.

Function II:

If the lift is mistakenly overloaded with a resident heavier than permitted, an automatic safety stop will automatically be activated. If this occurs, stop pressing the up button on the hand control. Lower the resident by pressing the down button and then remove the resident from the lift.

Fig. 1

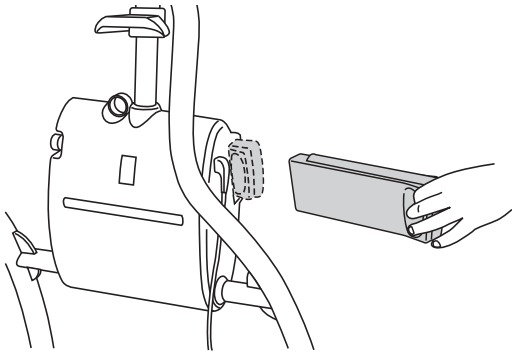

Battery

The battery is situated on the side of the lift actuator housing.
(See Fig. 1)

NOTE

The battery shape only fits correctly into the lift with its raised edge upwards.

Battery Indicator Light

A beeping sound and a low battery indicator **(A)** light will flash when the battery needs charging. The function in progress will be able to be finished. (See Fig. 1)

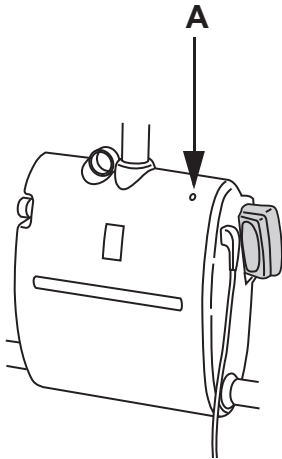
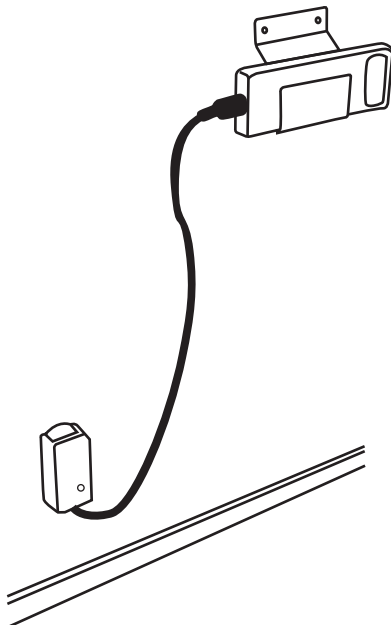

Fig. 2



Battery Charger

See Battery charger *IFU*. (See Fig. 2)

Type no:

NEA 8000

Attach the Leg Clips (Passive Sling)

Fig. 1

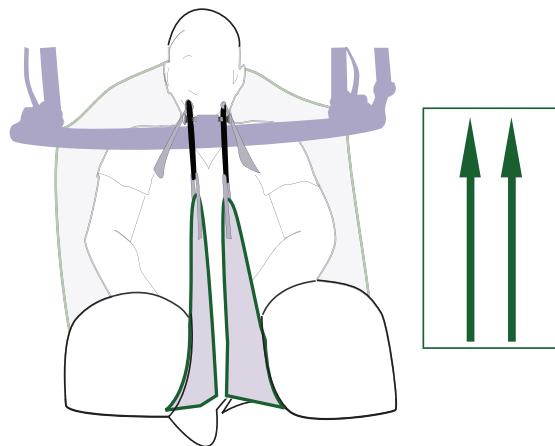

Straight Leg Attachment

For most residents, it is recommended to use the straight attachment of the leg clips. (See Fig. 1)

Attach the leg clips to the lugs so that the leg straps are positioned vertically.

Fig. 2

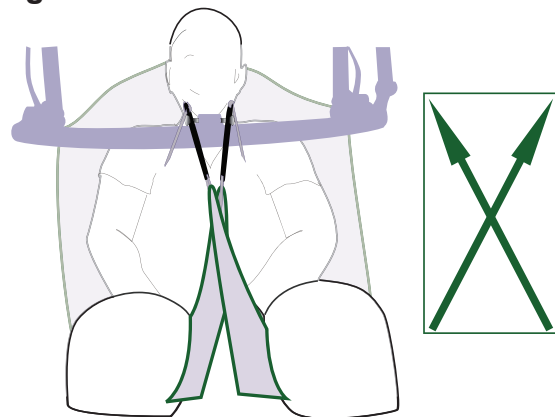

Crossed Leg Attachment

If the resident is prone to kicking, the crossed leg attachment of the clips must be applied. This prohibits the leg clips from detachment due to kicking and prevents the resident from possible injury. (See Fig. 2)

Cross the leg straps of the sling and attach the clips to the lugs.

Transferring the Resident

Before the Resident is Transferred onto the *Maxi Twin Compact* lift, make sure that:

- the battery pack is fully charged before use (for charging, see *Battery IFU*) and remove it from the charger unit and insert it into the battery position of the *Maxi Twin Compact* lift. Electrical connection will be made automatically.
- a selection of sling types and sizes are easily available for all types of lifting procedure when using the *Maxi Twin Compact* lift.
- where possible, approach the resident from the front.
- if required, the chassis legs can be opened to go around a chair or wheelchair

WARNING

To avoid injury, make sure that the resident is not left unattended at any time.

WARNING

To avoid entrapment, make sure the path of the movement is free from obstacles.

Fig. 1

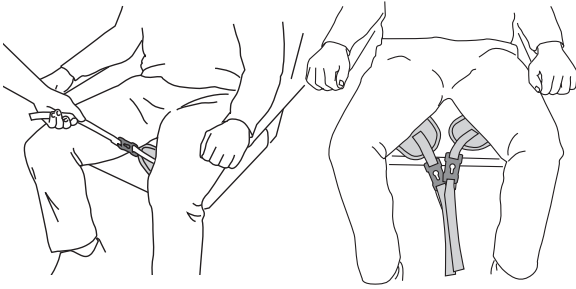

Fig. 2

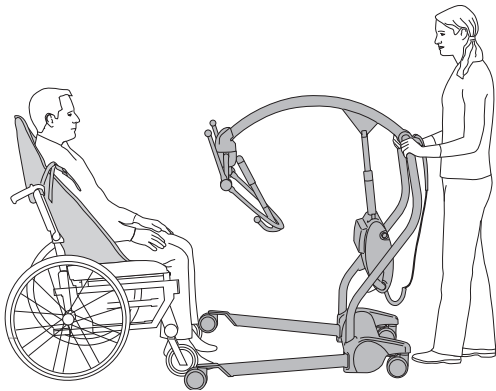

Fig. 3

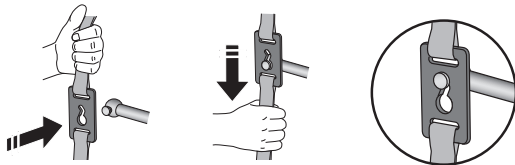
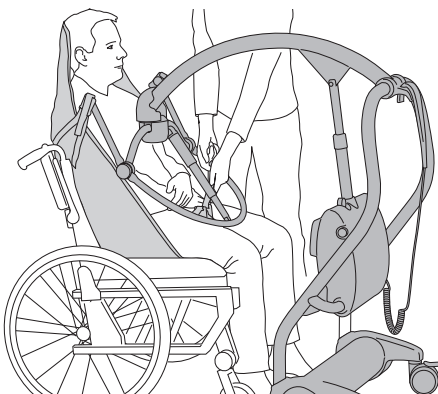

Fig. 4



To Lift from a Chair (6 Steps)

1

WARNING

To avoid injury, make sure there is a safe distance between the resident and the device. Pay particular attention to resident with uncontrollable movements.

Place the sling around the resident so that the base of his/her spine is covered, and the head support area is behind the head. Pull each leg piece under the thigh so that it emerges and does not remain folded. (See Fig. 1)

2

Place the *Maxi Twin Compact* lift close enough to be able to attach the shoulder clips of the sling to the spreader bar. To accomplish this you may have to put the resident's feet on, or over the chassis. (See Fig. 2).

3

WARNING

To avoid entrapment, make sure to keep the residents hair, arms and feet close to the body and use designated grab supports during any movement.

NOTE

Do not apply the castor brakes at this stage, as the position of the resident will adjust to his/her own centre of gravity when lifted.

With the *Maxi Twin Compact* lift in position, first attach the shoulder clips to the lugs on the spreader bar and then attach the leg clips). (See Fig. 3)

4

Lower the spreader bar using the hand control, be careful not to lower it onto the resident. If the spreader bar is lowered too close against the thigh of the resident a beep sound will be heard and the powered motion will stop immediately. (See Fig. 4)

Continue with the steps on the next page.

Fig. 5



5

WARNING

To avoid the resident falling, make sure that sling clips or loops are securely attached before as well as during the lifting initiation.

Raise the resident by operating the hand control, move the lift away from the chair. (See Fig. 5)

- 6 Adjust the angle of recline to a comfortable position and a height a little higher than normal chair height. Turn the resident to face the caregiver before the transfer. Make sure that her/his feet are safely above the floor. (See Fig. 6)

Fig. 6



Fig. 7

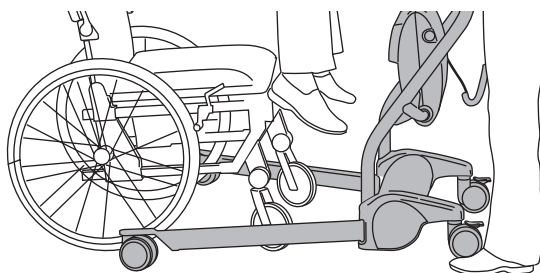

Return to Chair

When returning to a chair, make sure the lift legs are positioned around the legs/wheels of the chair. (See Fig. 7)

To position the resident over the chair, use the lift handles, do NOT pull the sling.

The resident suspended in sling should always remain in the centre of gravity. (See Fig. 5)

Use the hand control to lower the resident.

When lowering the resident back into a chair - or when transferring from bed to chair:

- Position the resident via the hand control to maximum sitting position.
- Lower the resident onto the chair. Make sure that the resident is positioned well back in the chair.

To Lift from a Bed (10 Steps)

Before lifting a person from a bed, make sure there is sufficient clearance underneath to accommodate the *Maxi Twin Compact* lift chassis legs.

It is possible via the hand control to adjust chassis leg widths to assist manoeuvrability around obstructions, for example, bed legs.

Fig. 1

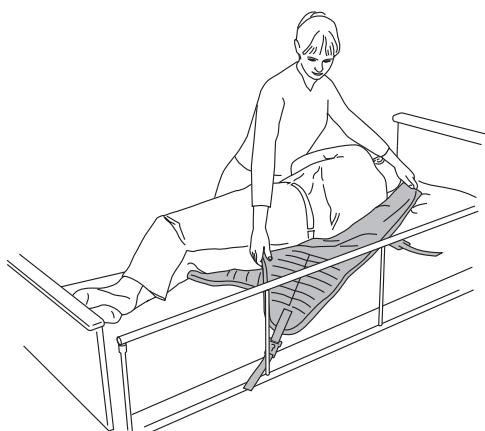
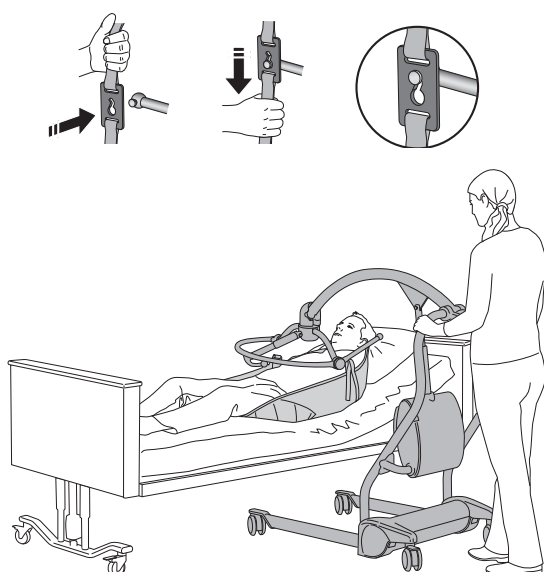

Fig. 2



Fig. 3



1 NOTE

When rolling the resident back onto the sling, roll the resident slightly in the opposite direction so that the folded part of the sling can be brought out.

Position the resident onto the sling by rolling the resident towards you then folding the sling in half and placing it behind the resident's back. This is also called the log roll method. (See Fig. 1)

- 2 Position the sling carefully so that when rolled back, the resident is centred on the sling and check that the head support area of the sling covers the resident's neck. (See Fig. 2)

Alternatively, the resident can be brought into a sitting position then place the sling as detailed in the section "To Lift From A Chair".

3 WARNING

To avoid injury to the resident, pay close attention when lowering or adjusting the spreader bar.

Approach the bed with the open side of the spreader bar towards the resident's head. (See Fig. 3)

- 4 Position the *Maxi Twin Compact* lift so that the spreader bar is just above, and centred over the resident. (See Fig. 3)
- 5 If possible, slightly raise the head part of the bed to make the fastening of attachment clips easier. (See Fig. 3)
- 6 Tilt the spreader bar until the shoulder attachment points can be connected to the sling shoulder clips. (See Fig. 3)
- 7 Connect the sling leg pieces. Pull each leg piece under the thigh so that it emerges and does not remain folded. You may need to lower the spreader bar a little more, using the hand control. (See Fig. 3)

Continue with the steps on the next page.

Fig. 4

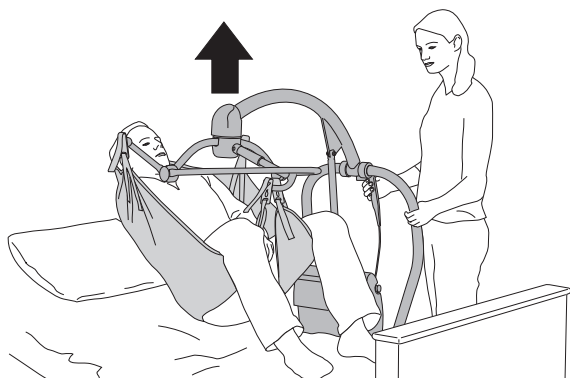

Fig. 5

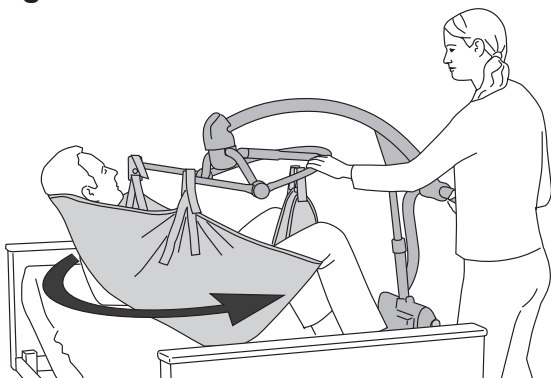
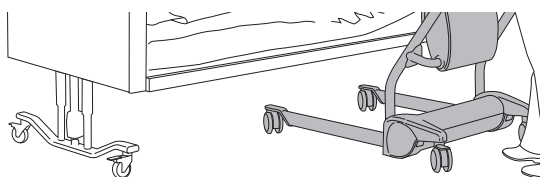

Fig. 6



Fig. 7



8 WARNING

To avoid injury to the resident, pay close attention when lowering or adjusting the spreader bar.

Lift the resident using the hand control. (See Fig. 4)

9 NOTE

When turning the resident pay close attention so as not to hit the resident's legs against the mast.

Turn the resident to face the caregiver. (See Fig. 5)

- 10 Adjust to a comfortable position for the resident, a little higher than a normal chair height. Make sure that her/his feet are safely above the floor. (See Fig. 6)

Return to Bed

When returning to a bed, make sure the lift is positioned perpendicular to the bed. (See Fig. 7)

To position the resident over the bed, use the lift handles, do NOT pull the sling. The resident suspended in sling should always remain in the centre of gravity.

Use the hand control to lower the resident.

Move into the desired position above the bed. Adjust the sling position and then lower the resident using the hand control.

WARNING

To avoid the resident from falling or caregiver from being injured, only detach the sling clips when the resident's body weight is fully supported by the bed or chair.

Move the *Maxi Twin Compact* lift away before removing the sling from under the resident.

Fig. 1

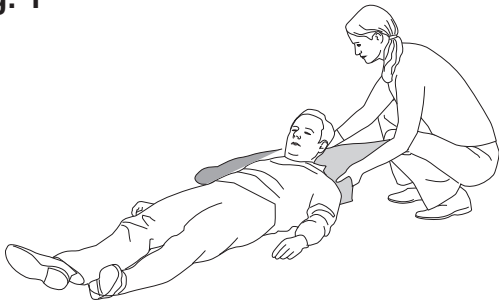

Fig. 2

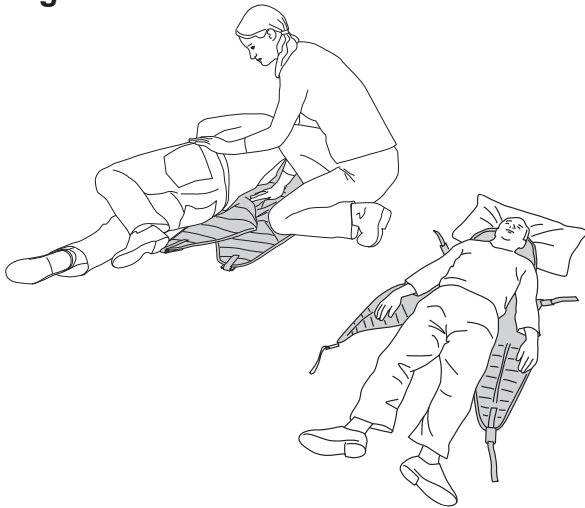

Fig. 3

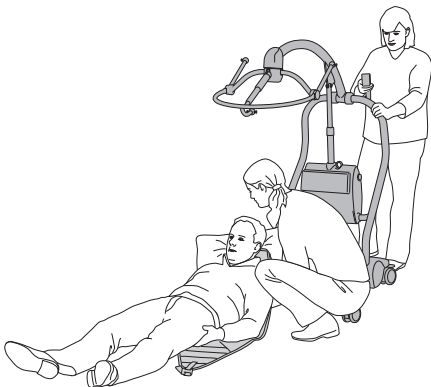
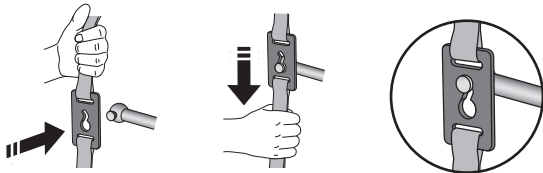

Fig. 4



To Lift from the Floor (9 Steps)

This procedure needs two caregivers.

- 1 Put a pillow under the resident's head and shoulders for comfort. (See Fig. 1)

2 **WARNING**

To avoid entrapment, make sure to keep the residents hair, arms and feet close to the body and use designated grab supports during any movement.

Put the sling around the resident by using the log roll method. See section *To Lift from a Chair (6 Steps)* on page 19 and *To Lift from a Bed (10 Steps)* on page 21. (See Fig. 2)

- 3 Approach the resident with the open part of the chassis. Open the chassis legs if necessary. Apply the brakes of the lift. (See Fig. 3)

- 4 Attach the shoulder clips. (See Fig. 4)

Continue with the steps on the next page.

Fig. 5

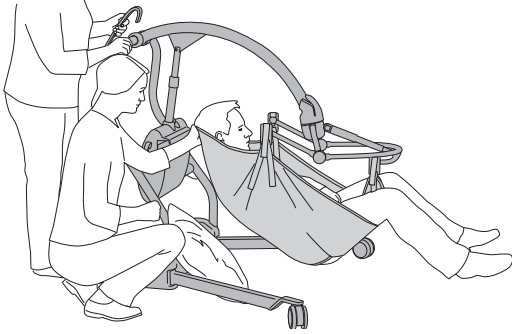

5 **WARNING**

To avoid injury, make sure there is a safe distance between the resident and the device. Pay particular attention to resident with uncontrollable movements.

Once connected, attach the leg clips. To ease the clip on process, push the appropriate button on the hand control to get the spreader bar in a closer position to the clips. This will have the effect of raising the resident's head and shoulders slightly. (See Fig. 5)

6 **WARNING**

To avoid the resident falling, make sure that sling clips or loops are securely attached before as well as during the lifting initiation.

Raise the resident from the floor in a semi-recumbent position. Supporting the head increases comfort and reassurance for the resident - maintain distance to the jib. Straighten out the leg sections of the sling out for added comfort. (See Fig. 5)

Fig. 6



- 7 Turn the resident to face the caregiver. (See Fig. 6)
- 8 Adjust to a comfortable position for the resident, a little higher than a normal chair height. Make sure that her/his feet are a safe distance from floor. (See Fig. 6)
- 9 Release the brakes. (See Fig. 6)

Transfer Resident from Car

This procedure needs two caregivers to monitor both sides of the resident.

WARNING

To avoid accidents, as cars come in many shapes and sizes, a caregiver assessment should be completed to ensure the resident can safely reach their destination (to or from the car) with the lift.

Make sure there is ample access for the resident in order to correctly apply the sling. Also make sure there is sufficient door opening and car roof clearance in order to manoeuvre the lift and avoid situations where there isn't sufficient space

WARNING

To avoid accidents, the Maxi Twin Compact should only be used for short distances on hard surfaces (such as driveways, streets or garage floors). The outdoor surface should be relatively flat, dry and free of debris, rocks, etc.

WARNING

Do not perform resident transfers with the Maxi Twin Compact when car is next to a street pavement's edge.

WARNING

Avoid using the Maxi Twin Compact in rain or snow conditions, unless the transfer area is under cover and protected from the weather.

Fig. 1



- 1 Unfasten resident's seatbelt.
- 2 Place the sling around the resident so that the base of the sling sits about one inch (2-3 cm) below the tail bone.
- 3 Ensure that the head support area of the sling is behind the head, covering it so that the head stays in place.
- 4 Pull each leg strap under the thigh so that it comes out on the inside of the thigh. (See Fig. 1)

Fig. 2

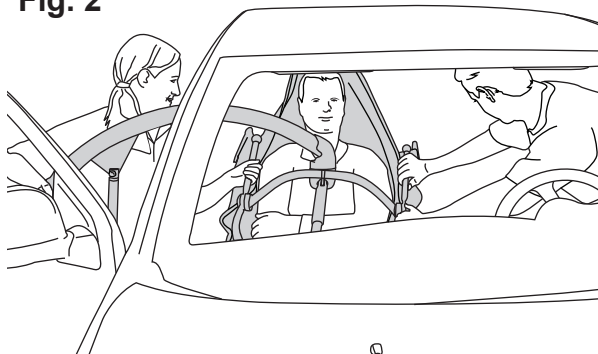

5 Approach the resident with the lift, ensuring that:

- The car door is fully open.
- The lift boom has space from the car door frame.
- The spreader bar is facing the resident, with the wide part at or just below shoulder level. It should be close enough to be able to connect the leg strap clips of the sling to the frame. (See Fig. 2)
- The lift's brakes are applied.

6 Connect the leg strap clips, then tilt the frame and attach the shoulder straps. Make sure that all the clips are securely connected.

WARNING

To avoid the resident falling, make sure that sling clips are securely attached before as well as during the lifting of the resident.

Fig. 3



7 Raise the resident using the hand control, positioning them comfortably into a semi-reclined position for the transfer. Resident should not be lifted above the caregiver's eye level.

NOTE: It is recommended to perform a resident transfer from a car's front passenger seat.

8 Turn the resident to face the caregiver and make sure resident's legs/feet do not get stuck while turning. Keep them at the height of the car seat and try to prevent excessive swinging to provide resident with a feeling of added security. Release the lift's brakes. (See Fig. 3)

WARNING

To avoid resident injury, do not hit the door frame with the lift when moving them from the car.

Fig. 4

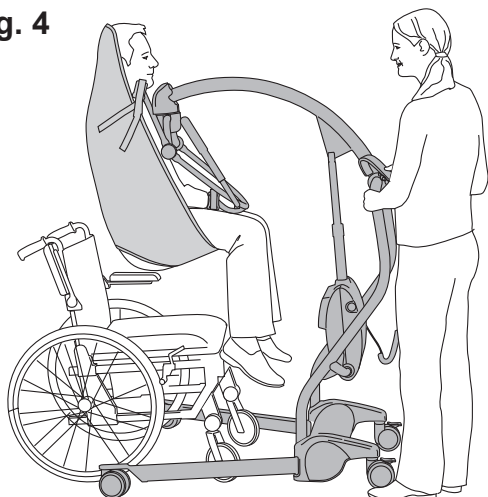

9 Proceed with the transfer.

10 Lower resident down onto a wheelchair by making small adjustments to facilitate their descent. (See Fig. 4)

11 When the resident's body weight is fully supported in the chair, detach the connections clips.

12 Move the lift away from the resident.

13 Remove the sling from under the resident.

Fig. 1



Fig. 2

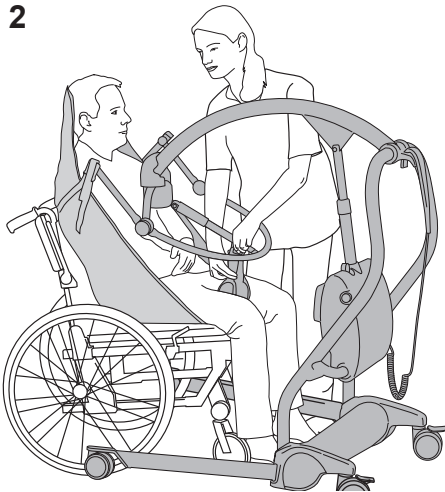

Fig. 3

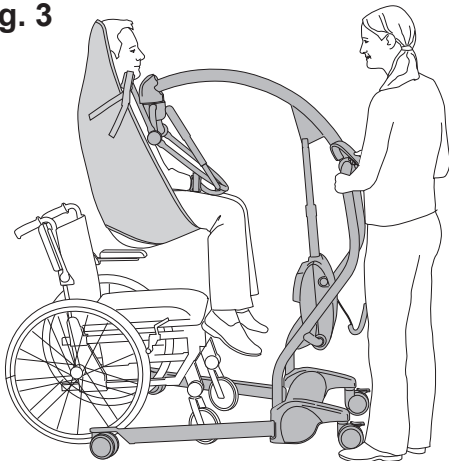
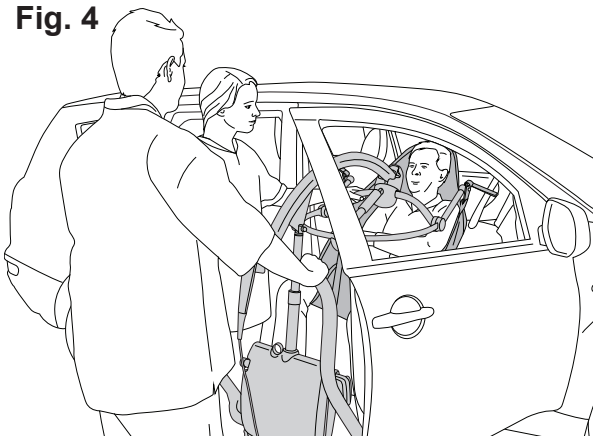

Fig. 4



Transfer Resident to Car

This procedure needs two caregivers to monitor both sides of the resident.

- 1 Apply the sling around the resident so that the base of the sling sits about one inch (2-3 cm) below the tail bone.
- 2 Ensure that the head support area of the sling is behind the head, covering and supporting it, so that it remains in place.
- 3 Pull each leg strap under resident's thigh so that it comes out on the inside of the thigh. (See Fig. 1)
- 4 Approach resident with the lift and apply the brakes.
 - The spreader bar should be in sitting position and the wide part is at or just below the resident's shoulder level.
 - The spreader bar should be close enough to connect the shoulder strap clips of the sling to the frame.
- 5 Connect the shoulder strap clips, tilt the spreader bar frame and attach the leg sections. If necessary, lower spreader bar as needed, being careful not to hit the resident. (See Fig. 2)

WARNING

To avoid the resident falling, make sure that sling clips are securely attached before as well as during the lifting of the resident.

- 6 Raise the resident using the hand control, positioning them comfortably to a semi-reclined position for the transfer. The resident should not be lifted above the caregiver's eye level.
- 7 Release the lift's brakes and turn resident to face caregiver. Keep them at eye level. Proceed with transfer. (See Fig. 3)

NOTE: Transfer resident to car's front passenger seat.

WARNING

To avoid resident injury, do not hit the door frame with the lift when moving them to the car.

- 8 Once resident has arrived, turn them toward windshield and reposition them to easily be seated in car's entry space. Make sure their legs/feet do not get stuck in the process.
- 9 Lower the resident down onto the car seat by making small adjustments during the descent so that the resident is in a comfortable position. (See Fig. 4)
- 10 When the resident's body weight is fully lowered onto the car seat, detach the connections clips.
- 11 Move the lift away from the resident.
- 12 Remove the sling from under the resident. Make sure to fasten their seat belt.

Home Care Use

For Distributors and Renters

When transporting the *Maxi Twin Compact* lift to the customer with a van:

- Make sure the lift is properly secured during transport.
- Avoid manoeuvring the lift in dirty ground when transporting it to and from the van.

When delivering the *Maxi Twin Compact* lift make sure that:

- You read this *IFU* together with the receiver (including relatives and caregivers).
- Show the features and intended usage described in the *IFU* with help of the real product.
- The user has understood the cleaning and disinfection instructions.
- Read all the warnings to the receiver.
- The environment fulfils all the requirements described in this *IFU*.

Cleaning and disinfection:

- Make sure that the cleaning and disinfection procedure described in this *IFU* always is carried out before the product reaches a new user.
- Make sure that the cleaning and disinfection procedure described in this *IFU* always is carried out before and after any type of service procedure.

Using Maxi Twin Compact Lift

Before using the *Maxi Twin Compact* lift in home environment make sure that: (See Fig. 1, 2 and 3)

WARNING

To avoid the device from tipping and the resident from falling, do not use the equipment on floor with recessed drains, holes or slopes exceeding a ratio of 1:50 (1.15°).

- All caregivers, including relatives, have read and understood the instructions in this *IFU*.
- All carpets and rugs in the environment are removed.
- All thresholds in the environment are removed.
- All stairs and edges have a fence and safety gate to prevent the lift from rolling down.
- There is room enough in the environment for use of the lift.

During Storage of the *Maxi Twin Compact* lift make sure that:

WARNING

To avoid strangulation, make sure to never leave children unattended near the equipment.

- No children can access the lift.
- No pets can come in contact with the lift.
- The storage environment fulfils the requirements specified under *Technical Specifications* in this *IFU*.

Fig. 1

Transfer between bed and wheelchair with a sling lift

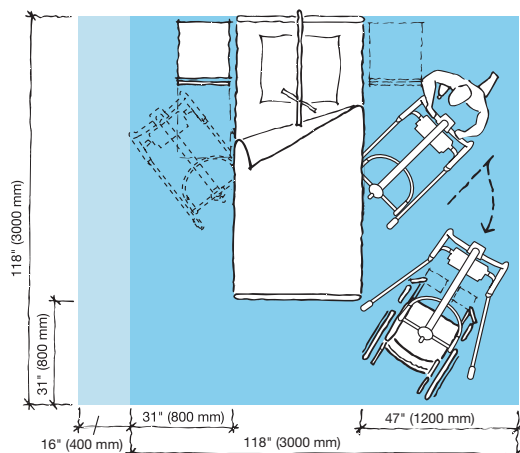

Fig. 2

Toileting with a sling lift

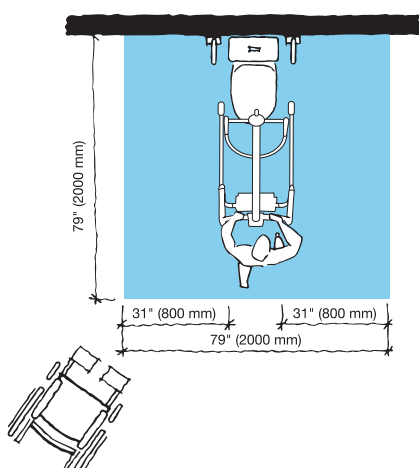
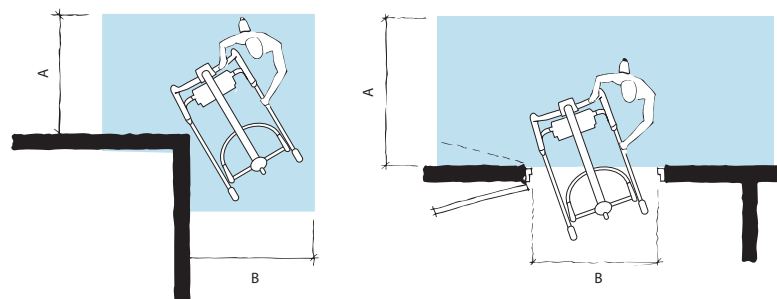
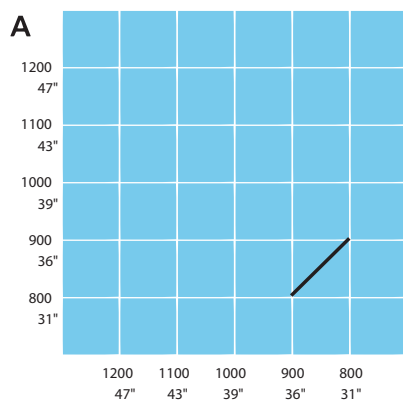

Fig. 3

Turning radius with a sling lift



Battery Instructions

WARNING

To avoid bodily injury, do NOT crush, puncture, open, dismantle or otherwise mechanically interfere with the battery.

- **Should the battery casing crack and cause contents to come in contact with skin or clothing, rinse immediately with plenty of water.**
- **If contents come in contact with the eyes, rinse immediately with plenty of water and seek medical attention.**

Inhalation of the contents can cause respiratory irritation. Provide fresh air and medical attention.

- Be careful not to drop the battery.
- Contact the appropriate local authority for advice when disposing of batteries.
- Check label on the battery.

Storage of Batteries

- The battery is delivered charged but we recommend you recharge the battery when received due to a slow self discharge.
- This battery will slowly self discharge when not used.
- A battery not in use should be stored in a temperature range of -0 °C (32 °F) to + 30 °C (86 °F).
- For maximum battery performance do not store the battery above 50 °C (122 °F).

Charging Intervals

- To prolong the life of the battery, charge it at regular intervals, i.e. every night.
- If the *Maxi Twin Compact* lift is used frequently, it is recommended to use two batteries, one in operation and one as a stand-by in the charger.
- It's recommended that a battery not in use is left in the charger. There is no risk of overcharging the battery.

Battery Service Life

Make sure to always have two well functional batteries, one to use and one in storage.

If using a freshly charged battery and the battery indicator starts to flash and sound after only a few activities are carried out, it is time to order a new battery.

Low Charge Warning

A buzzer sound will go off when the battery reaches a low charge. The battery should then be recharged as soon as possible.

Installation of Charger

See *Battery Charger IFU*.

How to Charge the Battery

See *Battery Charger IFU*.

Cleaning and Disinfecting Instructions

If you have any questions regarding disinfecting the *Maxi Twin Compact* lift, or wish to order disinfectant fluid, contact Arjo Customer Service.

Make sure to have the Material Safety Data Sheets (MSDS) available for the disinfectant being used.

WARNING



To avoid eye and skin damage, always use protective glasses and gloves. If contact occurs rinse with plenty of water. If eyes or skin becomes irritated, contact a physician. Always read the material safety data sheet of the disinfectant.

WARNING

To prevent cross-contamination, always follow the disinfection instructions in this *Instructions for Use*.

WARNING

To avoid eye or skin irritation, never disinfect in the presence of a resident.

CAUTION

To avoid damage on the equipment only use Arjo branded disinfectants.

CAUTION

Do not over spray areas of the product which could cause problems with electrical components and/or internal corrosion.

Accessories for Disinfecting the Maxi Twin Compact lift

- Protective gloves
 - Protective glasses
 - Spray bottle with water
 - Spray bottle with mild detergent
 - Spray bottle with disinfectant
- Use one of the compatible disinfectants:
- Alcohol isopropyl $\leq 70\%$
 - Bleach $\leq 1\%$ (10,000 ppm)
 - Hydrogen peroxide $\leq 1.5\%$
 - Peracetic acid $\leq 0.25\%$ (2,500 ppm)
 - Phenolic $\leq 1.56\%$ (15,600 ppm)
 - Quaternary ammonium $\leq 0.28\%$ (2,800 ppm)
- Cloth - wet and dry
 - Disposable towels
 - Soft bristled brush

Always Follow these 17 Steps for Proper Cleaning and Disinfection.

If Arjo shower panels are used, see respective *IFU*.

Removing visual residue (Step 1-3 of 17)

- 1 Remove parts such as slings, cushions and suspension straps (if applicable).
- 2 Clean the *Maxi Twin Compact* lift from visible residue using a cloth soaked in water or spray with water and wipe with a clean cloth. Start from top and move downwards.
- 3 Clean the removed parts from visible residue with a cloth soaked in water or spray with water and wipe with a clean cloth (if applicable).

Cleaning (Step 4-9 of 17)

- 4 Put on protective gloves and eye wear.
- 5 Spray mild detergent on the *Maxi Twin Compact* lift. Use a brush or a cloth if need for cleaning (to remove any deposits).
- 6 Use a new wet cloth to wipe off all traces of mild detergent on the *Maxi Twin Compact* lift or if more suitable, spray with water and wipe with a clean cloth.
- 7 Spray mild detergent on the removed parts (if applicable). If needed, use a brush or a cloth soaked in mild detergent for cleaning (to remove any deposits).
- 8 Use a new cloth soaked in water to remove all traces of mild detergent on the removed parts or spray water and wipe with a clean cloth (if applicable).
- 9 Repeat until all of the mild detergent has been removed.

Disinfection (Step 10-17 of 17)

- 10 Spray disinfectant on the *Maxi Twin Compact* lift.

NOTE

If equipped on the device, the low castors might become slightly grimy after repeated contact with bleach and/or hydrogen peroxide.

NOTE

The actuators might discolor after repeated contact with peracetic acid.

- 11 Allow a disinfection time according to the instructions on the disinfectant bottle label.
- 12 Spray disinfectant on the removed parts.
- 13 Allow a disinfection time according to the instructions on the disinfectant bottle label.
- 14 Use a new wet cloth to wipe off all traces of disinfectant on the equipment or if more suitable by spraying water and wipe with a clean cloth.
- 15 Use a new wet cloth to wipe off all traces of disinfectant on the removed parts or if more suitable by spraying water and wipe with a clean cloth.
- 16 If disinfectant cannot be removed, spray water on the affected part and wipe off with disposable towels. Repeat until all of the disinfectant has been removed.
- 17 Let all parts dry.

Care and Preventative Maintenance

The *Maxi Twin Compact* lift is subject to wear and tear, and the following actions must be performed when specified to make sure that the product remains within its original manufacturing specification.

WARNING

To avoid malfunction resulting in injury, make sure to conduct regular inspections and follow the recommended maintenance schedule. In some cases due to heavy use of the product and exposure to aggressive environment more frequent inspections should be carried out. Local regulations and standards may be more stringent than the recommended maintenance schedule.

NOTE

Product cannot be maintained and serviced while in use with the patient

PREVENTIVE MAINTENANCE SCHEDULE: Maxi Twin Compact lift

CAREGIVER OBLIGATIONS Action/Check	Every DAY	Every WEEK
Disinfect	X	
Visually check the slings	X	
Replace with charged battery	X	
Visually check all exposed parts		X
Visually check mechanical attachments		X
Check hand control and cable		X
Check and clean castors		X
Check the brake function		X
Visually check battery charger and battery		X
Perform functionality test		X

WARNING

To avoid injury to both resident and caregiver, never modify the equipment or use incompatible parts.

Fig. 1

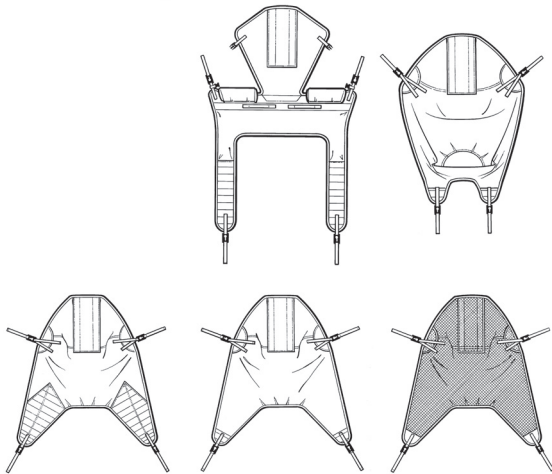

Caregiver Obligations

Caregiver obligations shall be carried out by personnel with sufficient the *Maxi Twin Compact* lift knowledge and by following the instructions in this *IFU*.

Every day

- **Disinfect:**
The *Maxi Twin Compact* lift has to be disinfected immediately after use. Arjo cleaning agents should be used in **recommended concentrations**. See section *Cleaning and Disinfecting Instructions* on page 31.
- **Visually check the slings:**
Check for fraying, holes, cuts, loose stitching and damaged plastic clips. If the sling is found damaged in any way, take out of use immediately and replace the sling. (See Fig. 1)
- **Use a fully charged battery** at the beginning of the day.

Every week

- **Visually check all exposed parts:**
Visually check all exposed parts, especially where personal contact is made by either the resident or caregiver. Make sure no cracks or sharp edges have developed that could cause the resident or user injury or that has become unhygienic. Replace damaged parts.
- **Visually check that:**
the soft cover (A) is in place and without damage. Visually check the attachment for the actuators (B) and the attachment between jib and spreader bar (C). Visually check the sling attachment knobs (D), for damage. Check the spreader bar pivot for any suspect damage, for instance, such as protruding plastic (E). (See Fig. 2)

Continue with the steps on the next page.

Fig. 2

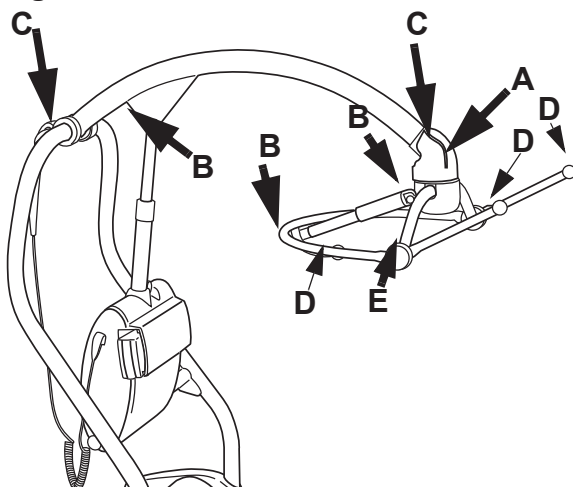
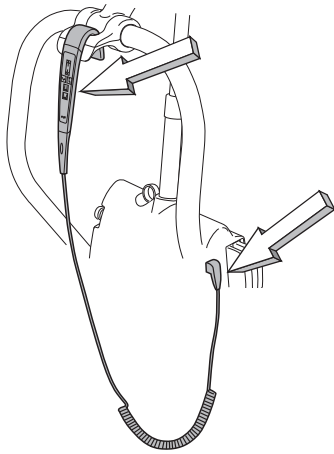
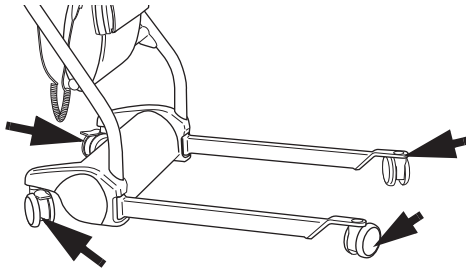

Fig. 3



- **Check hand control and cable:**
Visually check the condition of the hand control and its cable. If found cut, damaged or exposed wiring, replace it. (See Fig. 3)

Fig. 4



- **Check that the castors are properly fixed and that they roll and swivel freely.**
Clean with water. (the function can be affected by soap, hair, dust and chemicals from floor cleaning). Check the brake function. (See Fig. 4)

Fig. 5

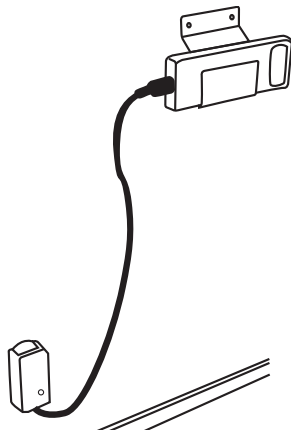

- **Visually check the condition of the battery charger, its cable and the batteries.**
Remove and replace immediately if damaged. (See Fig. 5)
- **Carry out a full functionality test and by lifting up and down.**
Test the movement of the spreader bar and the open/close function of the legs. All functions should work as expected without divergences.

Yearly

- The *Maxi Twin Compact* lift has to be serviced according to the table *QUALIFIED PERSONNEL Action/Check on page 36*.

WARNING

To avoid injury and/or unsafe product, the maintenance activities must be carried out at the correct frequency by qualified personnel using correct tools, parts and knowledge of procedure. Qualified personnel must have documented training in maintenance of this device.

QUALIFIED PERSONNEL Action/Check	Every YEAR
Check that the latest upgrades have been implemented	X
Check all vital parts for corrosion and damage	X
Check mechanical attachments	X
Perform a safe working load test (local requirements)	X
Check all actuators for function and range	X
Check movable parts of the spreader bar	X
Check function of emergency lowering	X
Check function of emergency stop	X
Check the safety stop function	X
Check/replace castors	X
Check battery	X
Perform full feature functionality test	X

NOTE

All Caregiver Obligations are to be checked when performing the Qualified Personnel Service.

Troubleshooting

PROBLEM	ACTION
The lift raises or lowers after the hand control buttons are released.	Activate the red emergency stop button and pull the battery out, remove the resident from the lift and contact qualified personnel.
The lift does not raise or descend when the hand control buttons are pressed.	<ol style="list-style-type: none"> 1 Make sure that the battery is fully connected in the battery compartment. 2 Make sure that the hand control connection plug is properly connected to the socket. 3 Make sure that the battery is charged. <div style="border: 1px solid black; padding: 5px; margin: 10px 0;"> <p>WARNING To avoid injury, make sure that the resident is not left unattended at any time.</p> </div> <ol style="list-style-type: none"> 4 Make sure the emergency stop button is inactivated by turning the red knob clockwise. 5 Use the emergency lowering to lower the resident. Pull the purple ring up to operate. When the ring is released the movement will stop - remove the resident from the lift and contact qualified personnel.
The lift is hard to manoeuvre during transfer.	<ol style="list-style-type: none"> 1 Make sure all brakes are released. 2 Make sure all castors roll and swivel freely - if not, remove the resident from the lift and contact qualified personnel.
The lift is making abnormal sounds during lifting or transfer.	Remove the resident from the lift and contact qualified personnel.
It is only possible to lower the lift.	The lifting device of this equipment is equipped with a safety nut. If the safety nut will be activated it will only be possible to lower the equipment into a safe position. In case of this scenario stop using the equipment and contact qualified personnel for repair of the equipment.

ALARMS	ACTION
A buzzing is heard as the lift is raised.	<p>The battery needs charging - complete the transfer operation in progress and change to a fully charged battery.</p> <div style="border: 1px solid black; padding: 5px; margin: 10px 0;"> <p>WARNING To avoid injury, make sure that the resident is not left unattended at any time.</p> </div>
The lift stops its motion as the lift is lowered/raised or when the spreader bar is moved to a sitting position.	The lift has been lowered/raised against a fixed object. Carefully raise/lower and reposition the lift.
Only a few activities are carried out before the battery indicator will flash and sound.	Replace the battery with a fully charged one. If using a freshly charged battery and the battery indicator starts to flash and sound after only a few activities are carried out, it is time to order a new battery.

Technical Specifications

Maxi Twin Compact lift	
Safe working load (SWL) (Max patient weight regardless of spreader bar)	160 kg (350 lbs.)
Colour	Grey
Medical equipment	type BF 
Sound level	49 dB (A)
Mode of operation	ED maximum 10%; Maximum 2 minutes ON; Minimum 18 minutes OFF
Operating forces of controls	2.7 N
Degree of fire protection	In accordance with standard EN 60601-1.
Pollution degree	2

Component weights	
<i>Maxi Twin Compact</i> lift (no scale, hanger bar or battery)	46.5 kg (101 lbs.)
Maximum total weight of lift (Lift and Patient)	208 kg (453 lbs.)
Battery Pack	1.3 kg (2.9 lbs.)

Allowed combinations	
The <i>Maxi Twin Compact</i> lift can be used with the following Arjo products: No other combinations are allowed.	Hanger Bar, Power DPS Medium Sizes: S/M/L/XL

Operation, transport and storage	
Ambient temperature range	Operation +10 °C to +40 °C (+ 50 °F to 104 °F) Transport and Storage -20 °C to +70 °C (-4 °F to +158 °F)
Relative humidity range	30% - 75% Operation 10% - 80% Transport and Storage
Atmospheric pressure range	800 - 1060 hPa Operation 500 - 1100 hPa Transport and Storage

Electricity	
Battery	Arjo NEA 0100
Battery Charger	Type no: NEA 8000
Equipment voltage	24 V DC
Protection class	IP 24 IP: Ingress Protection 2: Protection against insertion of fingers or similar objects. 4: Water splashing against the product from any direction does not effect safety or essential performance
Hand control Protection class	IP X7 IP: Ingress Protection X: The protection against contact and ingress of objects is not specified for this product. 7: Immersion up to 1 m of the product does not effect safety or essential performance
Fuse	F1 F10AL 250 V F2 T4AL 250V

Recycling	
Package	Wood and corrugated cardboard, recyclable

End of Life	
<ul style="list-style-type: none"> • All batteries in the product must be recycled separately. Batteries are to be disposed in accordance with national or local regulations. • Slings including stiffeners/stabilizers, padding material, any other textiles or polymers or plastic materials etc. should be sorted as combustible waste. • Lift systems having electrical and electronic components or an electrical cord should be disassembled and recycled per Waste of Electrical and Electronic Equipment (WEEE) or in accordance with local or national regulation. • Components that are primarily made up of different kinds of metal (containing more than 90% metal by weight) for example sling bars, rails, upright supports, etc., should be recycled as metals. 	



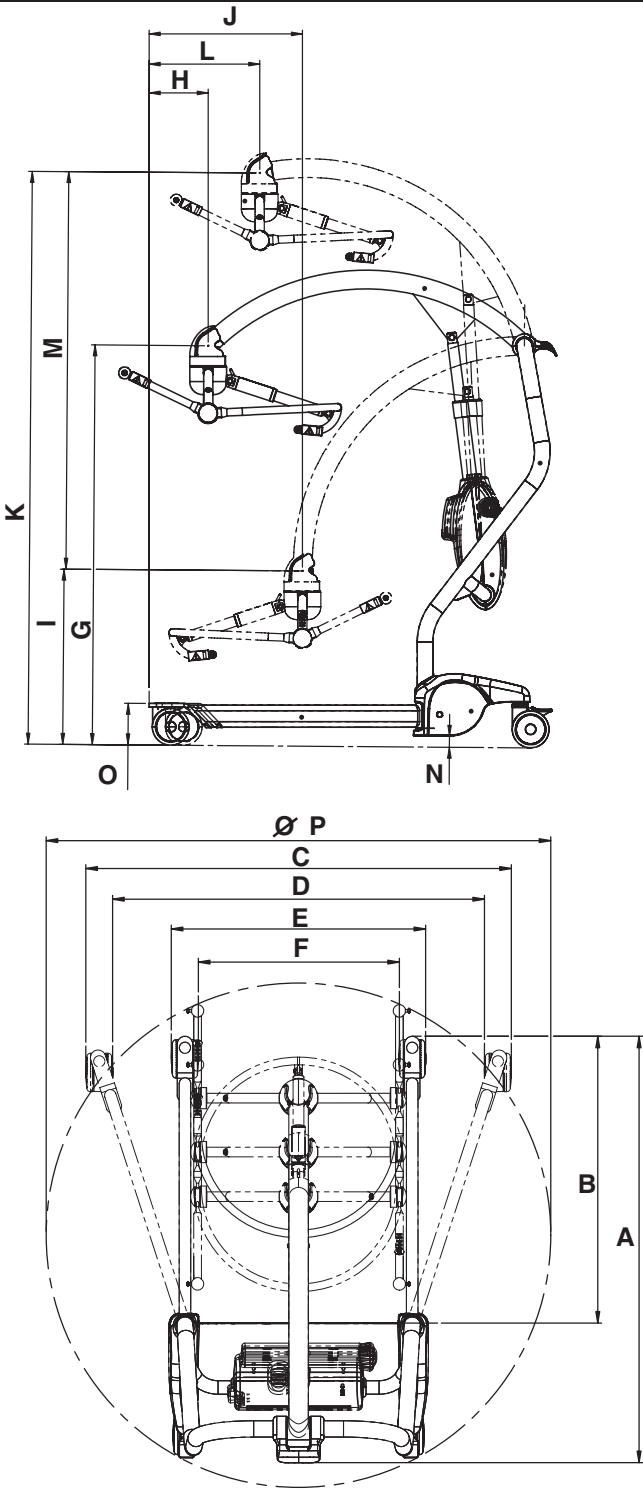

Dimensions





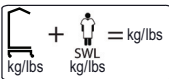
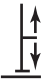
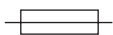



Reference	Note	Dimension mm	Dimension inch
A	Max. External Length	1110	43 5/8
B	Max. Internal Length	745	29 3/8
C	Max. External Width	1105	43 1/2
D	Max. Internal Width	965	38
E	Min. External Width	660	26
F	Min. Internal Width	520	20 1/2
G	Height of C.S.P at Max Hoisting Reach	1090	42 3/4
H	Max. Hoisting Reach	860	33 7/8
I	Min. Height of C.S.P	480	18 3/4
J	Hoisting Reach at Min. Height of C.S.P	600	23 5/8
K	Max Height of C.S.P	1560	61 1/4
L	Hoisting Reach at Max. Height of C.S.P	720	28 1/2
M	Hoisting Range	1080	42 1/2
N	Min. Clearance	30	1 1/8
O	Max. Height	115	4 1/2
P	Turning Diameter	1310	5 1/8

Labels on Maxi Twin Compact Lift

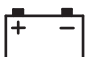
On the data label you will find the following information:

	Warning
SWL	Safe Working Load
	Total mass of equipment including its safe working load.
	Lifting stroke
24V DC	Supply voltage
MAX: 200 VA	Maximum power
	Fuse F1 – F10AL 250V Fuse F2 T4AL 250V
IP 24	Degree of protection (i.e. the product is protected against insertion of fingers and splashing water)
	Type BF Applied part: protection against electrical shock in accordance with EN/IEC 60601-1.
2 min on/ 18 min off	Mode of operation for Hi/Lo function: Maximum 2 minutes ON; Minimum 18 minutes OFF
NEA0100-083 24Vdc 2.5 Ah	Product no and data of the battery
	Read the <i>IFU</i> before use
	Separate electrical and electronic components for recycling in accordance with the European Directive 2012/19/EU (WEEE)
	CE marking indicating conformity with European Community harmonised legislation

	Indicates the product is a Medical Device according to EU Medical Device Regulation 2017/745
	TÜV marking. The lift has been safety tested in accordance with the Approvals and List of Standards.
	A battery is the power source of this equipment.
	Environmental danger. Not for disposal
	Recyclable
	Unique device identifier.

Identification Label

The identification label states the type of equipment and serial number (see figure).

Sling Range Label

Fitted to the spreader bar frame for quick colour reference to size and safe working load.

Attention Label

On the spreader bar frame to indicate “not for use in bath or shower”.

Clips Instructions Labels

Labels placed by the knobs where the clips should be connected and on the spreader bar actuator.

Battery Indicator Label

Positioned on the battery housing to indicate when the battery needs charging.

Emergency Lowering Label

Positioned near the control of emergency lowering.

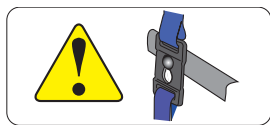
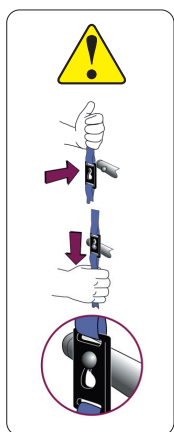

Clips instructions labels



Attention label



Sling range label



Emergency lowering label



Battery indicator label

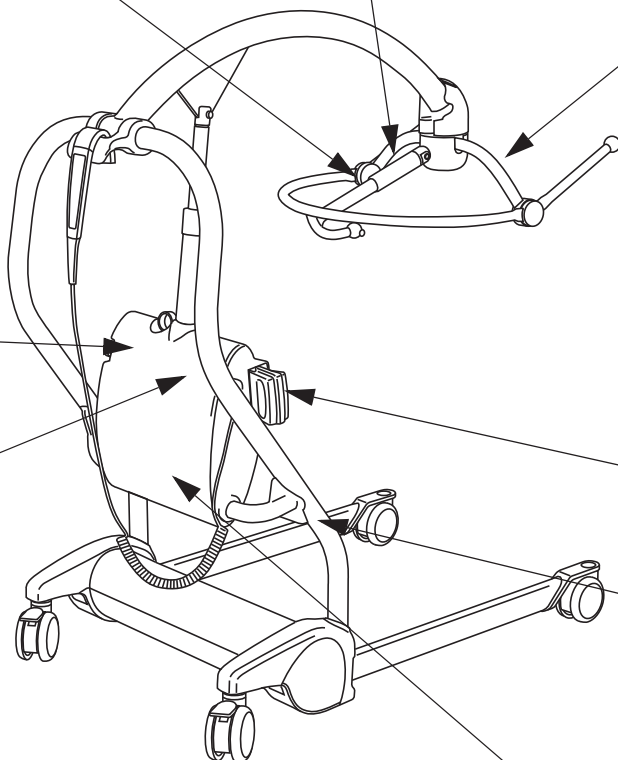

Battery Label

Data label

Identification Label

UK Symbol explanation

This section is only applicable to United Kingdom (UK) market when UK marking is applied to the Arjo medical device labelling.



UK marking indicating conformity with UK Medical Devices Regulations 2002 (SI 2002 No 618, as amended)

UK Responsible Person & UK Importer:

Arjo (UK) Ltd, ArjoHuntleigh House, Houghton Regis. LU5 5XF

Is the appointed UK Responsible Person as defined in UK Medical Devices Regulations 2002 (SI 2002 No 618, as amended).

For Northern Ireland (NI) CE marking will still apply until further amendment to applicable regulations.

Electromagnetic Compatibility

Product has been tested for compliance with current regulatory standards regarding its capacity to block EMI (electromagnetic interference) from external sources.

Some procedures can help reduce electromagnetic interferences:

- Use only Arjo cables and spare parts to avoid increased emissions or decreased immunity which can compromise the correct functioning of the equipment.
- Ensure that other devices in patient-monitoring and/or life-support areas comply to accepted emissions standards.

WARNING

Wireless communications equipment such as wireless computer network devices, mobile phones, cordless telephones and their base stations, walkie-talkies, etc. can affect this equipment and should be kept at least 1.5m away from the equipment.

Intended Environment: Home Healthcare Environment and Professional Healthcare facility environment

Exceptions: HF Surgical Equipment and the RF Shielded room of an ME SYSTEM for magnetic resonance imaging

WARNING

Use of this equipment adjacent to or stacked with other equipment should be avoided because it could result in improper operation. If such use is necessary, this equipment and the other equipment should be observed to verify that they are operating normally.

Guidance and manufacturer's declaration – electromagnetic emission		
Emission test	Compliance	Guidance
RF emissions CISPR 11	Group 1	This equipment uses RF energy only for its internal functions. Therefore its RF emissions are very low and are not likely to cause any interference in nearby electronic equipment.
RF emissions CISPR 11	Class B	This equipment is suitable for use in all establishments, including domestic establishments and those directly connected to the public low voltage power supply network that supplies buildings used for domestic purposes.

Guidance and manufacturer's declaration – electromagnetic immunity			
Immunity test	IEC 60601-1-2 test level	Compliance level	Electromagnetic environment – guidance
Electrostatic discharge (ESD) EN 61000-4-2	±2kV, ±4kV, ±8kV, ±15kV air ±8kV contact	±2kV, ±4kV, ±8kV, ±15kV air ±8kV contact	Floors should be wood, concrete or ceramic tile. If floors are covered with synthetic material the relative humidity level should be at least 30%
Conducted disturbances induced by RF fields EN 61000-4-6	3V in 0,15 MHz to 80 MHz 6V in ISM and amateur radio bands between 0,15 MHz and 80 MHz 80% AM at 1 kHz	3V in 0,15 MHz to 80 MHz 6V in ISM and amateur radio bands between 0,15 MHz and 80 MHz 80% AM at 1 kHz	Portable and mobile RF communications equipment should be used no closer to any part of the product, including cables, than 1.0m, if the transmitter's output power rating exceeds 1W ^a . Field strengths from fixed RF transmitters, as determined by an electromagnetic site survey, should be less than the compliance level in each frequency range ^b . Interference may occur in the vicinity of equipment marked with this symbol: 
Radiated RF electromagnetic field EN 61000-4-3	Home Healthcare environment 10 V/m 80 MHz to 2,7 GHz 80% AM at 1 kHz	Home Healthcare environment 10 V/m 80 MHz to 2,7 GHz 80% AM at 1 kHz	
Proximity fields from RF wireless communications equipment EN 61000-4-3	385 MHz - 27 V/m 450 MHz - 28 V/m 710, 745, 780 MHz - 9V/m 810, 870, 930 MHz - 28 V/m 1720, 1845, 1970, 2450 MHz – 28 V/m 5240,5500, 5785 MHz - 9V/m	385 MHz - 27 V/m 450 MHz - 28 V/m 710, 745, 780 MHz - 9V/m 810, 870, 930 MHz - 28 V/m 1720, 1845, 1970, 2450 MHz - 28 V/m 5240,5500, 5785 MHz - 9V/m	
Electrical fast transient/burst EN 61000-4-4	±1kV SIP/SOP ports 100 kHz repetition frequency	±1kV SIP/SOP ports 100 kHz repetition frequency	
Power frequency Magnetic field EN 61000-4-8	30 A/m 50 Hz or 60 Hz	30 A/m 50 Hz	Power frequency magnetic fields should be at levels characteristic of a typical location in a typical commercial or hospital environment.
^a Field strengths from fixed transmitters, such as base stations for radio (cellular/cordless) telephones and land mobile radios, amateur radio, AM and FM radio broadcast and TV broadcast cannot be predicted theoretically with accuracy. To assess the electromagnetic environment due to fixed RF transmitters, an electromagnetic site survey should be considered. If the measured field strength in the location in which the product is used exceeds the applicable RF compliance level above, the product should be observed to verify normal operation. If abnormal performance is observed, additional measures may be necessary. ^b Over the frequency range 150 kHz to 80 MHz, field strengths should be less than 1 V/m.			

Parts and Accessories

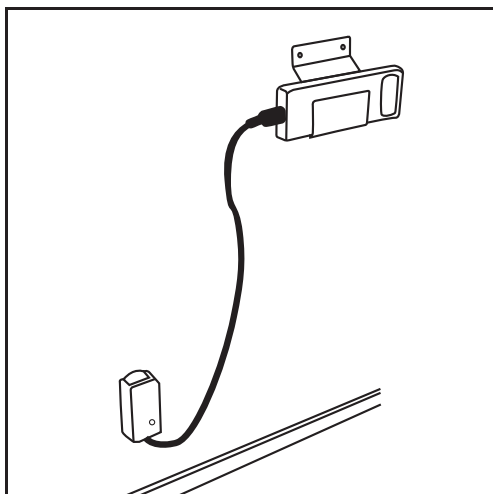

Battery and charger

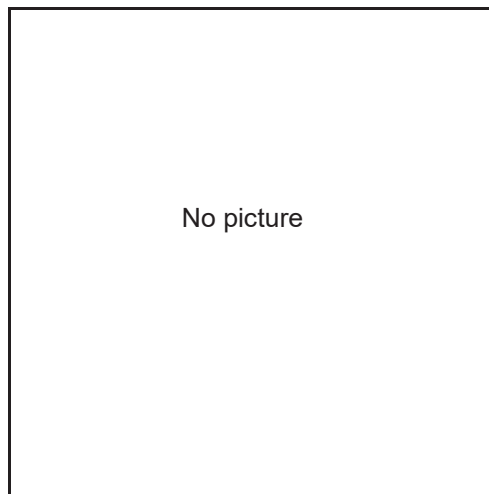

Sling
Contact your local representative.

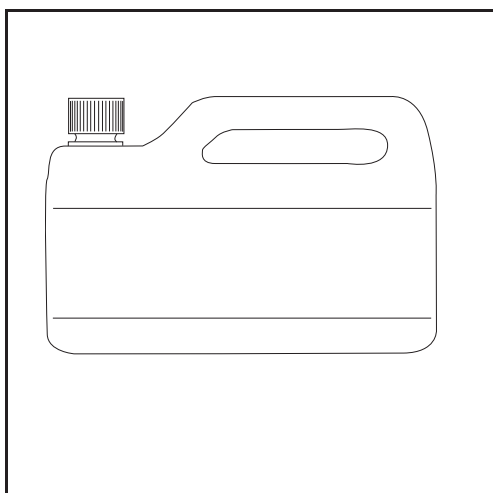

Disinfectant

AUSTRALIA

Arjo Australia
Building B, Level 3
11 Talavera Road
Macquarie Park, NSW, 2113,
Australia
Phone: 1800 072 040

BELGIQUE / BELGIË

Arjo Belgium
Evenbroekveld 16
9420 Erpe-Mere
Phone: +32 (0) 53 60 73 80
Fax: +32 (0) 53 60 73 81
E-mail: info.belgium@arjo.com

BRASIL

Arjo Brasil Equipamentos Médicos Ltda
Rua Marina Ciufuli Zanfalice, 329 PB02
Galpão - Lapa
São Paulo – SP – Brasil
CEP: 05040-000
Phone: 55-11-3588-5088
E-mail: vendas.latam@arjo.com
E-mail: servicios.latam@arjo.com

CANADA

Arjo Canada Inc.
90 Matheson Boulevard West
Suite 350
CA-MISSISSAUGA, ON, L5R 3R3
Tel/Tél: +1 (905) 238-7880
Free: +1 (800) 665-4831
Fax: +1 (905) 238-7881
E-mail: info.canada@arjo.com

ČESKÁ REPUBLIKA

Arjo Czech Republic s.r.o.
Na Strži 1702/65
140 00 Praha
Czech Republic
Phone No: +420225092307
E-mail: info.cz@arjo.com

DANMARK

Arjo A/S
Vassingerødvej 52
DK-3540 LYNGE
Tel: +45 49 13 84 86
Fax: +45 49 13 84 87
E-mail: dk_kundeservice@arjo.com

DEUTSCHLAND

Arjo GmbH
Peter-Sander-Strasse 10
DE-55252 MAINZ-KASTEL
Tel: +49 (0) 6134 186 0
Fax: +49 (0) 6134 186 160
E-mail: info-de@arjo.com

ESPAÑA

ARJO IBERIA S.L.
Poligono Can Salvatella
c/ Cabanyes 1-7
08210 Barberà del Valles
Barcelona - Spain
Telefono 1: +34 900 921 850
Telefono 2: +34 931 315 999

FRANCE

Arjo SAS
2 Avenue Alcide de Gasperi
CS 70133
FR-59436 RONCQ CEDEX
Tél: +33 (0) 3 20 28 13 13
Fax: +33 (0) 3 20 28 13 14
E-mail: info.france@arjo.com

HONG KONG

Arjo Hong Kong Limited
Room 411-414, 4/F, Manhattan Centre,
8 Kwai Cheong Road, Kwai Chung, N.T.,
HONG KONG
Tel: +852 2960 7600
Fax: +852 2960 1711

ITALIA

Arjo Italia S.p.A.
Via Giacomo Peroni 400-402
IT-00131 ROMA
Tel: +39 (0) 6 87426211
Fax: +39 (0) 6 87426222
E-mail: Italy.promo@arjo.com

MIDDLE EAST

Arjo Middle East FZ-LLC
Office 908, 9th Floor,
HQ Building, North Tower,
Dubai Science Park,
Al Barsha South
P.O. Box 11488, Dubai,
United Arab Emirates
Direct +971 487 48053
Fax +971 487 48072
Email: Info.ME@arjo.com

NEDERLAND

Arjo Nederland BV
Biezenwei 21
4004 MB TIEL
Postbus 6116
4000 HC TIEL
Tel: +31 (0) 344 64 08 00
Fax: +31 (0) 344 64 08 85
E-mail: info.nl@arjo.com

NEW ZEALAND

Arjo Ltd
34 Vestey Drive
Mount Wellington
NZ-AUCKLAND 1060
Tel: +64 (0) 9 573 5344
Free Call: 0800 000 151
Fax: +64 (0) 9 573 5384
E-mail: nz.info@arjo.com

NORGE

Arjo Norway AS
Olaf Helsets vei 5
N-0694 OSLO
Tel: +47 22 08 00 50
Faks: +47 22 08 00 51
E-mail: no.kundeservice@arjo.com

ÖSTERREICH

Arjo Austria GmbH
Lemböckgasse 49 / Stiege A / 4.OG
A-1230 Wien
Tel: +43 1 8 66 56
Fax: +43 1 866 56 7000

POLSKA

Arjo Polska Sp. z o.o.
ul. Ks Piotra Wawrzyniaka 2
PL-62-052 KOMORNIKI (Poznań)
Tel: +48 61 662 15 50
Fax: +48 61 662 15 90
E-mail: arjo@arjo.com

PORTUGAL

Arjo em Portugal
MAQUET Portugal, Lda.
(Distribuidor Exclusivo)
Rua Poeta Bocage n.º 2 - 2G
PT-1600-233 Lisboa
Tel: +351 214 189 815
Fax: +351 214 177 413
E-mail: Portugal@arjo.com

SUISSE / SCHWEIZ

Arjo Switzerland AG
Fabrikstrasse 8
Postfach
CH-4614 HÄGENDORF
Tél/Tel: +41 (0) 61 337 97 77
Fax: +41 (0) 61 311 97 42

SUOMI

Arjo Scandinavia AB
Riihitontuntie 7 C
02200 Espoo
Finland
Puh: +358 9 6824 1260
E-mail: Asiakaspalvelu.finland@arjo.com

SVERIGE

Arjo International HQ
Hans Michelsensgatan 10
SE-211 20 MALMÖ
Tel: +46 (0) 10 494 7760
Fax: +46 (0) 10 494 7761
E-mail: kundservice@arjo.com

UNITED KINGDOM

Arjo UK and Ireland
Houghton Hall Park
Houghton Regis
UK-DUNSTABLE LU5 5XF
Tel: +44 (0) 1582 745 700
Fax: +44 (0) 1582 745 745
E-mail: sales.admin@arjo.com

USA

Arjo Inc.
2349 W Lake Street Suite 250
US-Addison, IL 60101
Tel: +1 (630) 307-2756
Free: +1 (800) 323-1245
Fax: +1 (630) 307 6195
E-mail: us.info@arjo.com

JAPAN

Arjo Japan K.K.
東京都港区虎ノ門三丁目7番8号
ランディック第2 虎ノ門ビル9 階
Tel: +81 (0)3-6435-6401
Fax: +81 (0)3-6435-6402
E-mail: info.japan@arjo.com

At Arjo, we are committed to improving the everyday lives of people affected by reduced mobility and age-related health challenges. With products and solutions that ensure ergonomic patient handling, personal hygiene, disinfection, diagnostics, and the effective prevention of pressure ulcers and venous thromboembolism, we help professionals across care environments to continually raise the standard of safe and dignified care. Everything we do, we do with people in mind.



ArjoHuntleigh AB
Hans Michelsensgatan 10
211 20 Malmö, Sweden
www.arjo.com

arjo

