

Flowtron ACS900

Compliance Monitoring

Compliance Monitoring; records and displays actual therapy as well as non-compliant time. Alerts upon garment removal to facilitate tracking and documentation of IPC therapy.

Enable/Disable Compliance Monitoring

1. Configure Compliance Monitoring:
 - Make sure no garments are connected to the pump.
 - Press and hold the middle control button to access the setup screen.

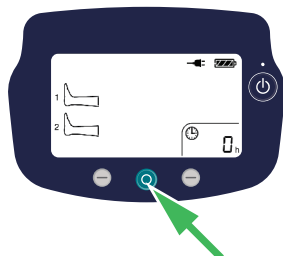

2. Press the left button to cycle through the options:
 - ON with Audible alert enabled
 - ON with Audible alert disabled
 - OFF (Pump run-hour time is displayed instead of accumulated therapy time)

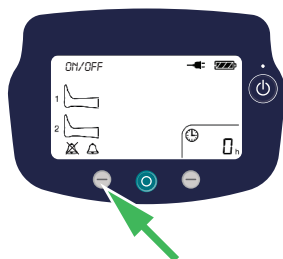

3. Press the middle control button to select the displayed option.

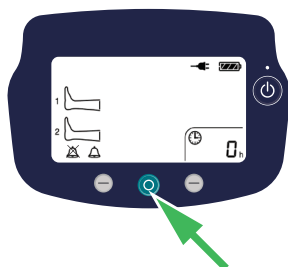

Reset the Compliance Monitoring (accumulated therapy time)

1. When the pump is in Standby, press and hold the right control button for 2 seconds. The time flashes for 2 minutes. Press and hold the middle control button for 3 seconds to reset the time to zero.
2. Press the right control button again to confirm. If the button is not pressed within two minutes, the timer will NOT be reset and will go back to show the original data.

Start therapy

1. Apply the garment to the patient.

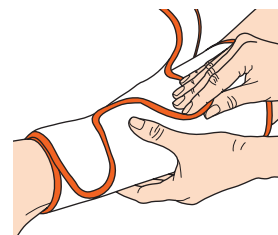

2. Connect the garment to the pump.

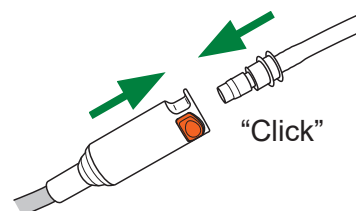

3. Press the middle control button to start therapy.

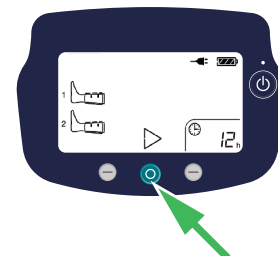

Read the display

1. During use the ACS900 monitors each inflation to make sure it is delivering prophylaxis to the patient. The accumulated therapy time is displayed in the bottom right corner.

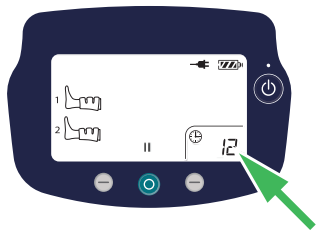

2. If the pump senses that a garment has been removed from the limb, while the pump is in run mode, the corresponding limb graphic flashes.

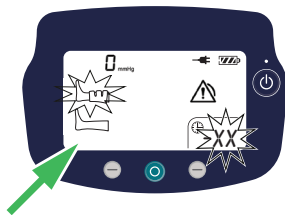

Caregivers are alerted that no prophylaxis is being delivered.

The sequence of notifications:

- The leg icon starts to flash and the non-compliance time appears on the screen.
- After 3 cycles, the warning triangle appears on the screen and the green LED starts to flash.
- After 10 minutes, the flashing green LED turns to solid yellow with an optional audible alarm.

Additionally, the pump will count and display how long therapy has not taken place (non-compliance time). This is initially displayed in flashing minutes.

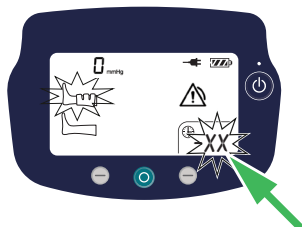

3. After 1 hour of monitored non-compliance the display switches over to show the time in flashing hours.



4. Press the right control button to see the additional minutes to the hour, a “-” is shown before minutes on the display.

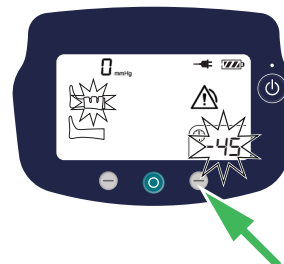

Rectify warning/alert

1. In order to clear the Compliance Monitoring warning/alert, refit any removed garments to the limb.

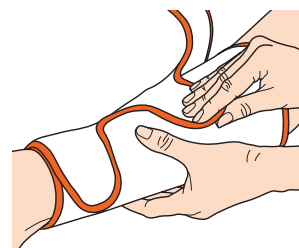

2. The non-compliance time is automatically cleared when the pump senses that the garment has been reapplied on the limb. The pump goes back to showing accumulated therapy time and continues counting from where it left off.

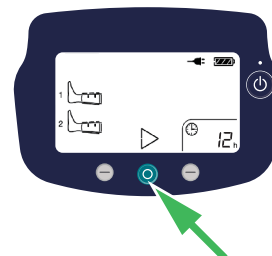

3. Alternatively, pause and then restart the pump.