

INSTRUCTIONS FOR USE

Amigo



The model name and serial number should always be provided when ordering spare parts or during queries per telephone or written correspondence:

Serial number of the machine:

.....

Machine model:

.....

WARNING

To avoid injury, always read this *Instructions for Use* and accompanied documents before using the product.



Mandatory to read the *Instructions for Use*.

Design Policy and Copyright

® and ™ are trademarks belonging to the Arjo group of companies.

© Arjo 2023.

As our policy is one of continuous improvement, we reserve the right to modify designs without prior notice. The content of this publication may not be copied either whole or in part without the consent of Arjo.

Contents

PREFACE.....	5
Definitions in this IFU	6
1 SAFETY PRECAUTIONS.....	7
1.1 Important.....	7
1.2 Isolator switch.....	8
1.3 In an emergency.....	8
2 PRESENTATION.....	9
2.1 Areas of use.....	9
2.2 The machine	9
2.2.1 Models	9
2.2.2 Components.....	10
2.2.3 Container	10
2.2.4 Cleaning principles.....	10
2.3 Control panel	11
2.3.1 Components.....	11
2.3.2 Performance Characteristics.....	12
2.4 Display options	13
2.4.1 Displayed while a program is running	13
2.4.2 Display after program end.....	13
3 DETERGENT.....	14
3.1 Using detergent	14
3.2 Flushing detergent.....	14
3.3 Positioning	14
3.4 Switching	15
4 OPERATING INSTRUCTIONS	16
4.1 Program overview.....	16
4.2 (S-608) Run a program.....	17
4.2.1 Start a program	17
4.2.2 During ongoing program	18
4.2.3 After program completion.....	18
4.3 Run a program.....	19
4.3.1 Start a program	19
4.3.2 During ongoing program	20
4.3.3 After program completion.....	20
4.4 Examples of goods and program selection.....	21
4.5 (S-608) Use pouch destroyer.....	22
4.5.1 About the pouch destroyer	22
4.5.2 Remove the upper part of the pouch insert.....	22
4.5.3 Install the upper part of the pouch insert.....	23

5	MAINTENANCE	24
5.1	Flushing chamber	24
5.2	The outside	24
5.3	(S-608) Pouch destroyer.....	25
5.3.1	Maintenance	25
5.3.2	Replacing blade	26
5.4	Preventive maintenance	27
5.4.1	Periodic maintenance	27
5.4.2	Service table	28
5.5	Machines that are not in use.....	30
6	ALARM.....	30
6.1	Alarm indication	30
6.2	Acknowledging an error message.....	30
6.3	During a power failure.....	30
7	TROUBLESHOOTING.....	31
7.1	List of codes.....	31
8	WATER QUALITY	32
8.1	Requirements	32
8.2	Main factors	32
8.3	Recommendation.....	32
8.4	Local standard	32
8.5	Local standard, typical specification	33
9	ENVIRONMENTAL PRODUCT DECLARATION	34
9.1	Comments	34
9.2	Distribution.....	34
9.3	Use	34
10	END OF LIFE DISPOSAL.....	35
11	SYMBOL EXPLANATION	36
12	ELECTROMAGNETIC COMPATIBILITY	38

PREFACE

This Instructions for use describes the design and operation of the machine and the maintenance for which the user is responsible. The Assembly and installation instructions describes the machine's installation. The technical manual describes necessary information for operators and maintenance personnel. The information in the manual must be complied with to ensure safe and error-free operation.

Users must read through the Instructions for use before using the machine for the first time, as well as familiarizing themselves with the operation of the machine and its safety instructions. Operators and maintenance personnel must have completed training through the marketing organization of Arjo.

The information in this Instructions for use describes the machine as dispatched from Arjo. There may be differences due to customization for customers or countries.

Available models:

S-607

S-608

The machine is accompanied by the following documentation:

- Instructions for use
- Assembly and installation instructions
- Quick reference guide

The following documentation shall be provided by the sales company to the end-user on request:

- Technical manual
- Spare parts list

The accompanying Quick reference guide must be hung up and clearly visible in the installation area.

Arjo reserves the right to change the specification and design without prior notice. The information in this Instruction for use was up-to-date on the date that it was issued.

Definitions in this IFU



Safety warning. Failure to understand and obey this warning may result in injury or machine damage.



Hot surface. Risk of injury.



Sharp element. Risk of injury.



Dangerous voltage. Risk of injury.

Note!

Note means: This is important information for the correct use of this system or device.

1 SAFETY PRECAUTIONS

This machine has been designed with a number of built-in safety devices.

To avoid injury, it is highly important not to bypass these safety devices.

1.1 Important

- The machine is designed for connection to water only.
- Read the Instructions for use thoroughly before use.
- The machine must only be handled by authorized personnel. Personnel must also receive regular training.
- If any part is missing or damaged - do NOT use the product.
- Exercise caution when using the machine, as it uses hot water and possibly steam.
- Exercise caution when handling the chemical agent used in the machine. Follow the manufacturers' instructions or contact the manufacturer:
 - if the agent comes into contact with the eyes or skin or if vapors are inhaled.
 - for instructions on dosage amount and washing temperatures.
 - for instructions regarding storage and sorting/disposal of packing.
- Make sure that the machine has access to agent before the process starts. This is important both for the operation of the machine and for keeping the wash chamber free from staining.
- The machine must be kept clean if it is to work properly.
- Do not wash down or hose down the machine with water.
- Installation and service work must be performed by trained personnel.
- Never bypass the machine's door switch under any circumstances.
- Leakage in the system, for example a worn door seal, must be rectified without delay.
- Spare parts must only be obtained from Arjo's sales companies.
- If a serious incident occurs in relation to this medical device, affecting the user, or the patient then the user or patient should report the serious incident to the medical device manufacturer or the distributor. In the European Union, the user should also report the serious incident to the Competent Authority in the member state where they are located.

1.2 Isolator switch

The machine must always be equipped with a separate isolator switch in the feed power supply. The isolator switch must be easily accessible on a wall close to the machine. The external electrical isolator switch must be marked “I” and “O” to identify the position of the switch.

1.3 In an emergency

- Switch off the main switch.
- Close shutoff valves in the water and (where present) steam supply lines.

2 PRESENTATION

2.1 Areas of use

Flusher-disinfector for emptying, cleaning and disinfecting, bedpans, urine bottles and other containers for human waste, including suction bottles, suction bags and urine bags.

To meet the requirements of EN ISO 15883, the items must be placed in the proper holder, recommended by Arjo.

The customer is responsible for ensuring that an Installation Qualification, Operating Qualification and Performance Qualification according to ISO 15883 are carried out before the product is put into use.

2.2 The machine

2.2.1 Models

The machine forms part of Arjo's series of flusher-disinfectors. It is available as a freestanding or wall-mounted model.

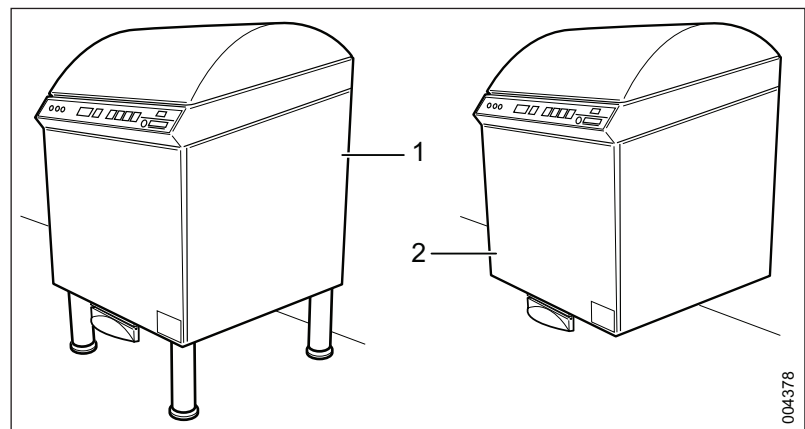

Figure 1. Models

1. Free-standing model
2. Wall-mounted model

2.2.2 Components

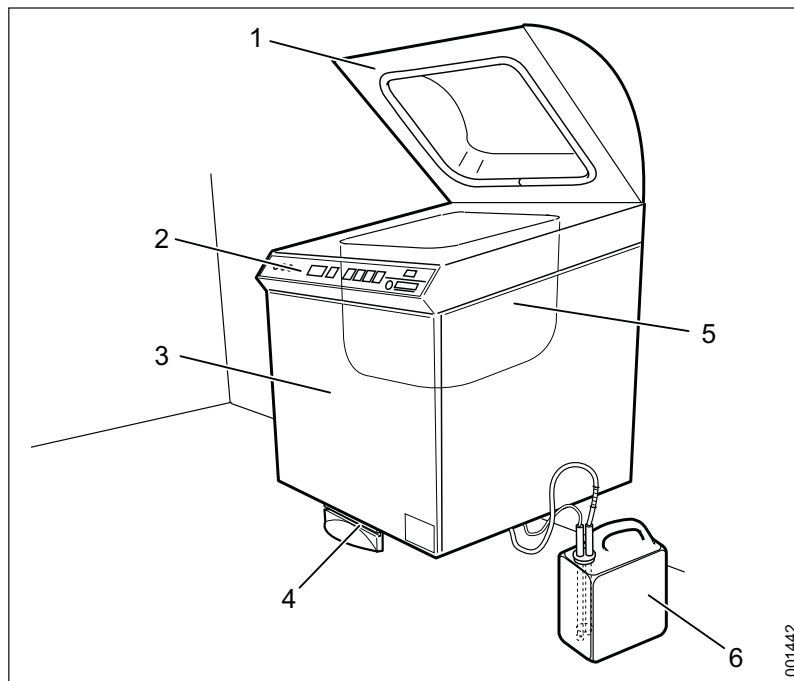

Figure 2. Machine overview

- | | |
|----------------------------|--|
| 1. Lid | 4. Foot pedal |
| 2. Control panel | 5. Flushing chamber |
| 3. Door to machine cabinet | 6. Detergent container with level sensor |

2.2.3 Container

The goods are placed in a holder in the flushing chamber. Several different models are available.

- The holder appended is the standard model.
- Other models come with separate instructions for positioning the goods.

2.2.4 Cleaning principles

The goods are cleaned by:

1. flushing with cold and hot water,
2. disinfecting with steam.
3. cooling with hot water.

2.3 Control panel

Note!

Service personnel should only be called in the event of error code F. In the case of error code U or H, the fault can be corrected by the user.

2.3.1 Components

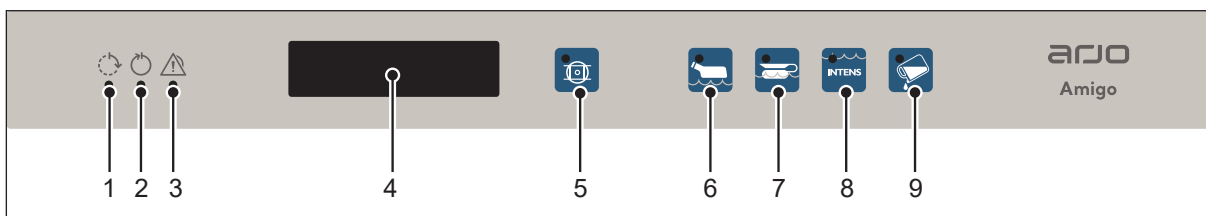











Figure 3. Control panel

- | | |
|----------------------------|---|
| 1. Yellow: Process running | 6. Economy program |
| 2. Green: Process complete | 7. Normal program |
| 3. Red: Error indication | 8. Intensive program (S-608: Pouch destroyer program) |
| 4. Display | 9. Detergent |
| 5. Rim flushing | |

2.3.2 Performance Characteristics

	Function
	Yellow flashing light: The process can be cancelled. Yellow light comes on: The machine is running a program. The display shows the current status* in the window, for example the cleaning phase and temperature.
	Green light comes on: The program is complete. The light goes off when the lid is fully opened. A program summary is shown in the display for a short period*, for example maximum temperature.
	Red light comes on: Error indication. The display shows an error message.
	Button for choosing economy program for lightly soiled goods, for example, urine bottles.
	Button for choosing normal program for normally soiled goods.
	Button for choosing intensive program for heavily soiled goods. S-608: Button for selecting pouch destroyer program.
	The button combination for program selection with detergent for general circulation goods, e.g. hospital bowls.
	The button combination for program selection with detergent for heavily soiled goods.
	Note! Without disinfection! Button to start rim flushing. Rim flushing cannot be started with the foot pedal.
	The foot pedal starts the selected program. When a program is complete and the lid is slightly open, the foot pedal opens the lid fully.

* The information displayed depends on the display options.

2.4 Display options

A service technician can set the information to be shown in the display.

2.4.1 Displayed while a program is running

The display can be set to show one of the following alternatives while a program is running:

- Temperature
- A_0 value
- A_0 value / Temperature
- Remaining Time
- Temperature / Remaining time
- A_0 value / Remaining time
- A_0 value / Remaining time / Temperature

If an alternative with more than one parameter is selected, the parameters will be displayed alternately. The A_0 value always remains at 0 until the thermal disinfection begins. When the temperature reaches 85°C, the A_0 value will increase in line with the temperature and time.

2.4.2 Display after program end

The display can be set to show one of the following alternatives once a program has finished:

- Max. temperature
- A_0 value
- A_0 value / Max temperature

If an alternative with more than one parameter is selected, the parameters will be displayed alternately.

3 DETERGENT

3.1 Using detergent



WARNING!
Using other detergents, especially acidic ones, may damage the machine (dosing pumps, steam generators and pipes).



WARNING!
Follow the instructions for the container for additional instructions on using the detergent.

The machine has been proven and tested with Arjo's detergents. We recommend that you use Arjo detergents.

3.2 Flushing detergent

Following detergents can be ordered from Arjo sales companies.

Agent	Description
■ ARJO LIQUIDS FLUSHER DETERGENT	A mild alkaline detergent to be used for automated cleaning of human waste containers.
■ ARJO LIQUIDS FLUSHER RINSE	A mild alkaline solution to be used for automated rinsing of human waste containers and system piping to prevent hard water scale build up.

3.3 Positioning

The illustration below shows some examples of how detergent can be positioned.

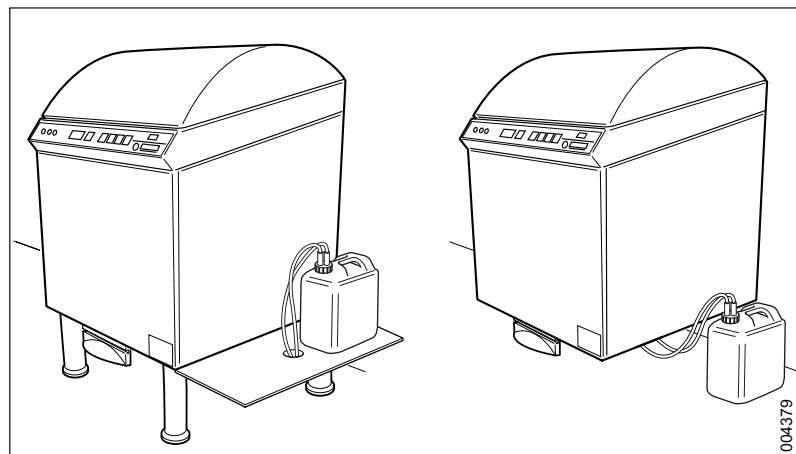

Figure 4. Example of the placement of detergent

3.4 Switching

WARNING!



To avoid eye and skin damage, always use protective glasses and gloves. If contact occurs rinse with plenty of water. If eyes or skin becomes irritated, contact a physician. Always read the material safety data sheet of the detergent.

When replacing with a new container, always check that the detergent is correctly connected. The color of the ring on the low level alarm (A) should be the same as the color on the side of the container (B).

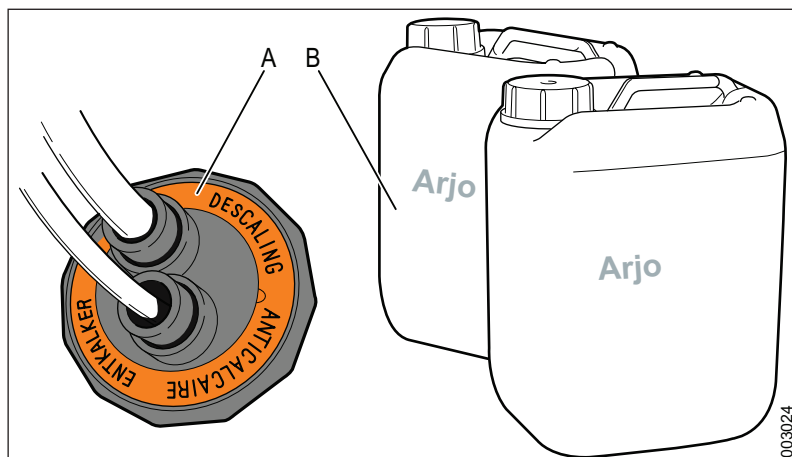

Figure 5. Checking the detergent

4 OPERATING INSTRUCTIONS



WARNING!



To prevent contamination, use personal protective equipment, such as gloves and protective glasses, when handling soiled waste containers and loading the goods into the flusher-disinfector.

4.1 Program overview

The machine's standard programs are described here. There may be other programs for the program buttons. A service technician can change the button functions.

Program	Economy	Normal	Intensive
Goods	Lightly soiled	Normally soiled	Heavily soiled
Key			
Process	Cleaning Disinfection Cooling End of program	Cleaning Disinfection Cooling End of program	Cleaning Disinfection Cooling End of program
Time	3–6 min	5–7 min	6–8 min
Energy	0.18 kWh	0.18 kWh	0.18 kWh
Water excl. cooling	18 l	29 l	36 l
Water incl. cooling	21 l	32 l	39 l

4.2 (S-608) Run a program







4.2.1 Start a program



WARNING!

If the machine has not been used for more than 72 hours, it is necessary to run a program with an empty chamber before using the machine to clean goods.

For information about the pouch destroyer, see 4.5 (S-608)
Use pouch destroyer.

1. Check the pouch insert:
 - With pouch destruction, ensure that the upper part of the pouch insert is installed.
 - When cleaning other goods, ensure that the upper part of the pouch insert is removed.
2. Positioning the goods:
 - With pouch destruction, place the pouch in the pouch destroyer.
 - When cleaning other goods, place it in the holder.
3. Select program:
 - Economy program: Press .
 - Normal program: Press .
 - Intensive program and pouch destroyer program: Press .
4. To add detergent, press .
- If detergent dosing is automatic, the detergent can instead be cancelled by pressing .
5. Press the foot pedal to start the program.
The program where the lamp on the button lights up will be started.
6. The yellow light at  will flash for 6 seconds and it is possible to cancel the program.

* A service technician can set the detergent to be inserted automatically during each program run.

4.2.2 During ongoing program



WARNING!

If the red indicator lights up an error has occurred.
The process is cancelled and must be repeated.

4.2.3 After program completion



WARNING!

The goods may be hot at the end of the program.
If the temperature of the goods is above 60°C, the
display shows U7.

1. When the program is complete:
 - The green light at  lights up.
 - The door slightly opens.
2. Open the lid fully by pressing on the foot pedal.
3. Take the goods out of the machine.

4.3 Run a program

4.3.1 Start a program



WARNING!

If the machine has not been used for more than 72 hours, it is necessary to run a program with an empty chamber before using the machine to clean goods.

1. Place the goods to be cleaned in the holder.
2. Select program:
 - Economy program: Press
 - Normal program: Press
 - Intensive program: Press
3. To add detergent, press
If detergent dosing is automatic, the detergent can instead be cancelled by pressing
4. Press the foot pedal to start the program.
The program where the lamp on the button lights up will be started.
5. The yellow light at will flash for 6 seconds and it is possible to cancel the program.

* A service technician can set the detergent to be inserted automatically during each program run.

4.3.2 During ongoing program



WARNING!

If the red indicator lights up an error has occurred.
The process is cancelled and must be repeated.

4.3.3 After program completion



WARNING!

The goods may be hot at the end of the program.
If the temperature of the goods is above 60°C, the
display shows U7.

1. When the program is complete:
 - The green light at  lights up.
 - The door slightly opens.
2. Open the lid fully by pressing on the foot pedal.
3. Take the goods out of the machine.

4.4 Examples of goods and program selection

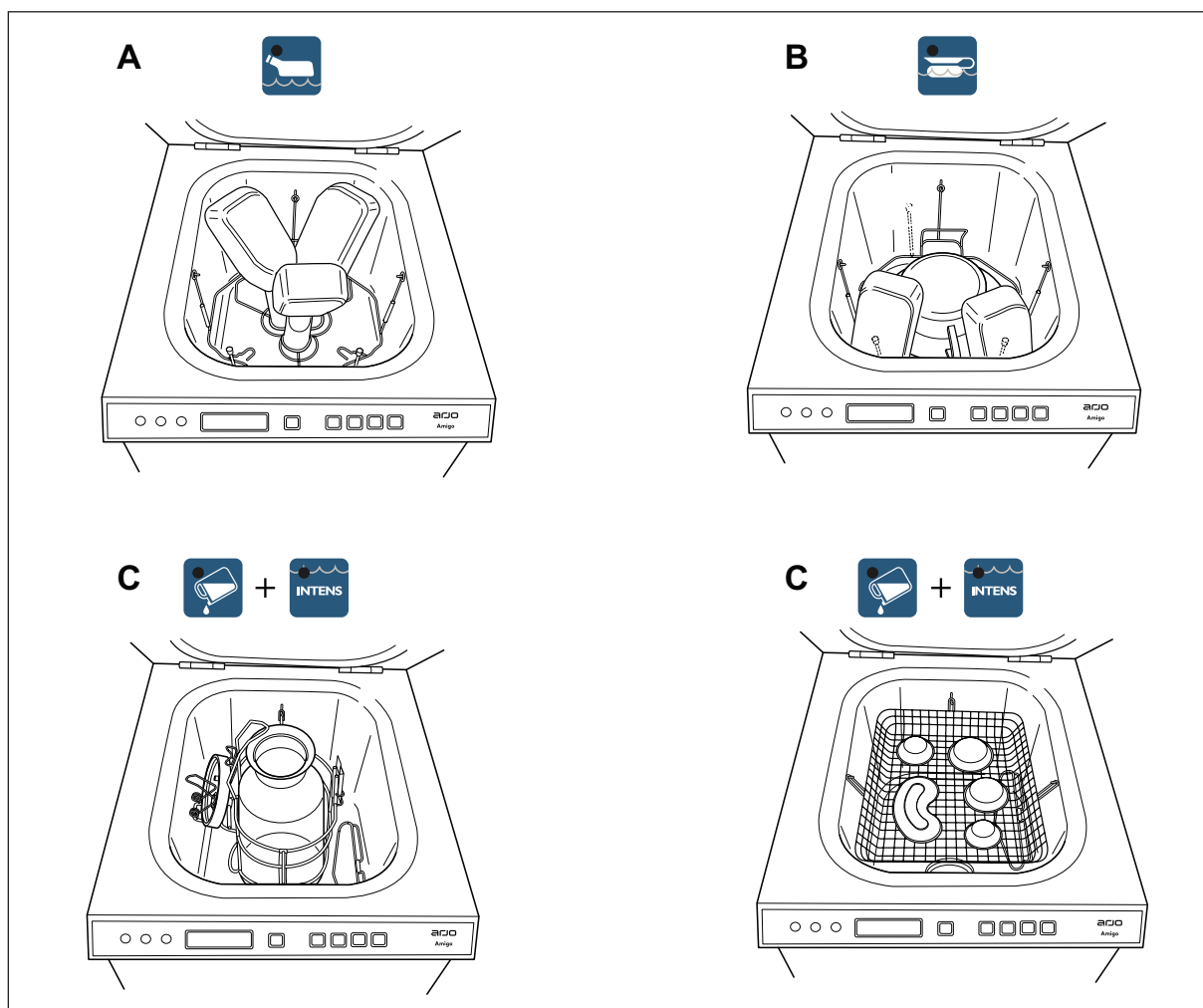

Figure 6. A. Economy program, B. Normal program and C. Intensive program

4.5 (S-608) Use pouch destroyer

4.5.1 About the pouch destroyer

The pouch destroyer is designed for the cleaning and disinfecting of bags filled with liquid.

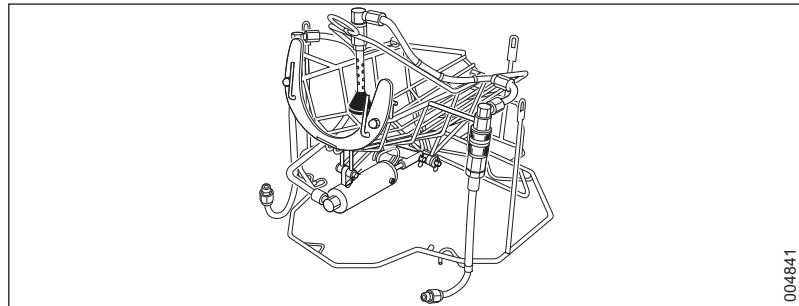

Figure 7. The pouch destroyer

If the liquid coagulates, the following applies:

- The function of the pouch destroyer cannot be guaranteed.
- The cleaning and disinfection results are dependent on the size of the coagulate and the material in the pouch.

4.5.2 Remove the upper part of the pouch insert



WARNING!
Risk of cutting injury.

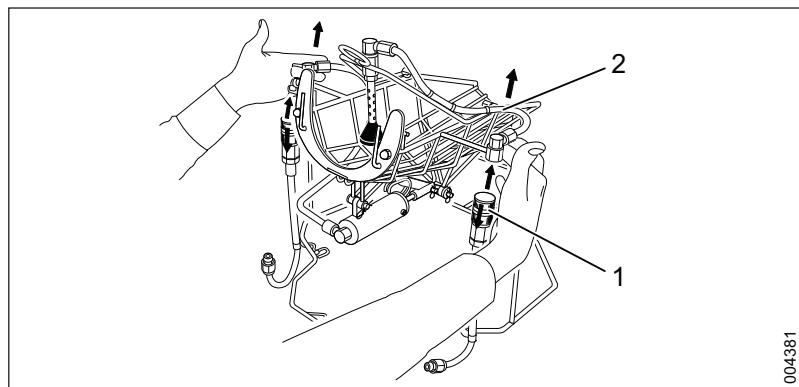

Figure 8. Removal of the pouch insert

To remove the upper part of the pouch insert:

1. Press the flange on the quick-release couplings (1) downwards.
2. Lift the upper part of the pouch insert (2) backwards and upwards.

4.5.3 Install the upper part of the pouch insert



WARNING!
If not correctly installed, the machine may not work properly.



WARNING!
Risk of cutting injury.

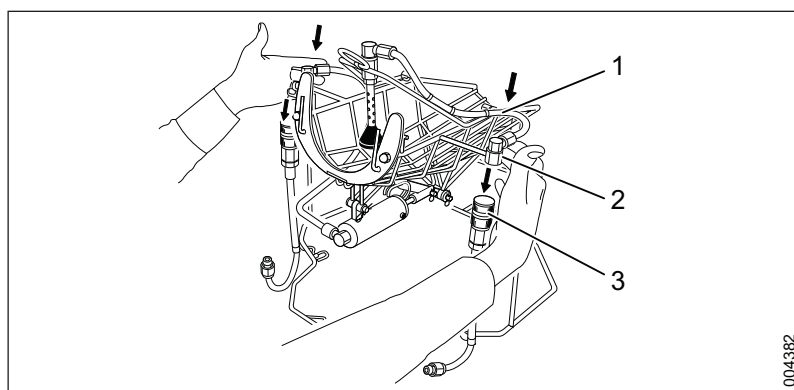

Figure 9. Installing pouch insert

Install the upper part of the pouch insert:

1. Lift the upper part of the pouch insert (1) downwards and upwards.
Take care to check that the front bar correctly meets the attachment on the front edge (2).
2. Align the couplings (3) and press them together.
A distinct “click” must be heard.

5 MAINTENANCE

5.1 Flushing chamber

Keep the flushing chamber free of limescale deposits. Remove any remaining deposits by spraying on an ordinary acid-based cleaner. There is no need to rinse it off. This happens automatically during the next program.

5.2 The outside

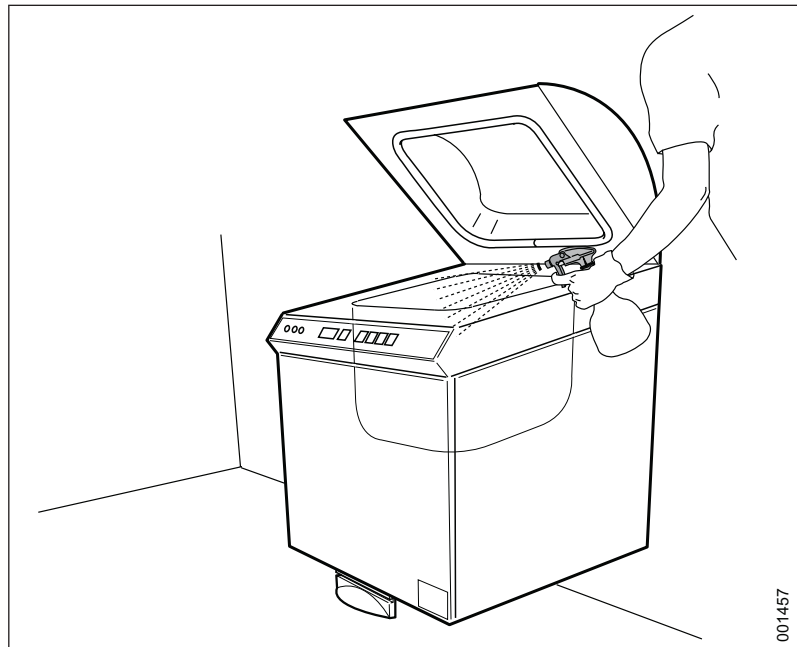

Figure 10. Cleaning the outside of the machine

Surface	Cleaning
Front and side walls	Clean and disinfect with an alcohol-based cleaner, medical spirit or ordinary detergent.
Control panel	Clean and disinfect with an alcohol-based cleaner, medical spirit or ordinary detergent.
Stains	Remove stains with an ordinary cleaner for stainless steel.
Steam generator	If the machine is used without automatic descaling, the steam generator must be checked regularly for limescale deposits.

5.3 (S-608) Pouch destroyer

5.3.1 Maintenance



WARNING!
If not correctly installed, the machine may not work properly.



WARNING!
Risk of cutting injury.

For information about removal and installation of the pouch destroyer, see (S-608) *Use pouch destroyer*.

Recommendations:

- Clean the insert regularly to maintain a good standard of hygiene.
- If heavily soiled, clean the insert mechanically by dismantling it or alternatively by removing and soaking it in a solution.
- Replace the blade as necessary.

Cleaning:

1. Spray the detergent over the insert.
Use an acid-based cleaner.
2. Allow the detergent to work for 5 minutes.
3. Run a process.

5.3.2 Replacing blade



WARNING!
If not correctly installed, the machine may not work properly.



WARNING!
Risk of cutting injury.

1. To remove the upper part of the pouch insert, press the flange on the quick-release couplings downwards! Lift out backward and upward.

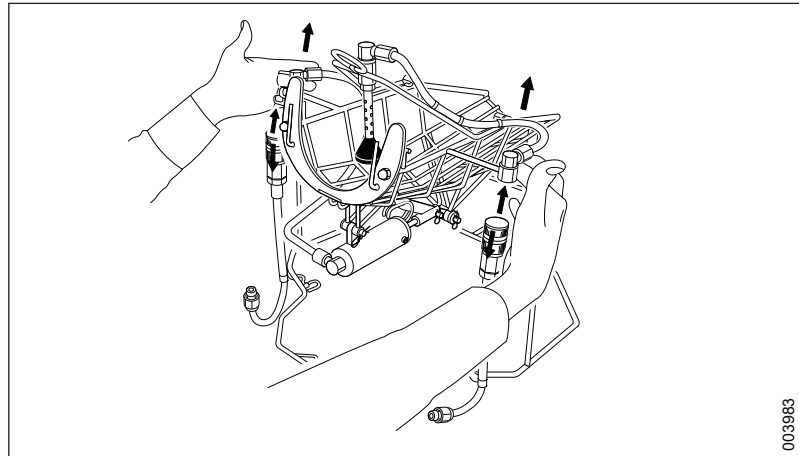

Figure 11. Removal of pouch insert

2. Pull out the locking pins for the blade.

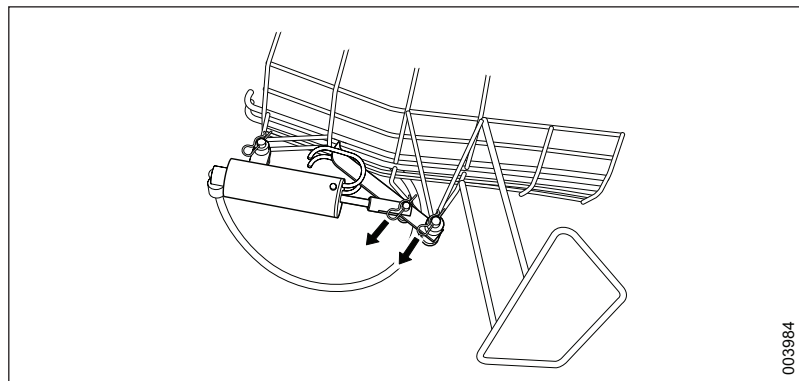

Figure 12. Locking pins

3. Remove the pins that secure the knife.

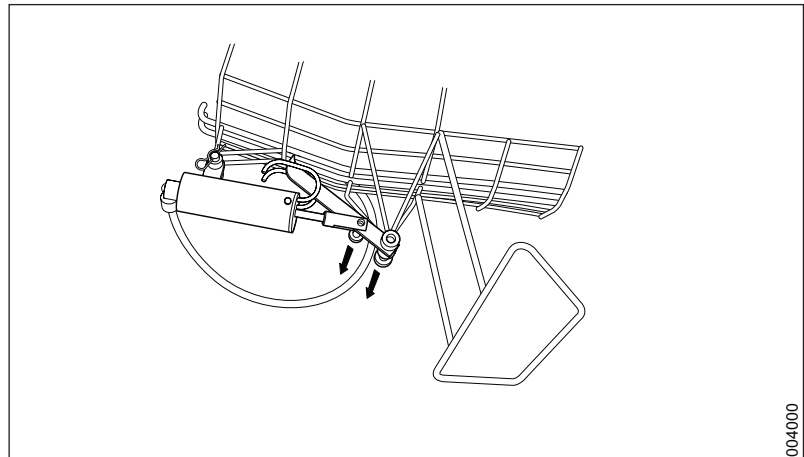

Figure 13. Removing pins

4. Grab the blade and carefully remove it from the bracket. Be careful of the loose nylon washers that are placed between the blade and the rotating bracket.

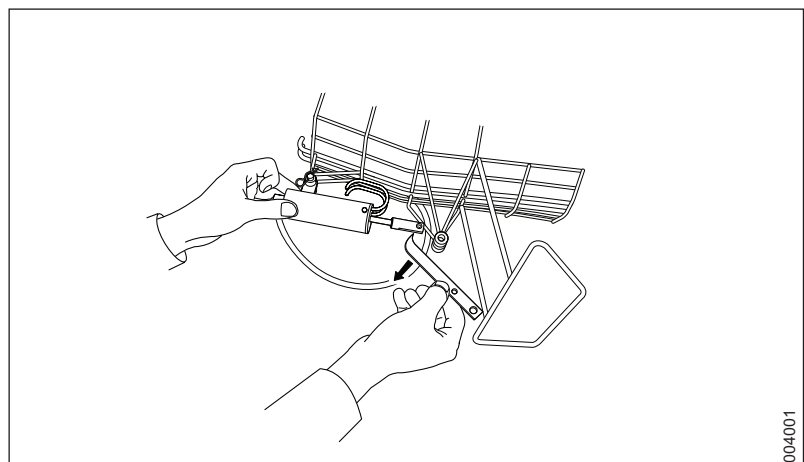

Figure 14. Removing blade

5. Install the new blade in the reverse order.

5.4 Preventive maintenance

For safety purposes, never modify equipment or use incompatible parts.

5.4.1 Periodic maintenance

Periodic maintenance and system testing must be performed to ensure safety and the machine's proper operation.

The amount of maintenance required depends largely on the quality of the incoming water and how often the machine is used. The maintenance interval will have to be determined in each individual case. Arjo recommends that the stated maintenance operations be performed at intervals according to the service table.

5.4.2 Service table



WARNING!

The machine is connected to the electricity supply and some components are live.



WARNING!

Maintenance may only be performed by authorized service technicians.

Note!

The service table is only shown for information purposes.

The service table below shows recommended maintenance intervals.

In addition to system testing, we recommend that appropriate cleaning tests and temperature validation are performed according to EN ISO 15883.

	Measure	Every year / 10,000 cycles	Every other year/20,000 cycles	Time* (minutes)
1	General			
1.1	Check the cabling and connection points.	•		10
1.2	Check that the panel decal is firmly affixed, is undamaged and legible.	•		2
1.3	Check that an goods placement sign and quick help instructions have been put up.	•		1
1.4	Check error codes and the number of processes.	•		2
2	The chamber			
2.1	Check that the rotating nozzles are moving freely. Clean as required.	•		20
2.2	Check that the fixed nozzles are not clogged with grime and deposits. Clean as required.	•		20
2.3	Check for leakage in the nozzle attachments and the hose connections to the chamber.		•	-
2.4	Check for proper operation of the temperature sensor.	•		10
2.5	Check that the door seal and chamber seal are tight. Clean or replace as necessary.	•		10
2.6	Check the mounting for the goods holder.	•		2
2.7	Check that the overflow drain connection to the chamber is tight.		•	-
2.8	Clean the inside of the flushing chamber.	•		10
3	Process tank			
3.1	Clean as required.	•		-

	Measure	Every year / 10,000 cycles	Every other year/20,000 cycles	Time* (minutes)
3.2	Check and clean the level sensor.	•		5
3.3	Check that the valves are working and that the connections are not leaking. Clean as required.	•		10
4	Steam Generators			
4.1	Check the connections to the steam generator for leakage and make sure the surrounding insulation is intact and no hot surfaces are exposed.	•		5
4.2	Check that the steam generator is working properly.	•		10
5	Main pump			
5.1	Check that the main pump is firmly attached and that there are no leaks in the connections.		•	5
6	Dosing system			
6.1	Check the hoses between the dosing pump and the detergent holder. Replace if necessary.	•		5-10
6.2	Check the dosage amount. Adjust if necessary.	•		10-30
6.3	Replace hose in the dosing pump.	•		5
6.4	Check that the empty container alarm works. Clean or replace as necessary.	•		5
6.5	Check the function of the check valve in the steam generator.	•		5
7	Drainage connection			
7.1	Check that the drain connection is firmly attached and that it is not leaking.	•		5
7.2	Check the condensation cooling nozzle head (option).	•		5
8	Steam inspection (Option)			
8.1	Check and adjust the needle valve.	•		10
9	Automatic door			
9.1	Check the automatic door for proper operation.	•		5
10	Function check (at each service)			
10.1	Run a complete process and be sure there are no deviations according to the periodic checkpoints.			
10.2	Check that the panel's lamps and alarms are functioning.			

* The time required is estimated with the front panel removed and may vary depending on the installation settings, operating conditions and equipment level.

5.5 Machines that are not in use

A machine that is not being used should be drained.
Contact a service technician.

6 ALARM

6.1 Alarm indication



WARNING!

If the disinfection process is cancelled, the goods are not clean. The goods must be processed again.

If the red lamp at  lights up, disinfection was aborted because of low temperature or some other error. The display shows a message stating the cause of the fault in plain text.

6.2 Acknowledging an error message





WARNING!

Only to be carried out by authorized staff.

Some error messages need to be acknowledged after the fault has been rectified before the machine can be returned to run mode.

Acknowledging an error message:

1. First press the  button, then the  button.
Keep both buttons pressed at the same time for 10 seconds.
2. The machine is now ready to operate:
 - Re-run the cancelled program if the goods are still in the machine.
 - If the error persists, call service personnel.

6.3 During a power failure

If the power fails during a process, the machine remains locked. When the power returns, the machine restarts the process automatically.

7 TROUBLESHOOTING

7.1 List of codes

Code	Description of error	Action
U1	Lime binding agent low	Top up lime binding agent
U3	Rinse-aid low level	Top up rinse-aid
U4	Process agent low level	Top up process agent
U5	Spray agent low level	Fill spray agent
U6	Inspection request	Contact authorized service personnel
U7	Warning of high temperature for goods	Let the goods cool down
U8	External communication	
H7	Battery error	Contact authorized service personnel
F1	Faulty temp sensor	Contact authorized service personnel
F2	Level sensor error, tank	Contact authorized service personnel
F3	Level sensor error, detergent	Contact authorized service personnel
F4	Door logic error	Contact authorized service personnel
F5	Logic error, machine configuration	Contact authorized service personnel
F6	Inspection request	Contact authorized service personnel
F7	Disinfection temperature not reached	Contact authorized service personnel
F8	Door open/unlocked during process	Contact authorized service personnel
F9	Settings error (E2 error)	Contact authorized service personnel
F10	Could not fill/empty tank	Contact authorized service personnel
F11	Leakage	Contact authorized service personnel
F14	Running time, lid	Contact authorized service personnel
F15	Running time, rotator	Contact authorized service personnel
F16	Logic error, rotator	Contact authorized service personnel
F18	Wrong machine type	Contact authorized service personnel

8 WATER QUALITY



WARNING!

It is the customer's responsibility to supply the washer-disinfector with water of the right quality.

The quality of the water used in all stages of cleaning is important for good cleaning results.

8.1 Requirements

The water used in each stage must be compatible with:

- The material that the machine is made of.
- The chemicals used in the process.
- Process requirements for the various stages of the process

8.2 Main factors

The main factors for good water quality are:

Hardness: High hardness will cause limescale deposits in the washer-disinfector, leading to poor cleaning results.

Ionic contaminants: A high concentration of ionic contaminants may cause corrosion and pitting on stainless steel. Heavy metals such as iron, manganese or copper cause instruments to tarnish.

Microbial contaminants: Goods to be washed are treated for microorganisms and their residual products, which may cause fever-like symptoms if they get into the human body. Use water that does not increase the biological load.

Sanitary chemicals: High concentrations of, and high exposure to, sanitary chemicals may cause corrosion and pitting on stainless steel.

8.3 Recommendation

- Arjo recommends that water used in the pre-rinsing, washing and final rinsing phases should be of drinking quality in accordance with the guidelines.
- Recommended water quality is drinking water with max 5°dH.
- Detailed information about acceptable water quality can be found in "Guidelines for Drinking Water Quality" published by WHO.

8.4 Local standard

Follow local standards if they are stricter than Arjo's recommendations. Especially when treated water is used for the final washing/disinfection phase.

Additional advice should also be obtained from the manufacturers of chemical and medical equipment.

8.5 Local standard, typical specification

A typical specification for treated water is:

pH	5.5 to 8
Conductivity	<30 $\mu\text{s.cm}^{-1}$
TDS	<40 mg/l
Maximum hardness	<50 mg/l
Chlorine	<10 mg/l
Heavy metals	<10 mg/l
Phosphates	<0.2 mg/l as P ₂ O ₅
Silicates	<0.2 mg/l as SiO ₂
Endotoxins	<0.25 EU/ml
Total number of micro-organisms	<100 per 100 ml

9 ENVIRONMENTAL PRODUCT DECLARATION

	600
Total weight kg / % by weight	85/ 100
Mechanical parts	
Stainless steel	45.5 / 53.5
Steel	1 / 1.1
Cast iron	13 / 15.3
Copper	4 / 4.7
Plastic	8 / 9.4
Rubber	2 / 2.4
Other mech. parts	4 / 4.7
Electrical / Electronics	
Wiring	1 / 1.2
Circuit boards	0.5 / 0.6
Other components	7 / 8.2

9.1 Comments

The “Other mech. parts” and “Other components” fractions comprise pumps, door motors, etc., which cannot be weighed or divided up in the same way as other fractions.

9.2 Distribution

The machines are packed on wooden pallets and clad with corrugated cardboard, or wrapped in plastic. Users must make sure that the packaging material is sorted and recycled.

9.3 Use

The flusher-disinfector affects the environment during its entire life cycle. Arjo considers that electricity and water consumption have the greatest environmental impact. Based on a service life of ten years and 7,000 processes per year, the machines consume about 1,400 kWh of electricity and about 140 cubic meters of water. About 35 liters of detergent is discharged into the sewer system, depending on the programs/doses used in the machine. To reduce the environmental impact the user may use green electric power.

10 END OF LIFE DISPOSAL



WARNING!















The product may be contaminated and has to be disinfected before recycling.



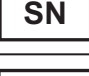

Equipment that has electrical and electronic components should be disassembled and recycled per Waste of Electrical and Electronic Equipment (WEEE) or in accordance with local or national regulation.

Disinfection liquids – if you have extra liquid, it's safe to pour it down the drain with running water. These products are water soluble and usually mixed with water when used for cleaning, your municipality will treat these cleaners the same way they would if you used them for cleaning.

The packaging containers should be recycled according to the national or local regulations.

11 SYMBOL EXPLANATION

Symbol	Explanation
	Warning
	Warning, hot surface
	Warning, sharp element
	Warning, dangerous voltage
	Wear protective gloves
	Wear eye protection
	Refer to instruction manual/booklet - Instructions for use should be read
	Name and address of the manufacturer
	Manufacturing date
	Use by date
	Catalogue number
	Serial number
	Indicates the product is a Medical Device according to EU Medical Device Regulation 2017/745
	Unique device identifier
	CE marking indicating conformity with European Community harmonized legislation Figures indicate Notified Body supervision
	IP = Ingress Protection, a rating value for the protection against mechanical ingress and water ingress

Symbol	Explanation
	WaterMark certification label with license number WMK26397
	Dutch safety certification for water safety
	Separate electrical and electronic components for recycling in accordance with the European Directive 2012/19/EU (WEEE)
	Recyclable, the number (2) indicates high-density polyethylene

UNITED KINGDOM	
	<p>UK marking indicating conformity with UK Medical Devices Regulations 2002 (SI 2002 No 618, as amended)</p> <p>Figures indicate UK Approved Body supervision.</p>
	<p>UK Responsible Person & UK Importer: Arjo (UK) Ltd, ArjoHuntleigh House, Houghton Regis. LU5 5XF</p> <p>For Northern Ireland (NI) CE marking will still apply until further amendment to applicable regulations.</p>

12 ELECTROMAGNETIC COMPATIBILITY

Intended environment: industrial electromagnetic environment

Guidance and manufacturer's declaration – electromagnetic emission		
Emmission test	Compliance	Guidance
RF emissions CISPR 11	Group 1	This equipment uses RF energy only for its internal functions. Therefore its RF emissions are very low and are not likely to cause any interference in nearby electronic equipment.
RF emissions CISPR 11	Class A	This equipment is suitable for use in all establishments, including domestic establishments and those directly connected to the public low voltage power supply network that supplies buildings used for domestic purposes.

Guidance and manufacturer's declaration – electromagnetic immunity		
Immunity test	IEC 60601-1-2 test level / performance criterion	Compliance level / performance criterion
Electrostatic discharge (ESD) IEC 61000-4-2	±4 kV contact discharge / B ±8 kV air discharge / B	±4 kV contact discharge / B ±8 kV air discharge / B
Conducted disturbances induced by RF fields IEC 61000-4-6	3 V in 0,15 MHz to 80 MHz / A	3 V in 0,15 MHz to 80 MHz / A
Radiated RF electromagnetic field IEC 61000-4-3	10 V/m (80 MHz to 1 GHz) / A 3 V/m (1,4 GHz to 2 GHz) / A 1 V/m (2 GHz to 2,7 GHz) / A	10 V/m (80 MHz to 1 GHz) / A 3 V/m (1,4 GHz to 2 GHz) / A 1 V/m (2 GHz to 2,7 GHz) / A
Electrical fast transient/burst IEC 61000-4-4	±2 kV AC port / B 5 kHz repetition frequency	±2 kV AC port / B 5 kHz repetition frequency
Power frequency Magnetic field IEC 61000-4-8	30 A/m 50 Hz or 60 Hz / A	30 A/m 50 Hz / A
Surge IEC 61000-4-5	±1 kV line-to-line / B ±2 kV line-to-ground / B	±1 kV line-to-line / B ±2 kV line-to-ground / B
Voltage dips, short interruptions and voltage variations on power supply input lines IEC 61000-4-11	0 % UT; 1 cycle / B 40% UtI 10/12 cycles* / C 70% during 25/30 cycles* / C 0% during 250/300 cycles* / C	0 % UT; 1 cycle / B 40% UtI 10/12 cycles* / C 70% during 25/30 cycles* / C 0% during 250/300 cycles* / C
*For example: "25/30 cycles" menas "25 cycles for 50 Hz test" or "30 cycles for 60 Hz test".		
Note: UT is the AC mains voltage prior to application of the test level.		

AUSTRALIA

Arjo Australia
Building B, Level 3
11 Talavera Road
Macquarie Park, NSW, 2113,
Australia
Phone: 1800 072 040

BELGIQUE / BELGIË

Arjo Belgium
Evenbroekveld 16
9420 Erpe-Mere
Phone: +32 (0) 53 60 73 80
Fax: +32 (0) 53 60 73 81
E-mail: info.belgium@arjo.com

BRASIL

Arjo Brasil Equipamentos Médicos Ltda
Rua Marina Ciufuli Zanfelice, 329 PB02
Galpão - Lapa
São Paulo – SP – Brasil
CEP: 05040-000
Phone: 55-11-3588-5088
E-mail: vendas.latam@arjo.com
E-mail: servicios.latam@arjo.com

CANADA

Arjo Canada Inc.
90 Matheson Boulevard West
Suite 350
CA-MISSISSAUGA, ON, L5R 3R3
Tel/Tél: +1 (905) 238-7880
Free: +1 (800) 665-4831
Fax: +1 (905) 238-7881
E-mail: info.canada@arjo.com

ČESKÁ REPUBLIKA

Arjo Czech Republic s.r.o.
Na Strži 1702/65
140 00 Praha
Czech Republic
Phone No: +420225092307
E-mail: info.cz@arjo.com

DANMARK

Arjo A/S
Vassingerødvej 52
DK-3540 LYNGE
Tel: +45 49 13 84 86
Fax: +45 49 13 84 87
E-mail: dk_kundeservice@arjo.com

DEUTSCHLAND

Arjo GmbH
Peter-Sander-Strasse 10
DE-55252 MAINZ-KASTEL
Tel: +49 (0) 6134 186 0
Fax: +49 (0) 6134 186 160
E-mail: info-de@arjo.com

ESPAÑA

ARJO IBERIA S.L.
Poligono Can Salvatella
c/ Cabanyes 1-7
08210 Barberà del Valles
Barcelona - Spain
Telefono 1: +34 900 921 850
Telefono 2: +34 931 315 999

FRANCE

Arjo SAS
2 Avenue Alcide de Gasperi
CS 70133
FR-59436 RONCQ CEDEX
Tél: +33 (0) 3 20 28 13 13
Fax: +33 (0) 3 20 28 13 14
E-mail: info.france@arjo.com

HONG KONG

Arjo Hong Kong Limited
Room 411-414, 4/F, Manhattan Centre,
8 Kwai Cheong Road, Kwai Chung, N.T.,
HONG KONG
Tel: +852 2960 7600
Fax: +852 2960 1711

ITALIA

Arjo Italia S.p.A.
Via Giacomo Peroni 400-402
IT-00131 ROMA
Tel: +39 (0) 6 87426211
Fax: +39 (0) 6 87426222
E-mail: Italy.promo@arjo.com

MIDDLE EAST

Arjo Middle East FZ-LLC
Office 908, 9th Floor,
HQ Building, North Tower,
Dubai Science Park,
Al Barsha South
P.O. Box 11488, Dubai,
United Arab Emirates
Direct +971 487 48053
Fax +971 487 48072
Email: Info.ME@arjo.com

NEDERLAND

Arjo Nederland BV
Biezenwei 21
4004 MB TIEL
Postbus 6116
4000 HC TIEL
Tel: +31 (0) 344 64 08 00
Fax: +31 (0) 344 64 08 85
E-mail: info.nl@arjo.com

NEW ZEALAND

Arjo Ltd
34 Vestey Drive
Mount Wellington
NZ-AUCKLAND 1060
Tel: +64 (0) 9 573 5344
Free Call: 0800 000 151
Fax: +64 (0) 9 573 5384
E-mail: nz.info@Arjo.com

NORGE

Arjo Norway AS
Olaf Helsets vei 5
N-0694 OSLO
Tel: +47 22 08 00 50
Faks: +47 22 08 00 51
E-mail: no.kundeservice@arjo.com

ÖSTERREICH

Arjo Austria GmbH
Lemböckgasse 49 / Stiege A / 4.OG
A-1230 Wien
Tel: +43 1 8 66 56
Fax: +43 1 866 56 7000

POLSKA

Arjo Polska Sp. z o.o.
ul. Ks Piotra Wawrzyniaka 2
PL-62-052 KOMORNIKI (Poznań)
Tel: +48 691 119 999
E-mail: arjo@arjo.com

PORTUGAL

Arjo em Portugal
MAQUET Portugal, Lda.
(Distribuidor Exclusivo)
Rua Poeta Bocage n.º 2 - 2G
PT-1600-233 Lisboa
Tel: +351 214 189 815
Fax: +351 214 177 413
E-mail: Portugal@arjo.com

SUISSE / SCHWEIZ

Arjo Switzerland AG
Fabrikstrasse 8
Postfach
CH-4614 HÄGENDORF
Tél/Tel: +41 (0) 61 337 97 77
Fax: +41 (0) 61 311 97 42

SUOMI

Arjo Scandinavia AB
Riihitontuntie 7 C
02200 Espoo
Finland
Puh: +358 9 6824 1260
E-mail: Asiakaspalvelu.finland@arjo.com

SVERIGE

Arjo International HQ
Hans Michelsensgatan 10
SE-211 20 MALMÖ
Tel: +46 (0) 10 494 7760
Fax: +46 (0) 10 494 7761
E-mail: kundservice@arjo.com

UNITED KINGDOM

Arjo UK and Ireland
Houghton Hall Park
Houghton Regis
UK-DUNSTABLE LU5 5XF
Tel: +44 (0) 1582 745 700
Fax: +44 (0) 1582 745 745
E-mail: sales.admin@arjo.com

USA

Arjo Inc.
2349 W Lake Street Suite 250
US-Addison, IL 60101
Tel: +1 (630) 307-2756
Free: +1 (800) 323-1245
Fax: +1 (630) 307 6195
E-mail: us.info@arjo.com

JAPAN

Arjo Japan K.K.
東京都港区虎ノ門三丁目7番8号
ランディック第2 虎ノ門ビル9階
Tel: +81 (0)3-6435-6401
Fax: +81 (0)3-6435-6402
E-mail: info.japan@arjo.com

At Arjo, we believe that empowering movement within healthcare environments is essential to quality care. Our products and solutions are designed to promote a safe and dignified experience through patient handling, medical beds, personal hygiene, disinfection, diagnostics, and the prevention of pressure injuries and venous thromboembolism. With over 6500 people worldwide and 65 years caring for patients and healthcare professionals, we are committed to driving healthier outcomes for people facing mobility challenges.



ArjoHuntleigh AB
Hans Michelsensgatan 10
211 20 Malmö, Sweden
www.arjo.com

arjo

CE
2797