

# Nimbus 4 & Nimbus Professional



## Run/Standby button

Press for Run mode; the indicator changes to green.

Press and hold 3 seconds for Standby; the indicator turns off.



## Static button

Press and hold 3 seconds to select Static mode. There is a tone and the indicator illuminates - the pump is in Static mode.

Press and hold the button 3 seconds to return to Dynamic mode (alternating pressure).



## Mute button

Press and hold 3 seconds to mute the audible alarm. The indicator is illuminated when the audible alarm is muted.



## Comfort Control

Firmer setting = turn clockwise

Softer setting = turn counterclockwise



## Alarm symbol

Illuminated, with audible alarm, during Low Pressure, High Pressure, Pump Fault or Power Fail.



## Wait indicator

Illuminated until the mattress is fully inflated (15 minutes).



## High Pressure indicator

Illuminated, with audible alarm, when the pump detects high pressure in the mattress.

Make sure the tubeset does not have kinks.



## Low Pressure indicator

Illuminated, with audible alarm, when the pump detects low pressure in the mattress.

Make sure the CPR control is closed, the tubeset is connected properly, and the mattress is set to Normal.



## Power (Fail) alarm indicator

Illuminated, with audible alarm, when a mains power failure is detected. The alarm continues until the mains power is resumed or the Run/Standby button is pressed to put the pump in Standby. If the power failure is prolonged, switch to Transport mode and disconnect the tubing.



## Pump Fault indicator

Illuminated when an internal pump malfunction is detected. Call the Service Engineer.



## Service indicator

Illuminated after a set number of running hours, indicating the pump is ready for service. The pump continues to function normally while the Service indicator is on.

## Mattress CPR and transport controls

### CPR Control

To be used in the event of a patient suffering cardiac arrest and CPR needs to be administered. Rapidly exhausts air from the mattress.

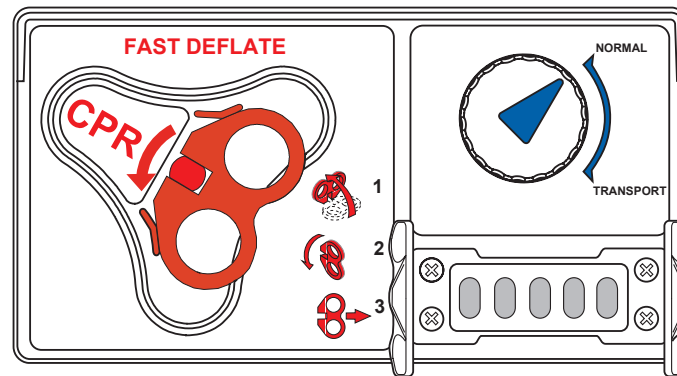

### Transport Control

Turn clockwise for Transport mode. The mattress is sealed and the support surface is equally pressurised; the pump and/or tubeset can be removed. Supports the patient up to 12 hours.

## Vent valves control

- For permanent pressure relief: deflate no more than one cell directly under the area needing relief.
- For temporary nursing procedures only: deflate one or more adjacent cells, reinflate once nursing procedure is done.  
Deflating more than one adjacent cell may affect the support of the patient in normal alternating cycle.
- For complex patient needs, off-load more than one area for longer periods:
  - Deflate only one cell in the torso section.
  - Deflate only one cell in the calf or heel section.
  - Deflate only one cell in the head section in the supine position (face up), or all three cells in the head section in the prone position (face down).

Deflating more cells in each area may affect the support of the patient in normal alternating cycle

### Nimbus 4

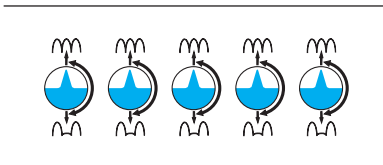

Vent valves at Heelguard cells

### Nimbus Professional

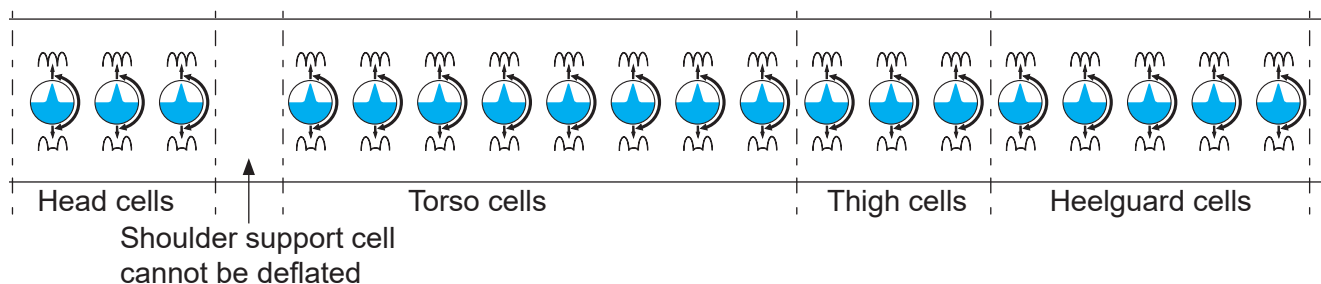

Closed



Open



To deflate a cell; turn the Vent Valve clockwise, to point downwards.

